

Creating a new hospital typology – together with the users



Children's Hospital Copenhagen at European Healthcare Design Conference 2018

Bent Ottesen (Medical Chief), Elisabeth Ginsberg (Innovation Consultant), Stig Vesterager Gothelf (Architect, 3XN)
<https://www.rigshospitalet.dk/boerneriget/english/Sider/default.aspx>

BørneRiget

4 year old girl 2 weeks
after a liver transplant

*The reason why
we are here!*



Our hospital is over 250 years old. Today, we are Denmark's leading hospital for patients needing highly specialized treatment and care

Rigshospitalet The University Hospital of Copenhagen



1757



1910



Today

However, children and young people are spread out over the hospital, making it more difficult to provide child- and family-centred care



Burn victims
Liver patients
Kidney patients

Cancer patients
Heart patients
Orthopedic patients

Intensive Neuro
Intensive Heart
Intensive ABD







Our vision

We want to give our patients the best treatment in the world

We want to create more scientific breakthroughs

We will contribute to the entire healthcare sector – also internationally

Future clinical paradigm

Staff comes to the patient, not vice versa

- One hospital for all children and adolescents (0-18 years)
- One surgical ward, across medical specialties
- One PICU, across medical specialties
- Gathering of all activities related to pregnancy and childbirth
- Integration of treatment, research and education

Our vision

We want to give our patients the best treatment in the world

We want to create more scientific breakthroughs

We will contribute to the entire healthcare sector – also internationally

Future clinical paradigm

Staff comes to the patient, not vice versa

- One hospital for all children and adolescents (0-18 years)
- One surgical ward, across medical specialties
- One PICU, across medical specialties
- Gathering of all activities related to pregnancy and childbirth
- Integration of treatment, research and education

Future user experience

5 design principles

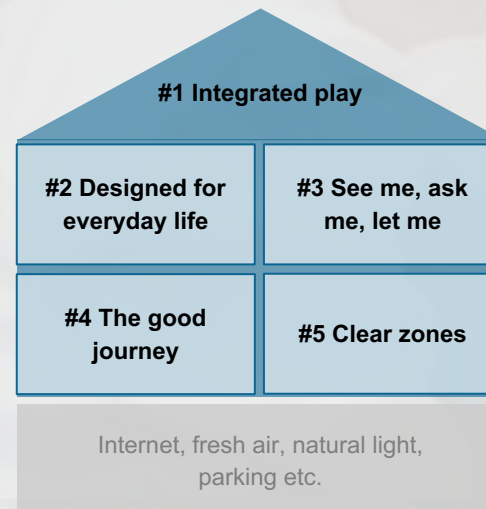

The users – patients, relatives, staff – have played a central role in forming our vision *Example: Ethnographic deep dive with users pre-program*



Interviews and observation at the hospital



At-home interviews with families

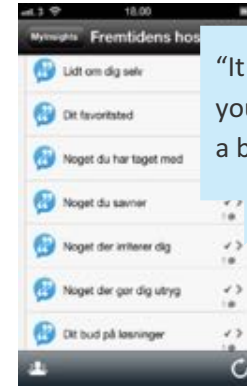

"It would be great if you could also borrow a bike ..."

Mobile self-reporting (text, photos, video)



Discussion and ideation sessions



Participatory observation and play



'Own body' experiences

Outcome: Five design principles for the future user experience, collected in a booklet with examples of design solutions

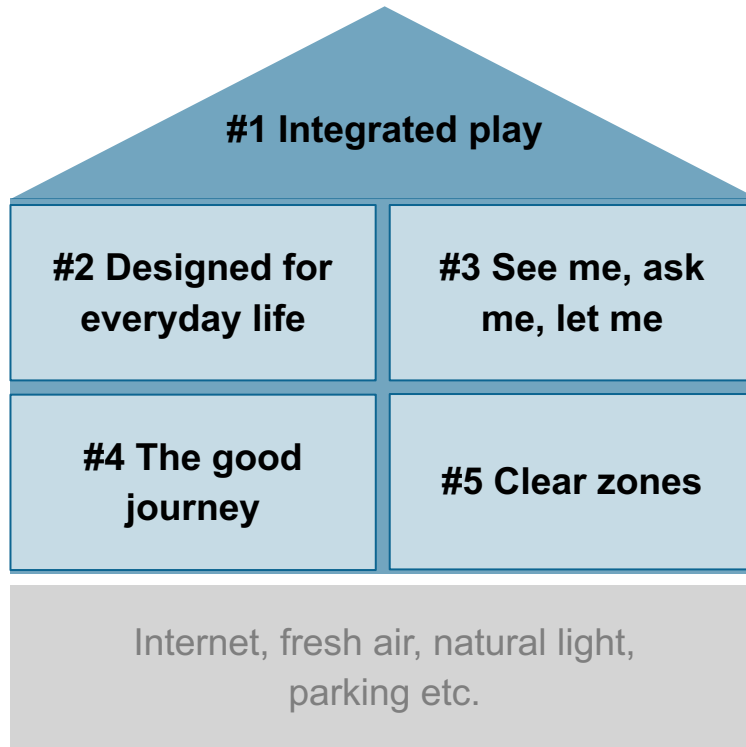

The booklet presenting the design principles became part of the competition material, along with the building program



The booklet can be downloaded from our website, in both Danish and English:
https://www.rigshospitalet.dk/boerneriget/english/competition%20material/Documents/designprinciples_uk.pdf

#1 Integrated play

Principle: Make play an integrated part of the design, life and flow of the building

Reason: We believe play can help promote healing and help the families better get through their experiences at the hospital



“Bows and ballerina skirts – even on the operating table. She is the hospital princess.” Mother of 4-year old

Our ambition is to integrate play in 3 different domains at Children's Hospital Copenhagen

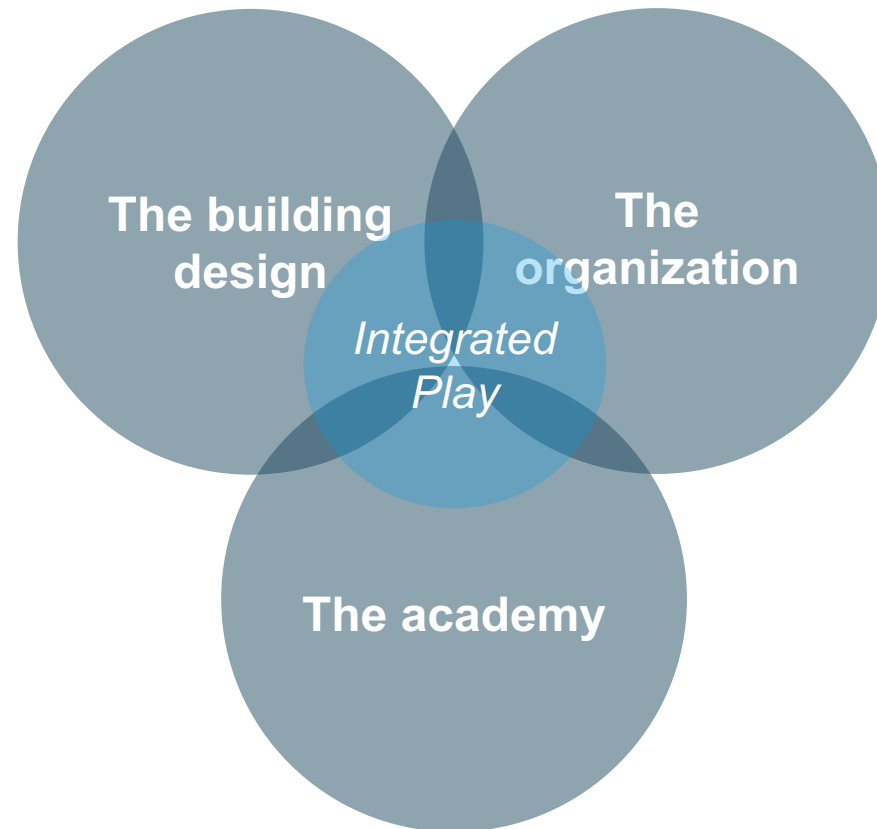

The building design is already on a structural level 'playfully logical', rethinking the traditional hospital typology



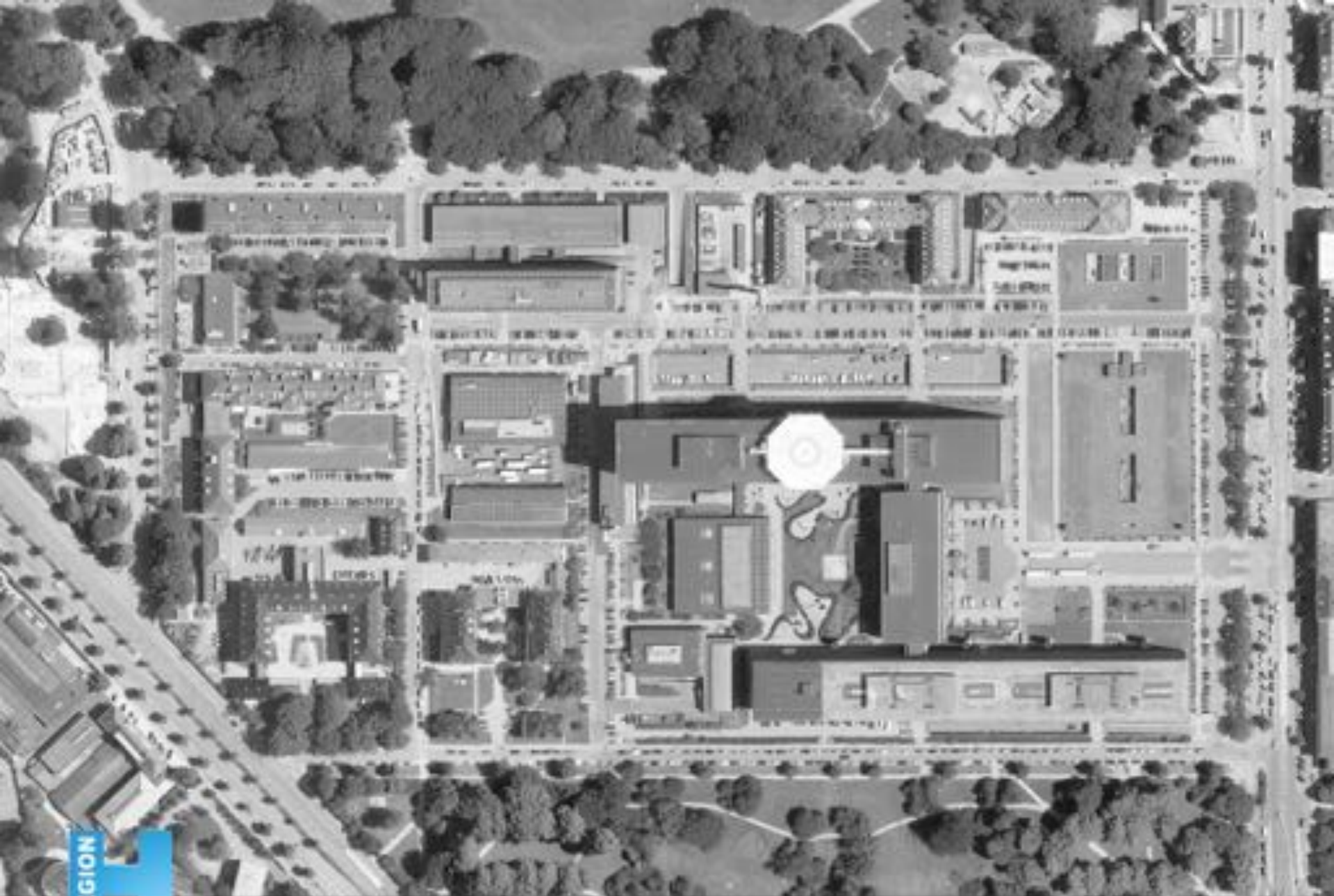

REGION

OLE KIRK's Fond

3X11 ARKITEMA NIRAS Kristine Jessens tegnestue ROSAN BOSCH

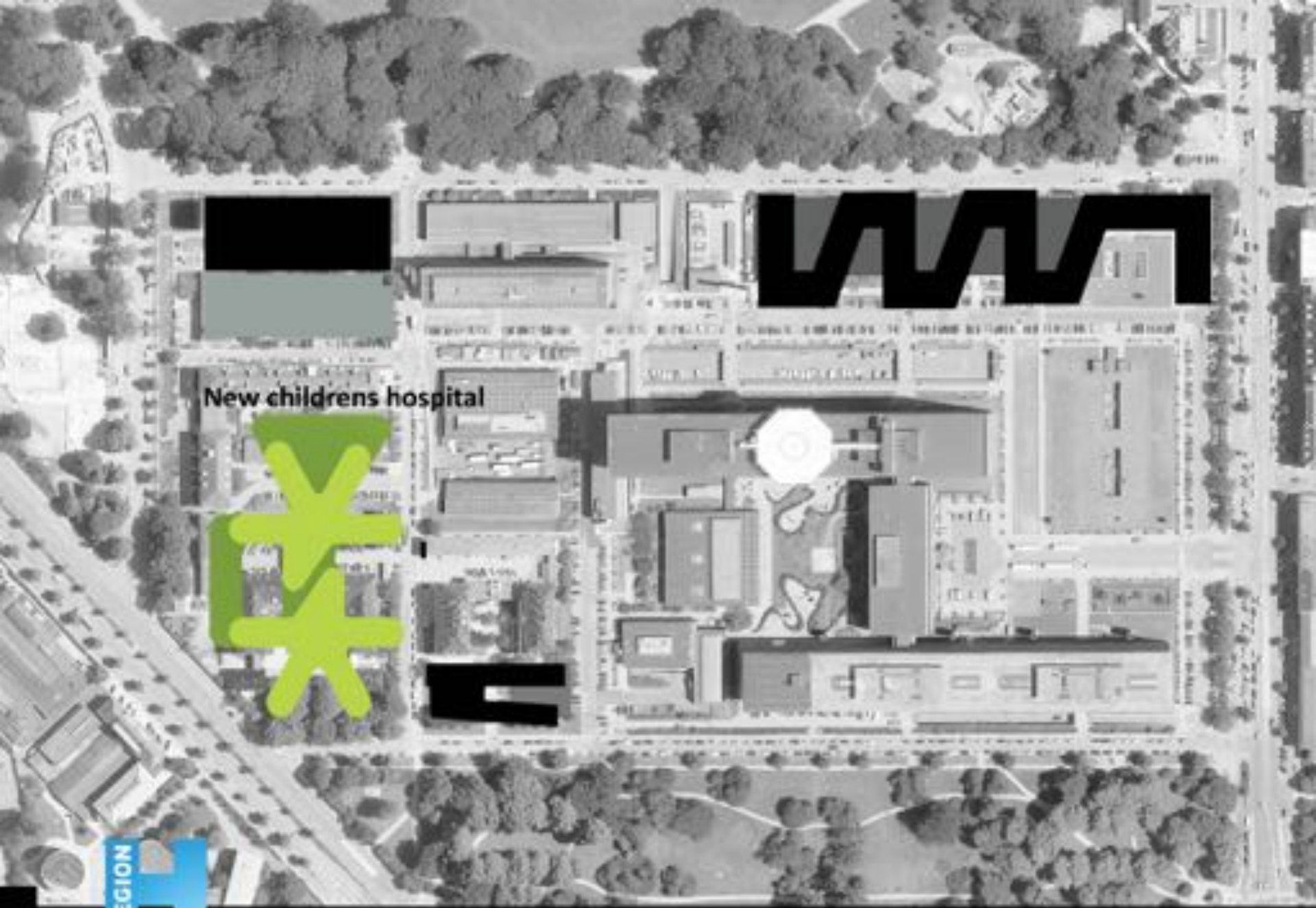

New childrens hospital

REGION

OLE KIRK's Fond

3001 ARKITEMA NIRAS Kristine Jørgensen tegnestue ROSANBOS

BørneRiget

58.000 m²



Northwing

54.000 m²

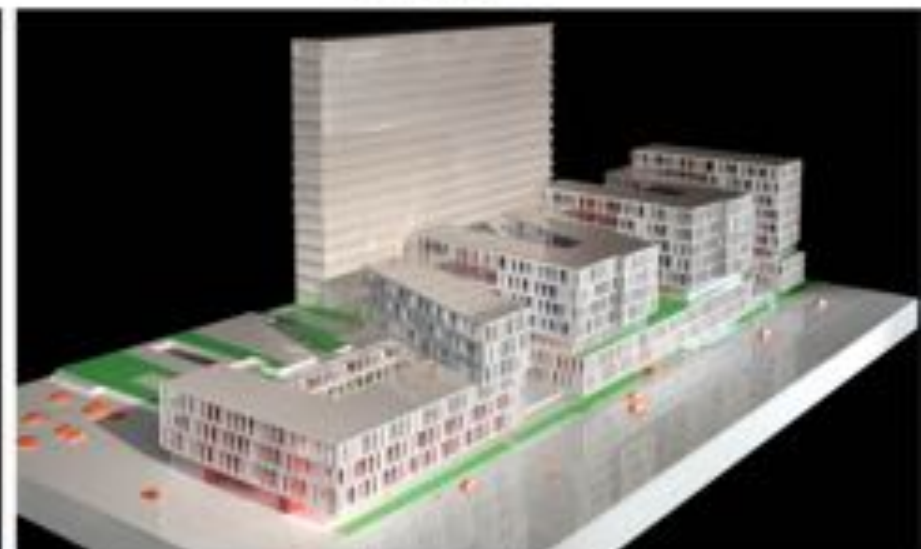

Efficient and functional layout + identity and narrative =

Playfully and logical approach



OLE KIRK's Fond

3001 ARKITEMA **NIRAS** Kristine Jensens tegnestue ROSAN BOSCH



BørneRiget - Playfully logical



OLE KIRK's Fond

3001 ARKITEMA **NIRAS** Kristine Jensens tegnestue ROSAN BOSCH

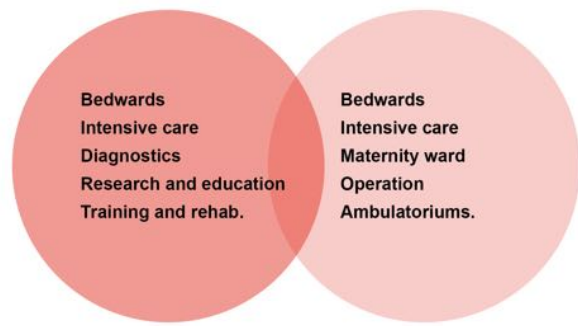

Two sides



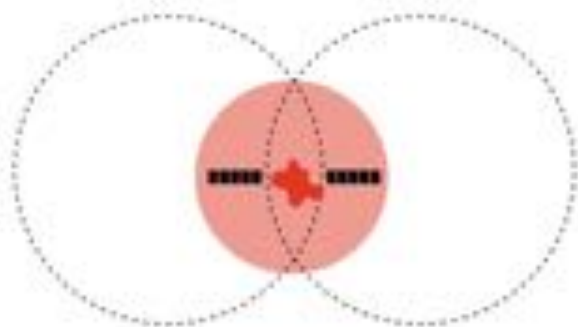

Connected central foyer and family zones

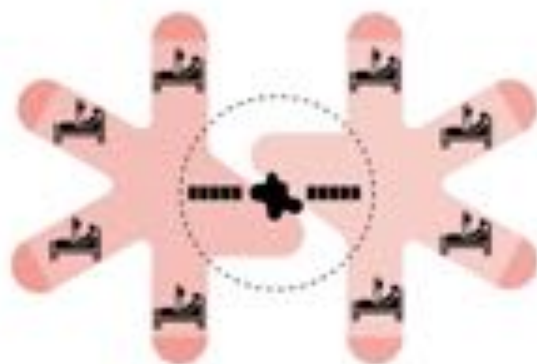

Bedwards in fingers



OLE KIRK's Fond

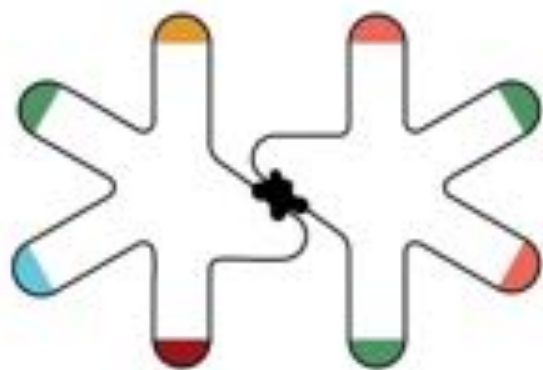

Terrasses and wintergardens in fingertips

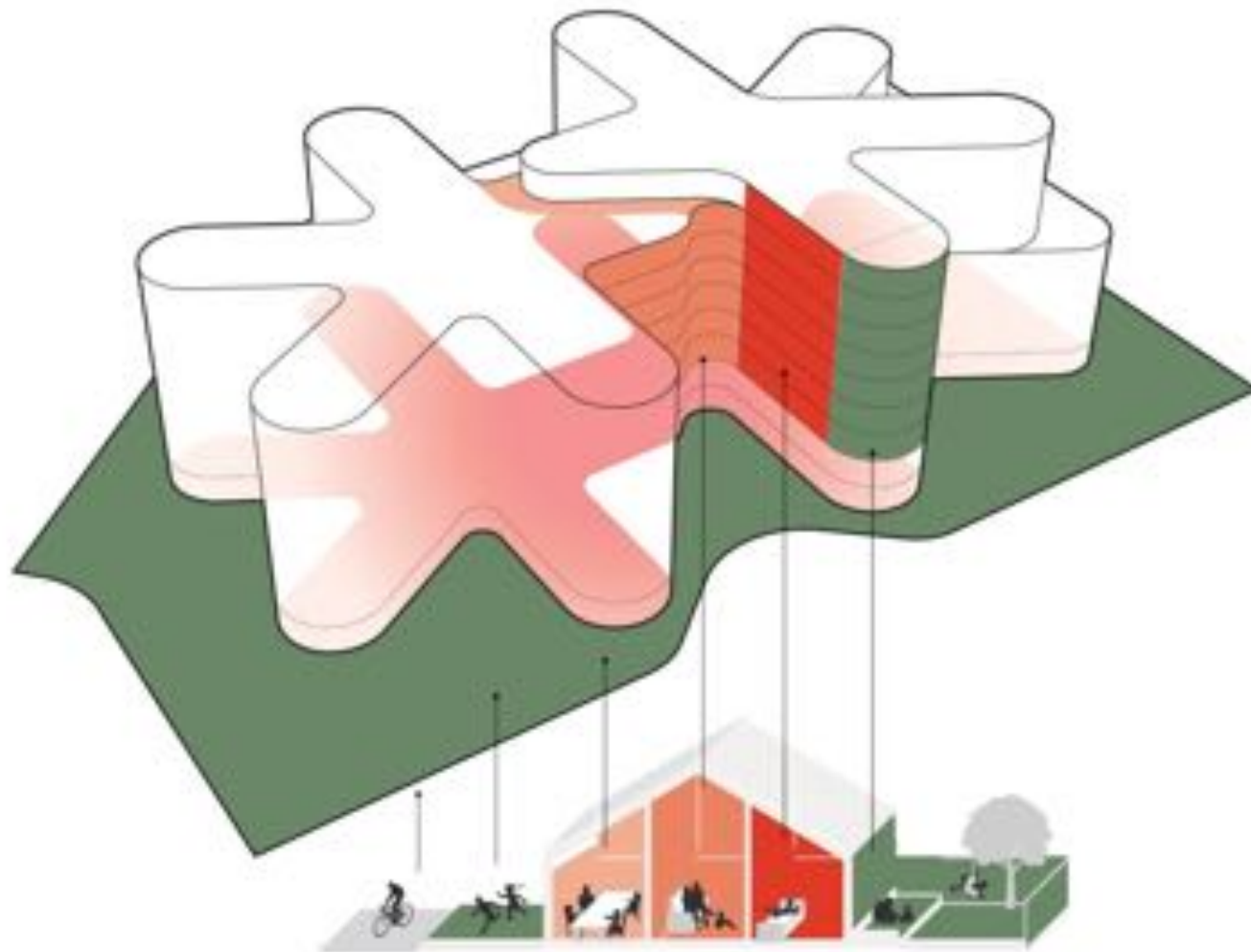

The street Front garden Hall Living room The personal space Terrasse Back-garden

Designed as a home



OLE KIRK's Fond



Central family area and calm fingers with bedwards

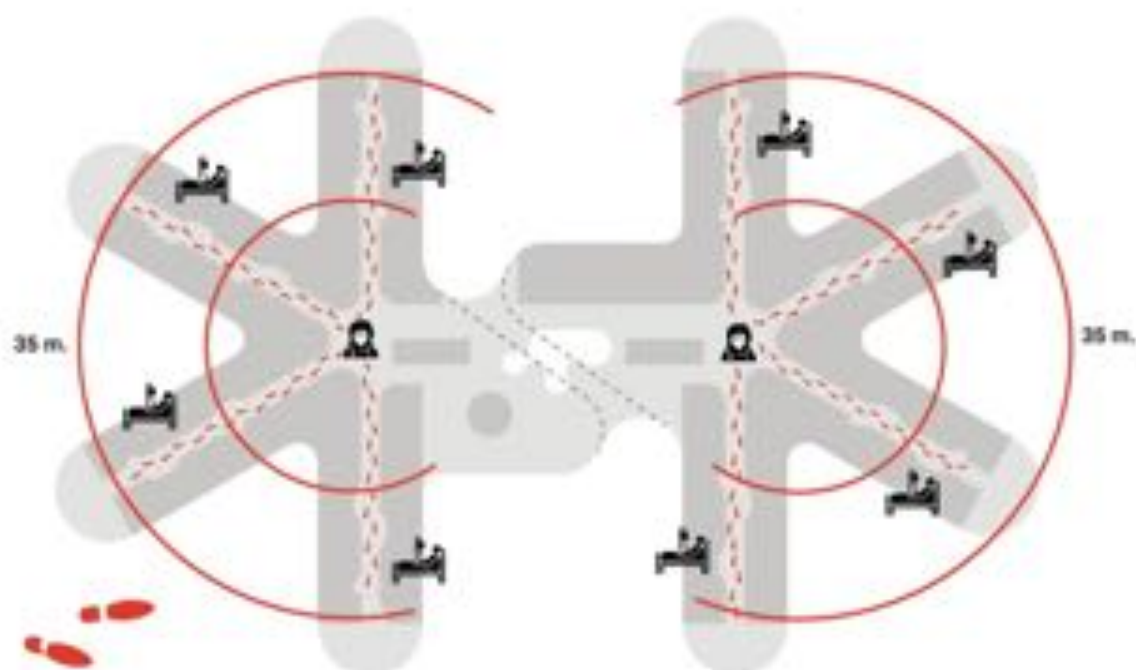

Equal close connections

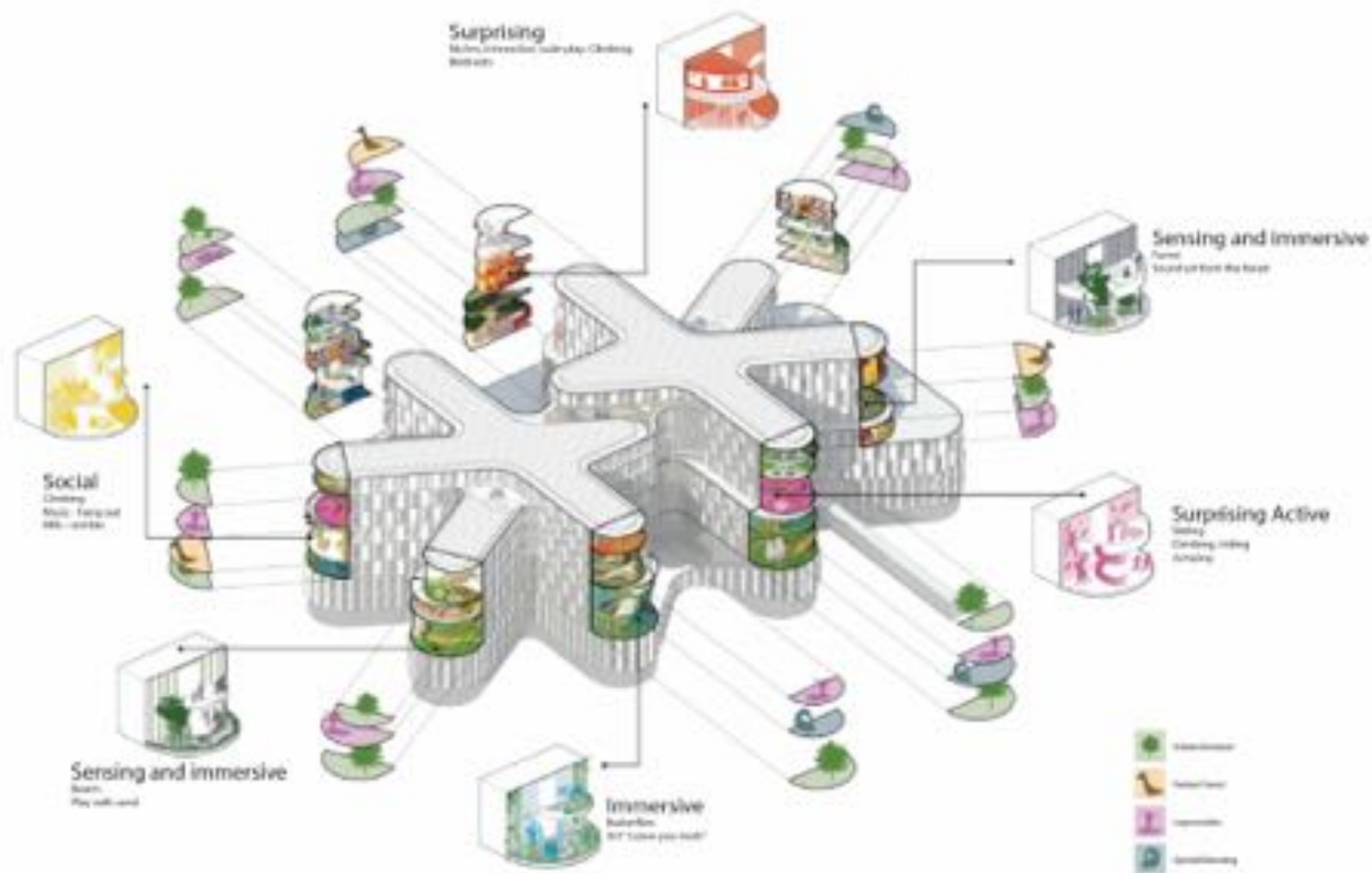

Playful fingertips



Playful fingertips



OLE KIRK's Fond

3001 ARKITEMA **NIRAS** Kristine Jensens tegnestue ROSANBOSCH



OLE KIRK's Fond

3001 ARKITEMA **NIRAS** Kristine Jensens tegnestue ROSANBOSCH