

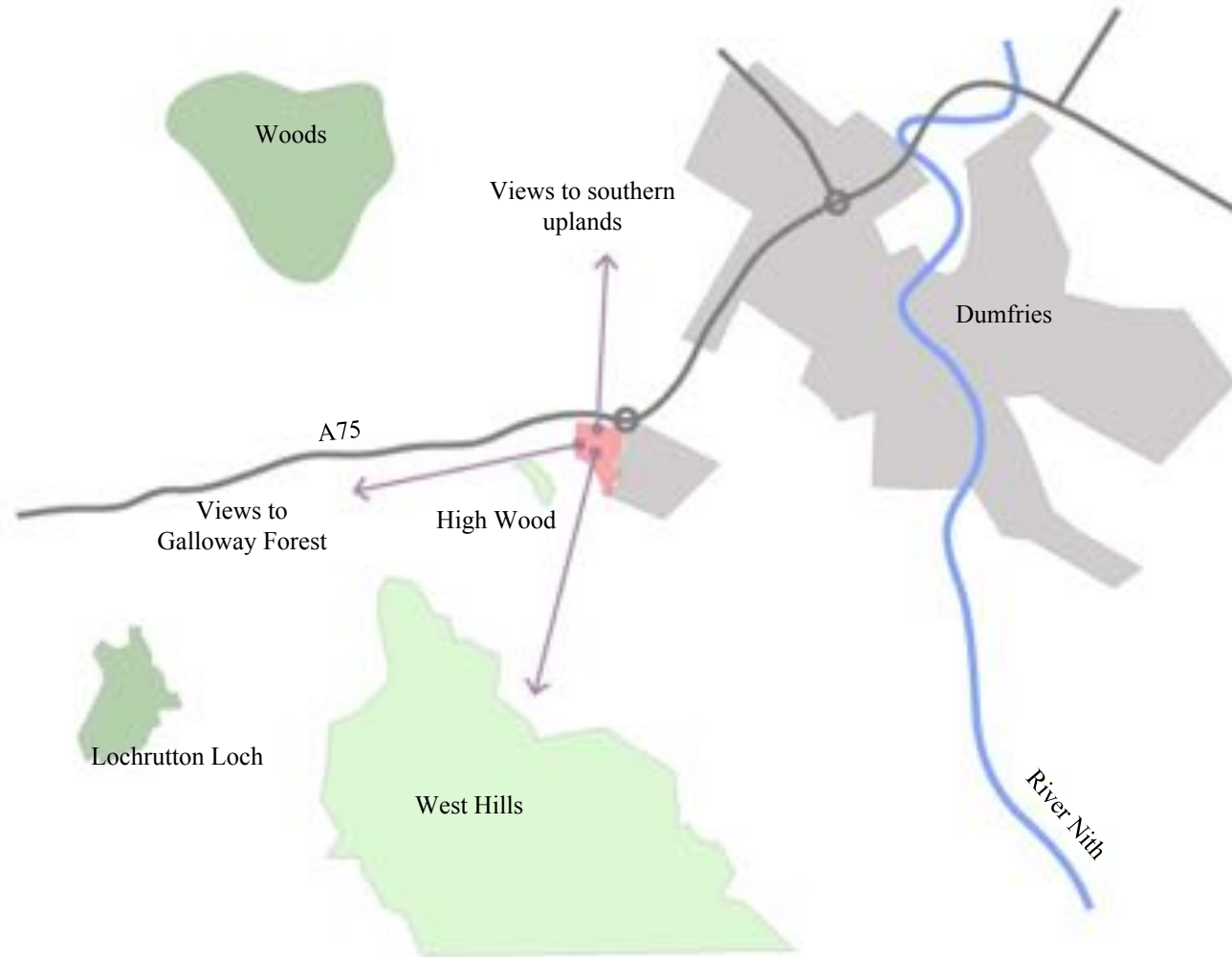

The Site



The Site



Understanding the Vision

Effectiveness and Sustainability

- Services which are clinically effective and sustainable

Capacity and Demand

- For inpatient, day case and outpatient services

Performance and Efficiency

- Maximise performance and improve efficiency

Physical Environment

- High quality environment fit for purpose for patients, staff and visitors

Models of Care

- Focussed patient services in a primary and community setting

Recruitment and retention

- Recruit and retain highly skilled staff and support high quality patient care

Person Centred – Uplifting and therapeutic environments, attractive, views to nature, natural light

Efficient Operation – Workflow analysis, space utilisation, clear wayfinding, IT innovation, flexibility

Safe – Control of infection, standardisation, FM tools, 6D BIM, welcoming, accessible

Effective Care - Strategic context, new models of care, engagement, soft landings, POE

Design Sprint
October 2013

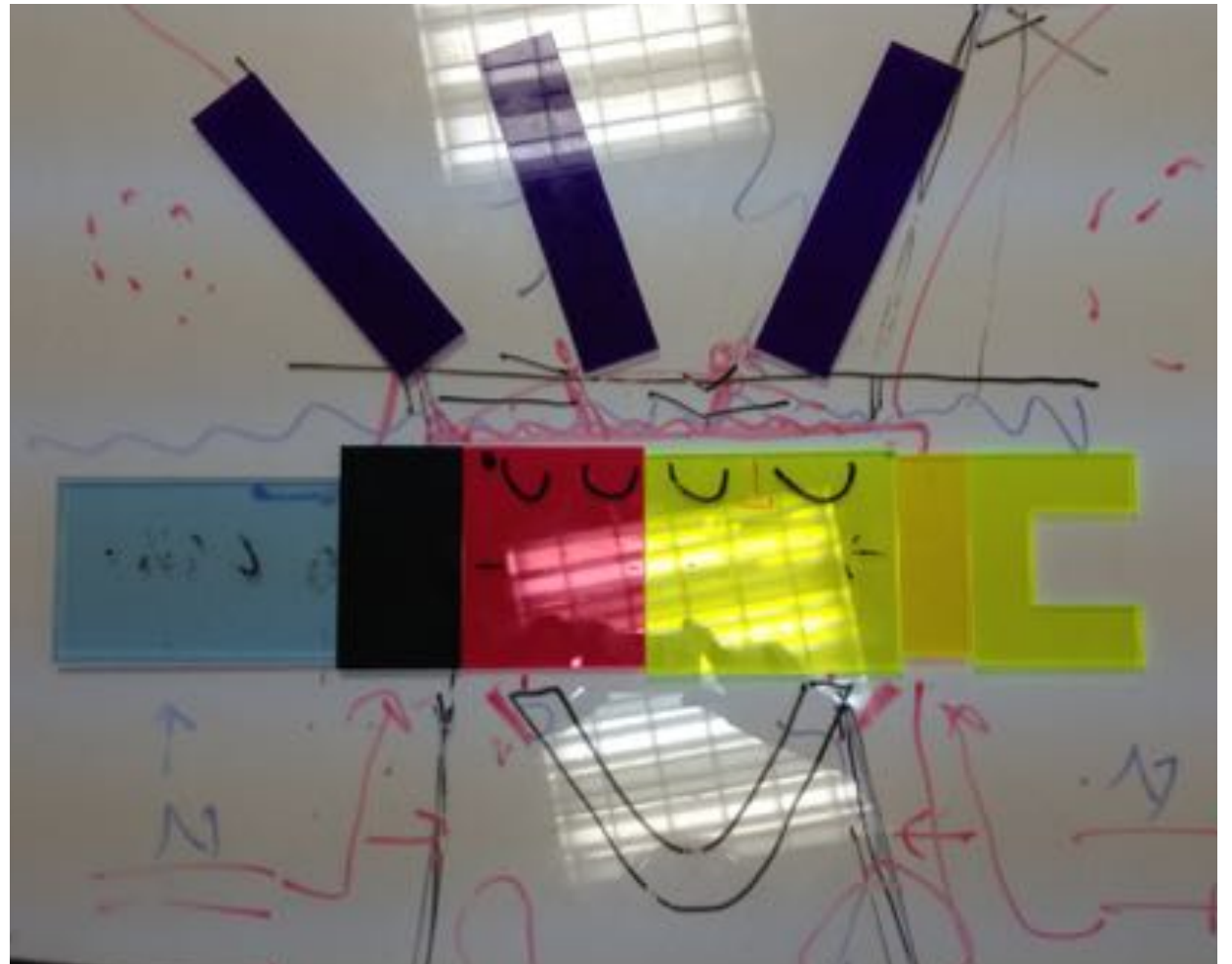

Creating a Woodland Campus

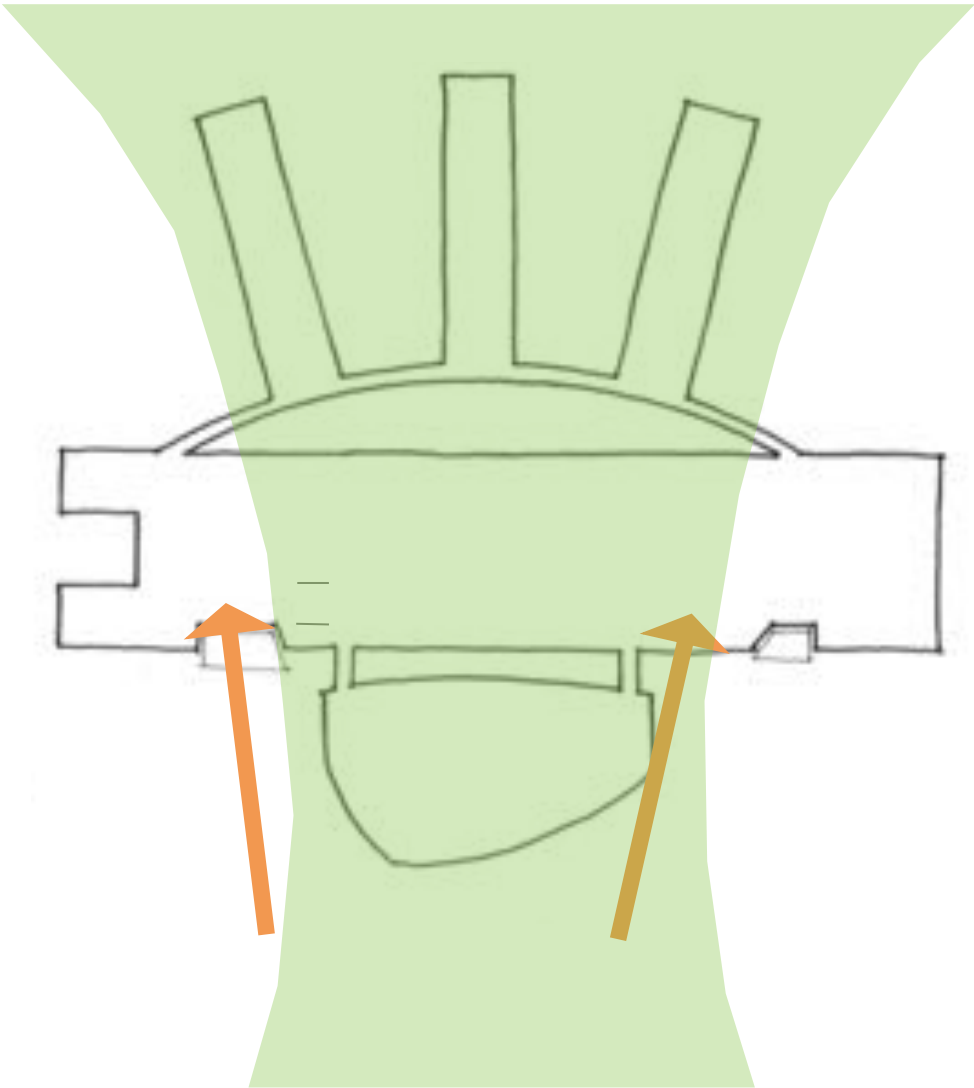

Creating a human scale

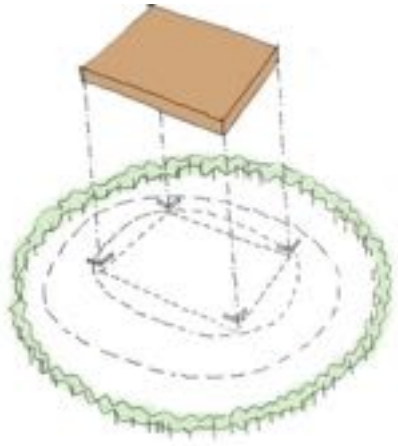

1.0 Set the stone mass of the hospital on top of the hill, surrounded by protective landscape.

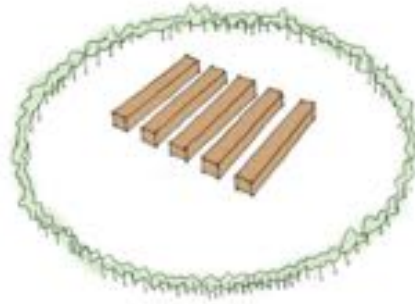

2.0 Break mass down to a human scale and into critical components.

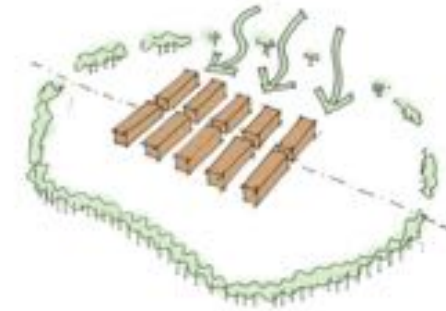

3.0 Landscape separates to allow wider connection to the rural landscape.

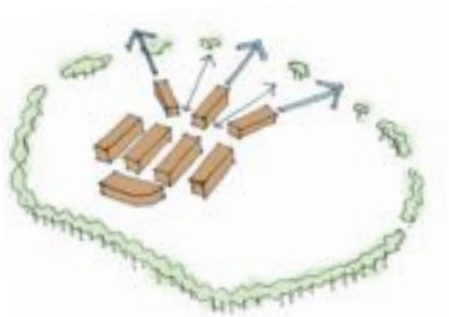

4.0 The spreading of the component facilities allows views out and landscape into the heart of the building.

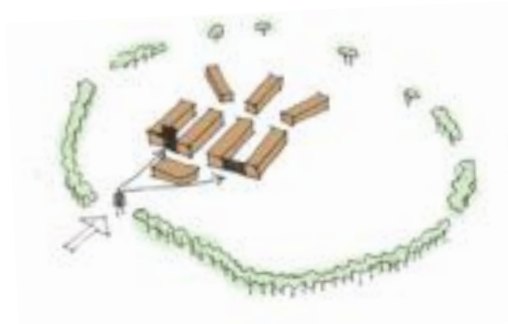

5.0 Direct view of main entrance and A&E upon entrance to the site for clear orientation.



6.0 Contrasting treatments of hard and soft spaces with pavilion in park approach.

Clarity of wayfinding

Main Entrance

CAU and Emergency

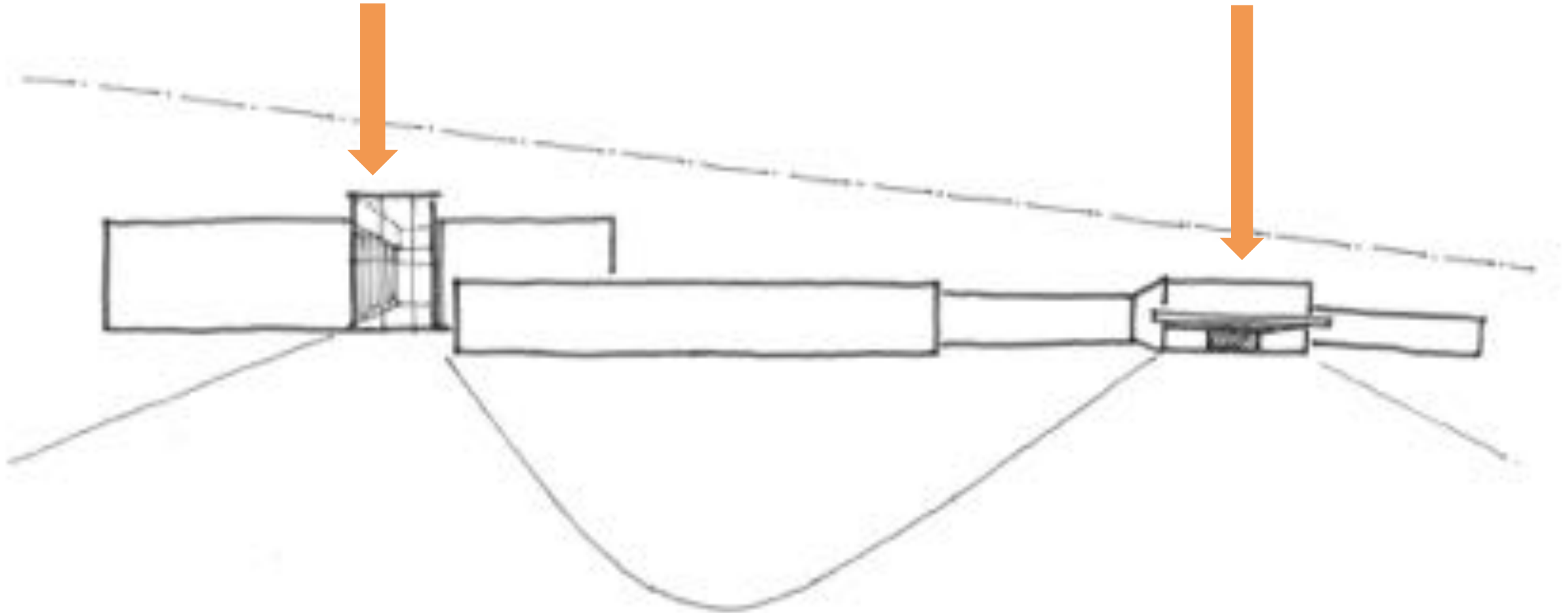

Clarity of wayfinding



Developing the language

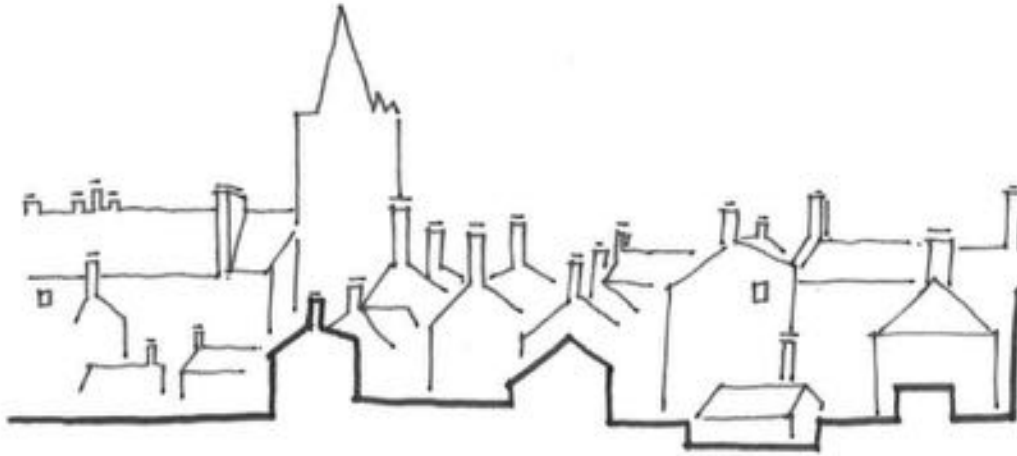

Developing the language

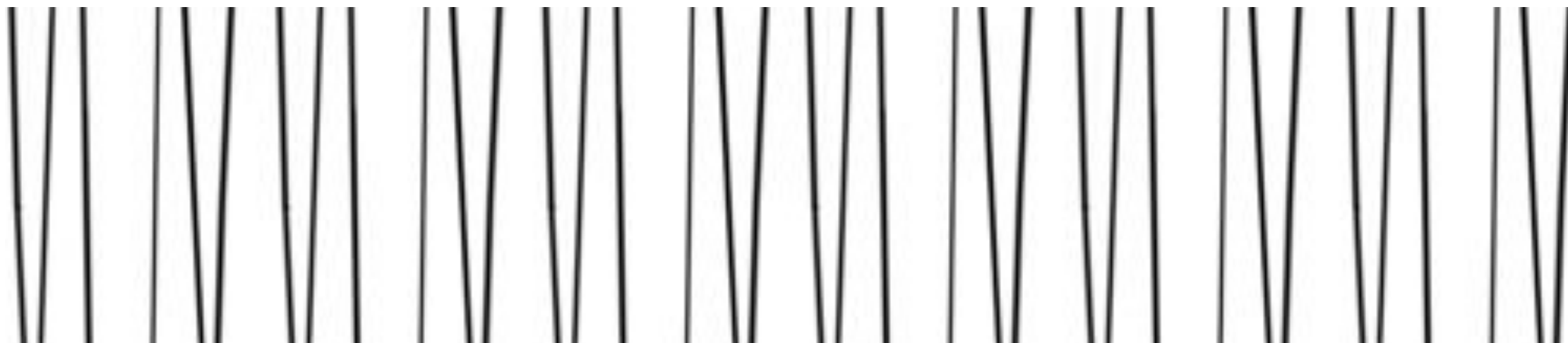
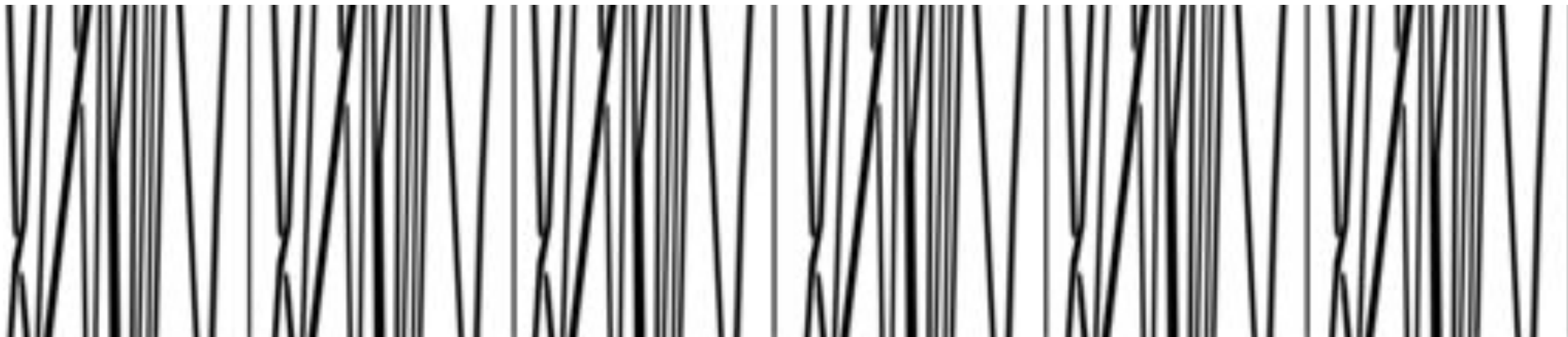

Developing the language

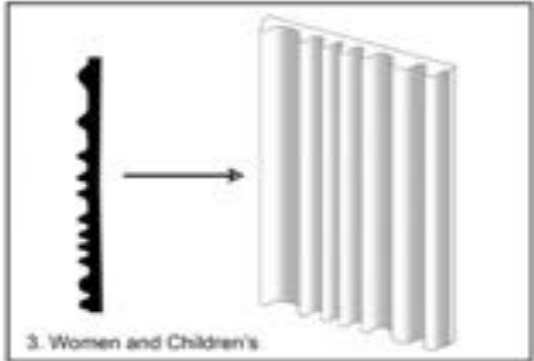
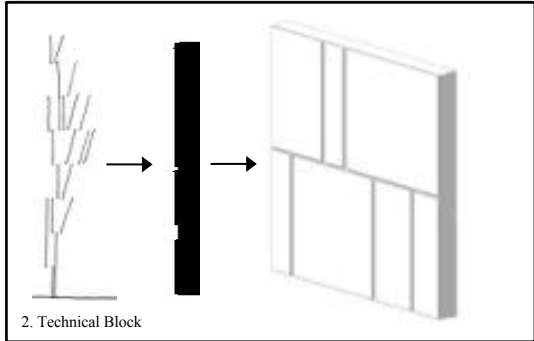
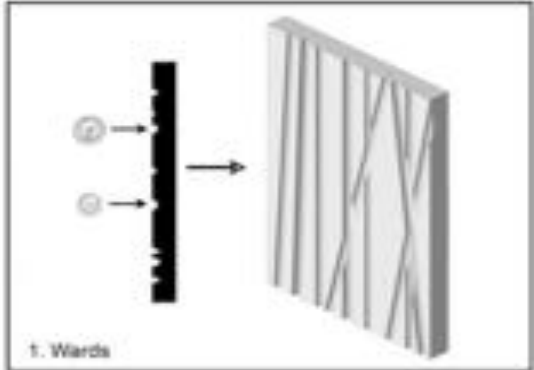
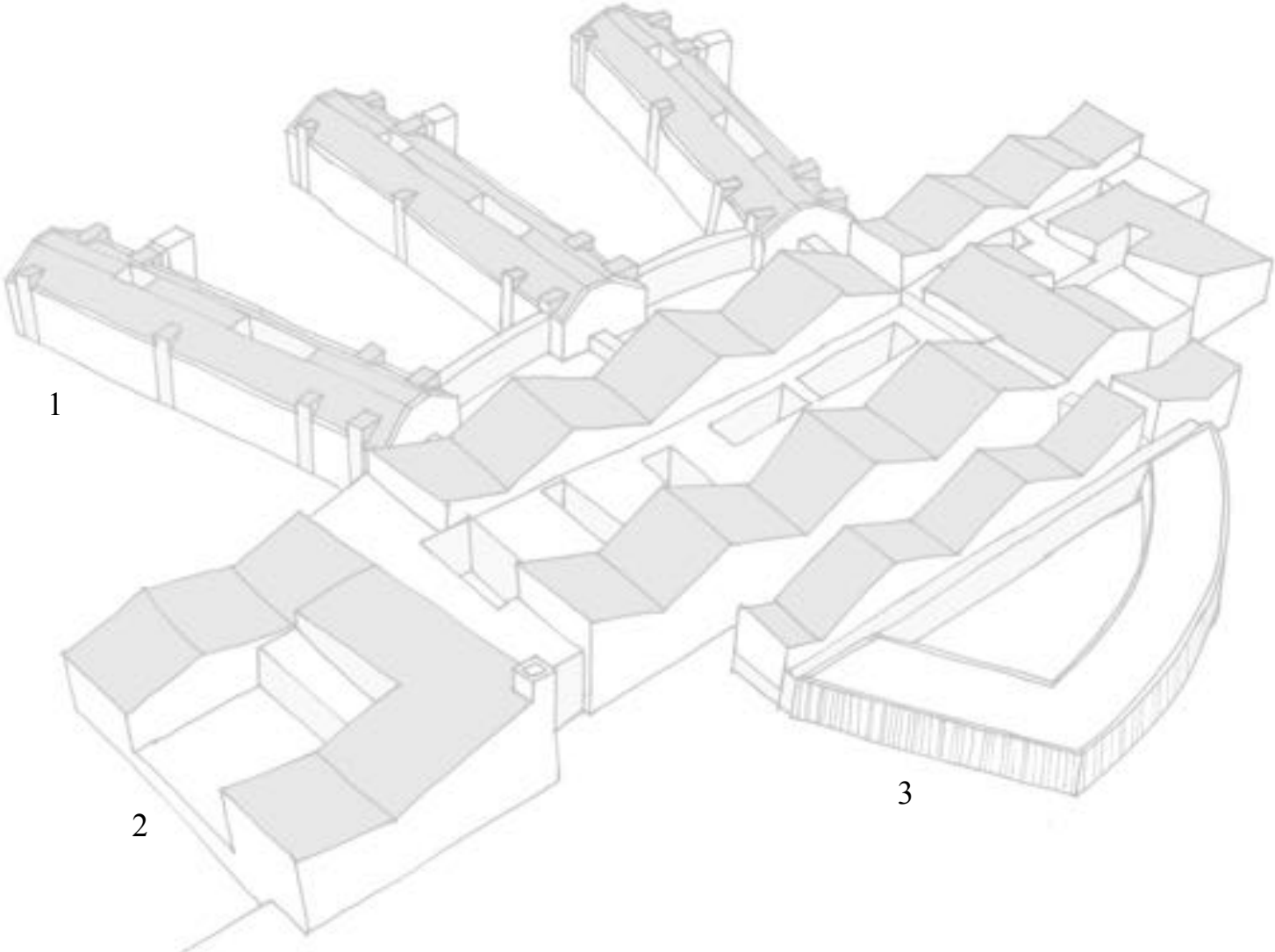

Developing materiality

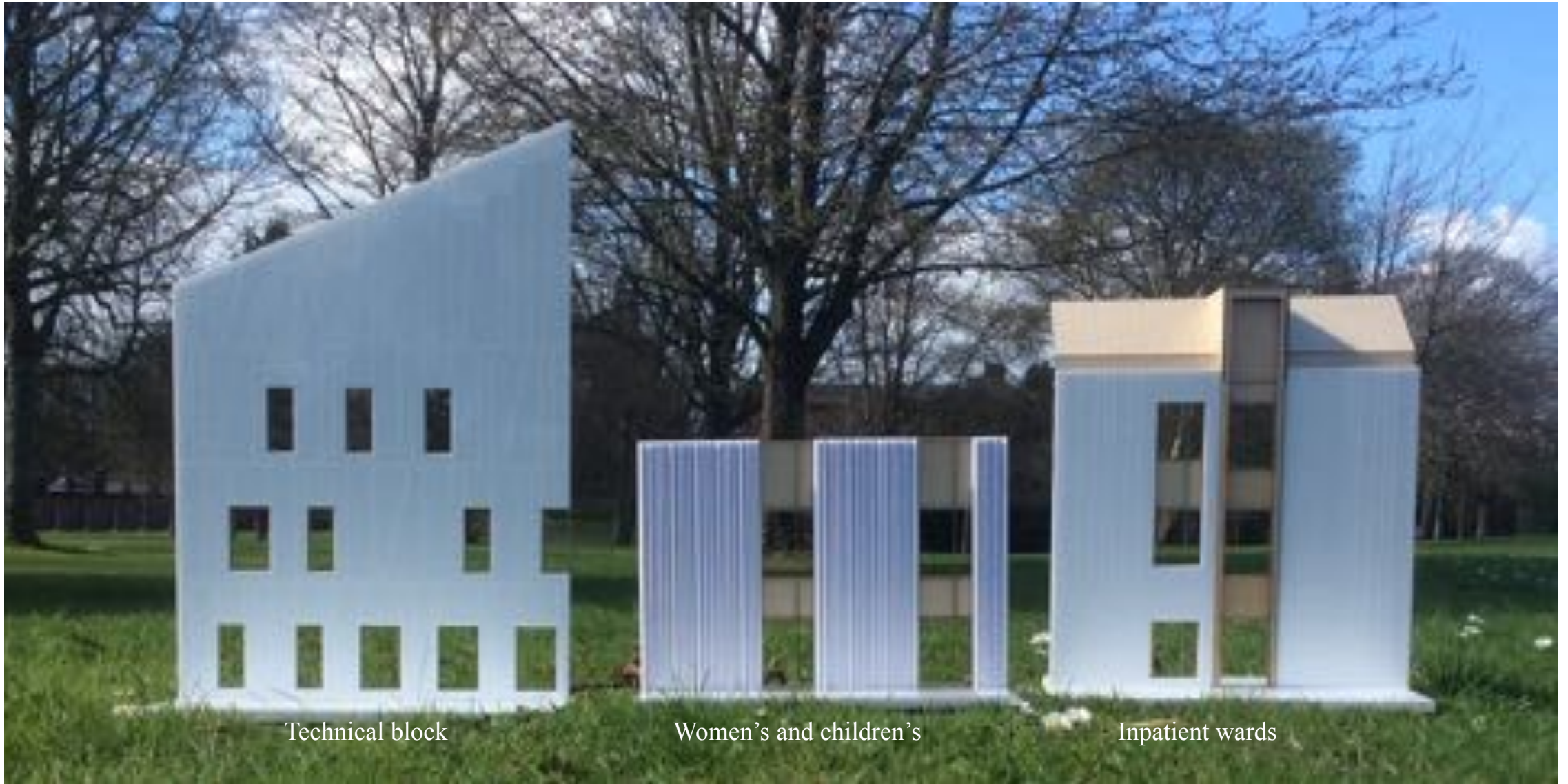

Developing materiality





Technical block

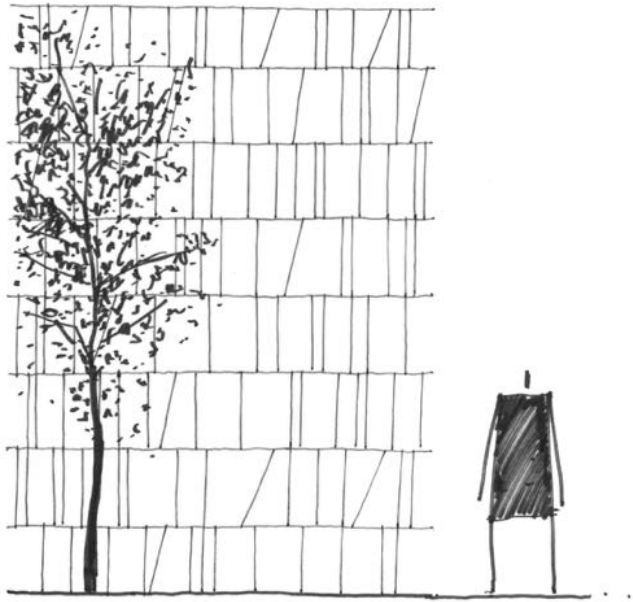

Tree pattern

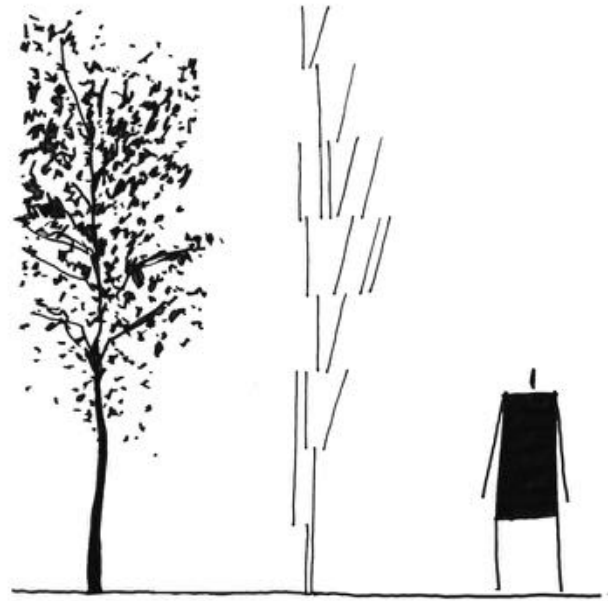



Women and Children's Hospital

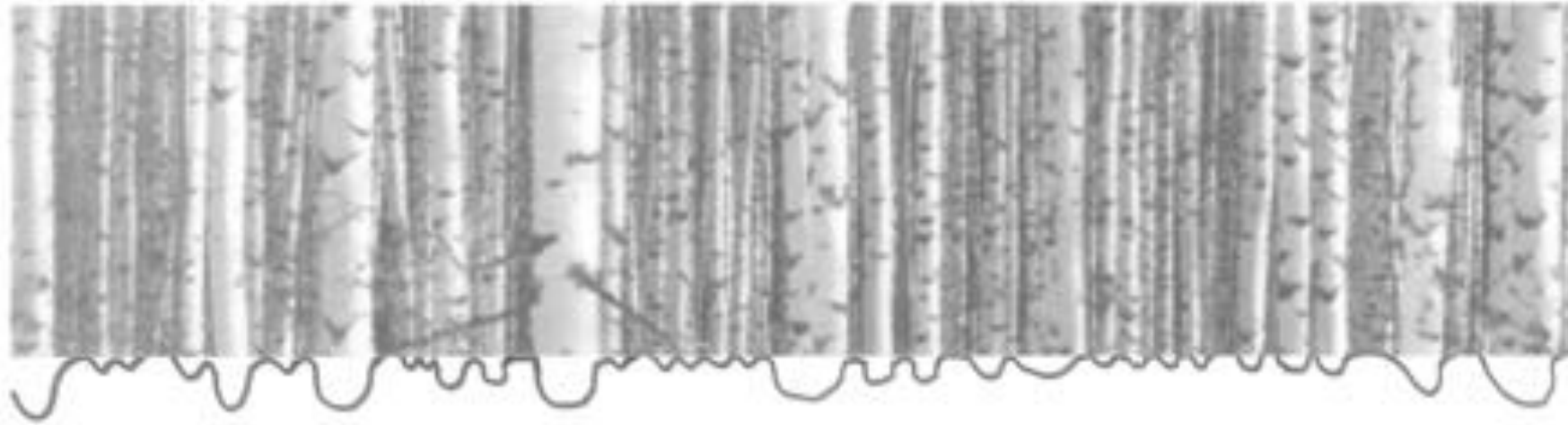

Patterns inspired by woodlands





Segregation of Flows

Second Floor

First Floor

Ground Floor

Lower Ground Floor



The Garden Hospital

Design Strategies

Maximise views and access to nature (three types)

Key

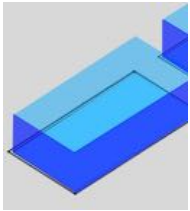

Light courts

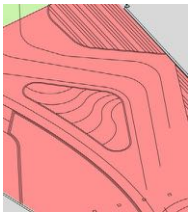

Formal gardens contained

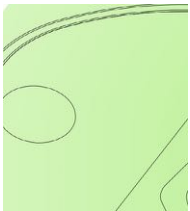

Formal gardens and surrounding landscape

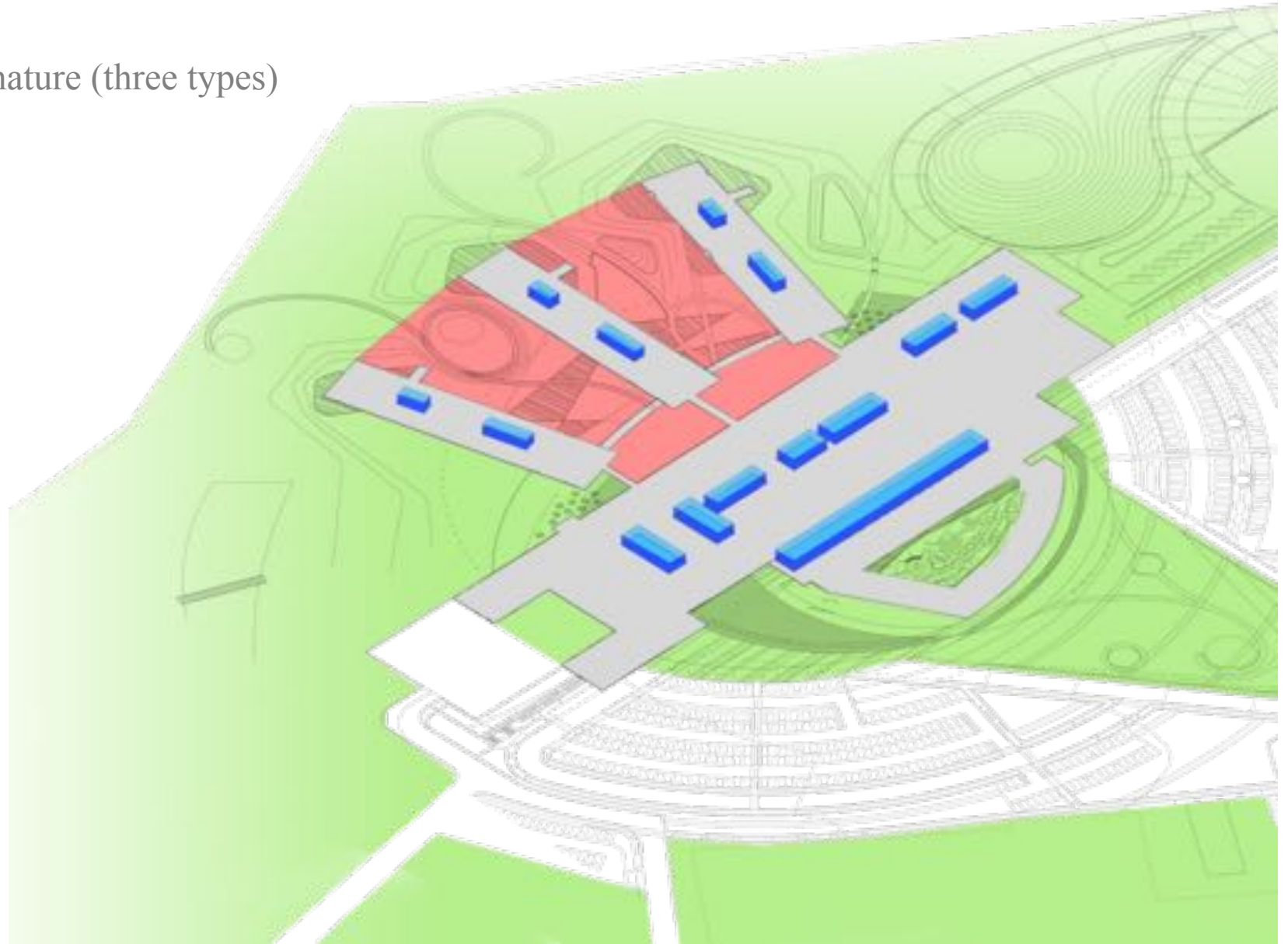

The Garden Hospital

Design Strategies

Maximise access to natural light

Key

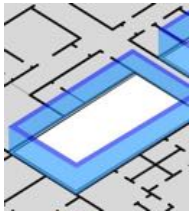

Light courts

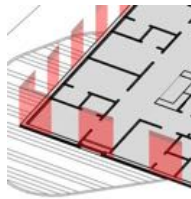

Punched window

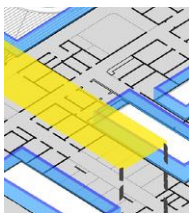

Large expanse of natural light

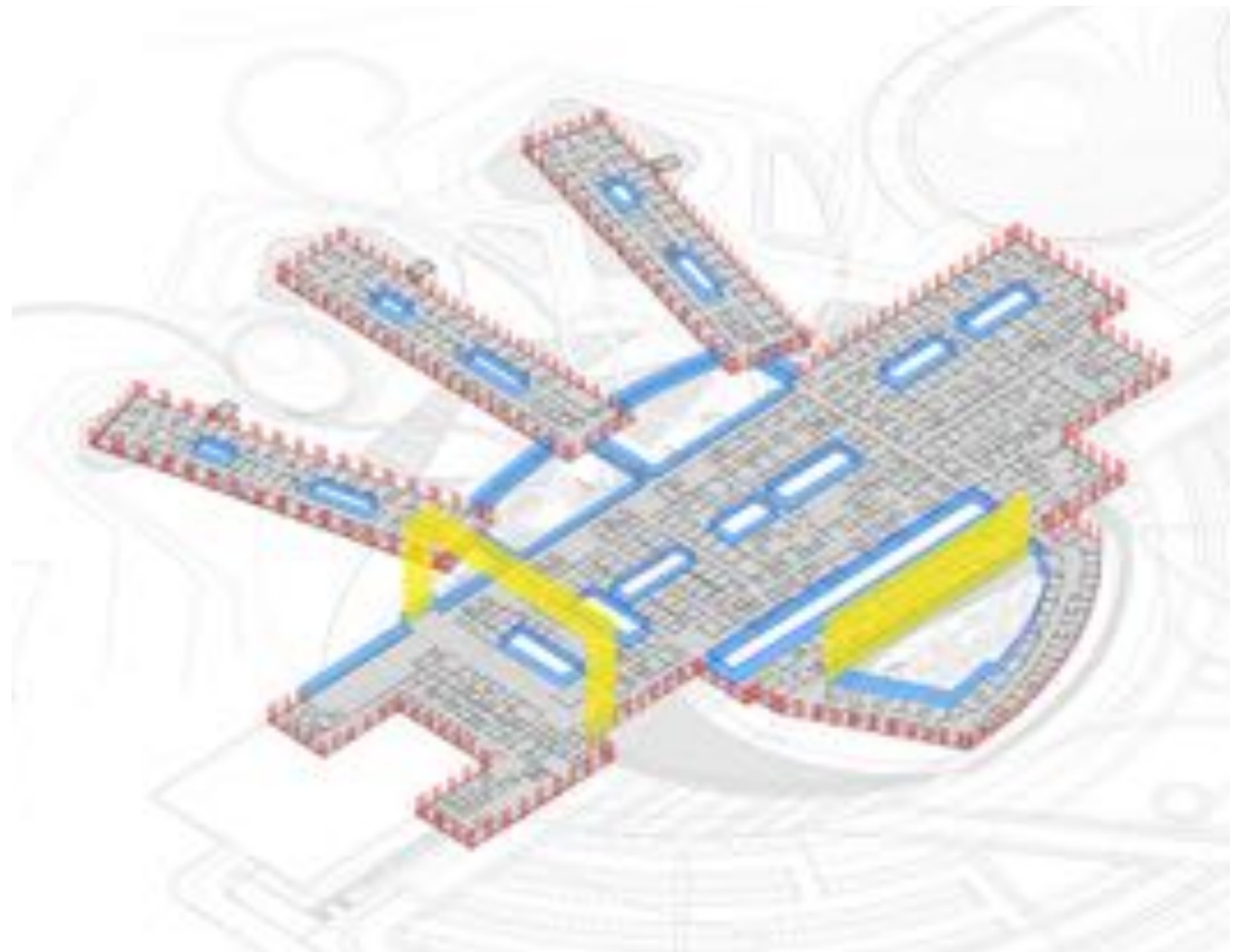

Scene Setting
Colour and Materiality – Bernat Klein



Scene Setting
Colour and Materiality – Bernat Klein



Building Circulation and Amenity Signage and Wayfinding Through Colour

Textures drawn from botanical illustrations

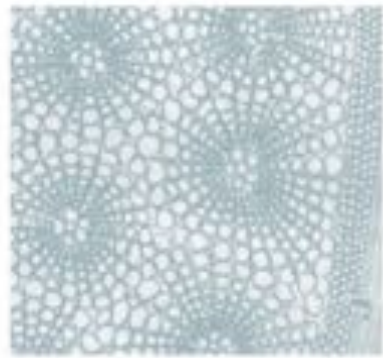
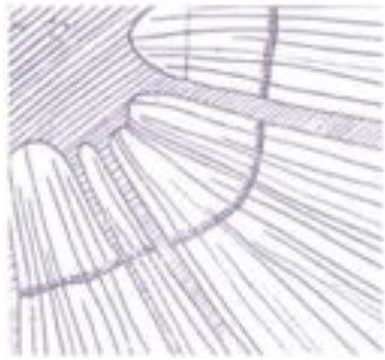

Building Circulation and Amenity

Signage and Wayfinding Through Colour

- Ward A
- Ward B
- Ward C
- Technical Block
- Women's & Children's



Hospital Arrival
Main Entrance Plaza



Hospital Arrival Main Entrance Atrium

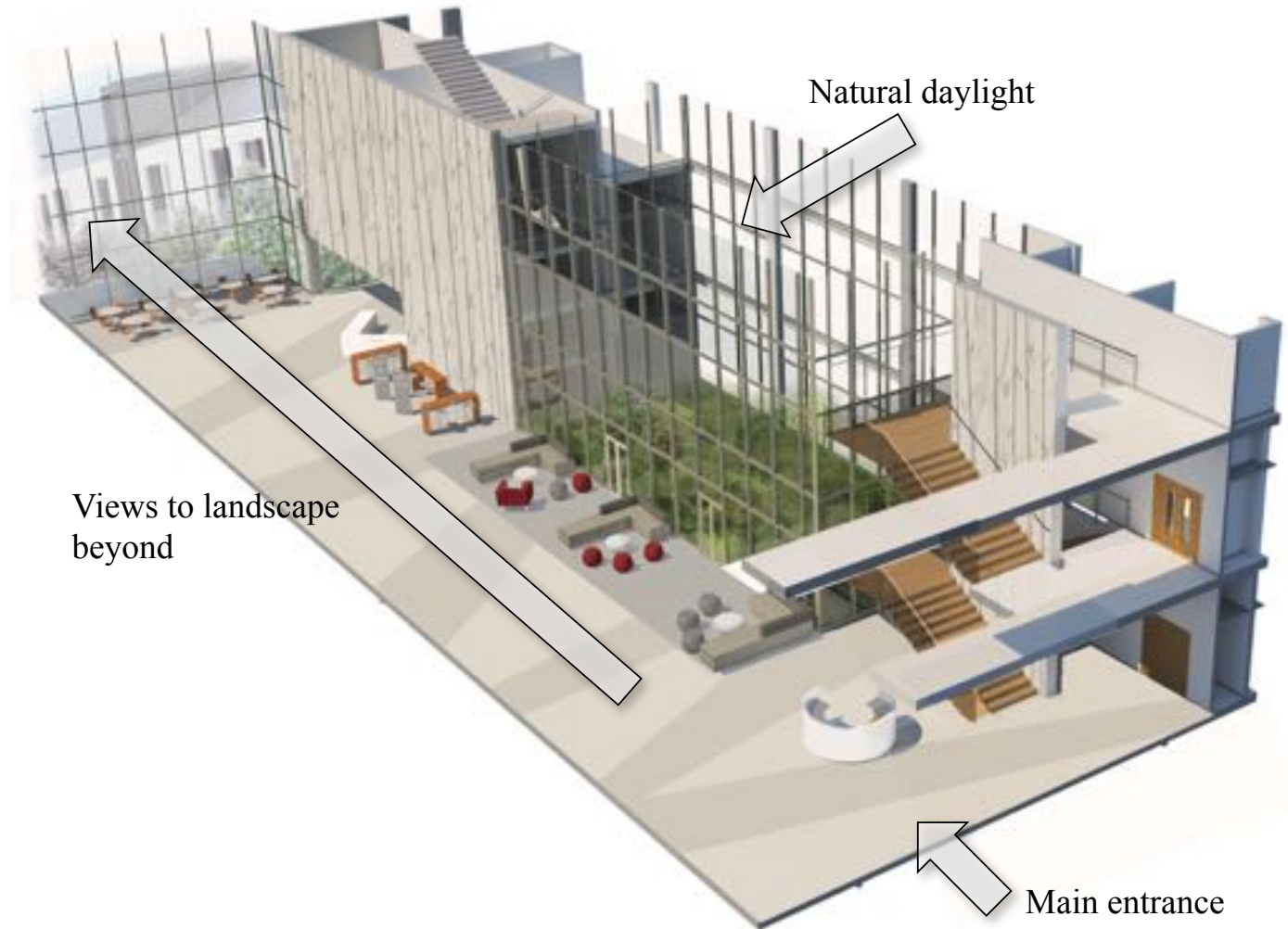

Ground floor plan

Hospital Arrival Main Entrance Atrium



Ground floor plan

Public Space

Views From the Café



Ground floor plan

Public Space Café Entrance



Ground floor plan

Public Space
Café

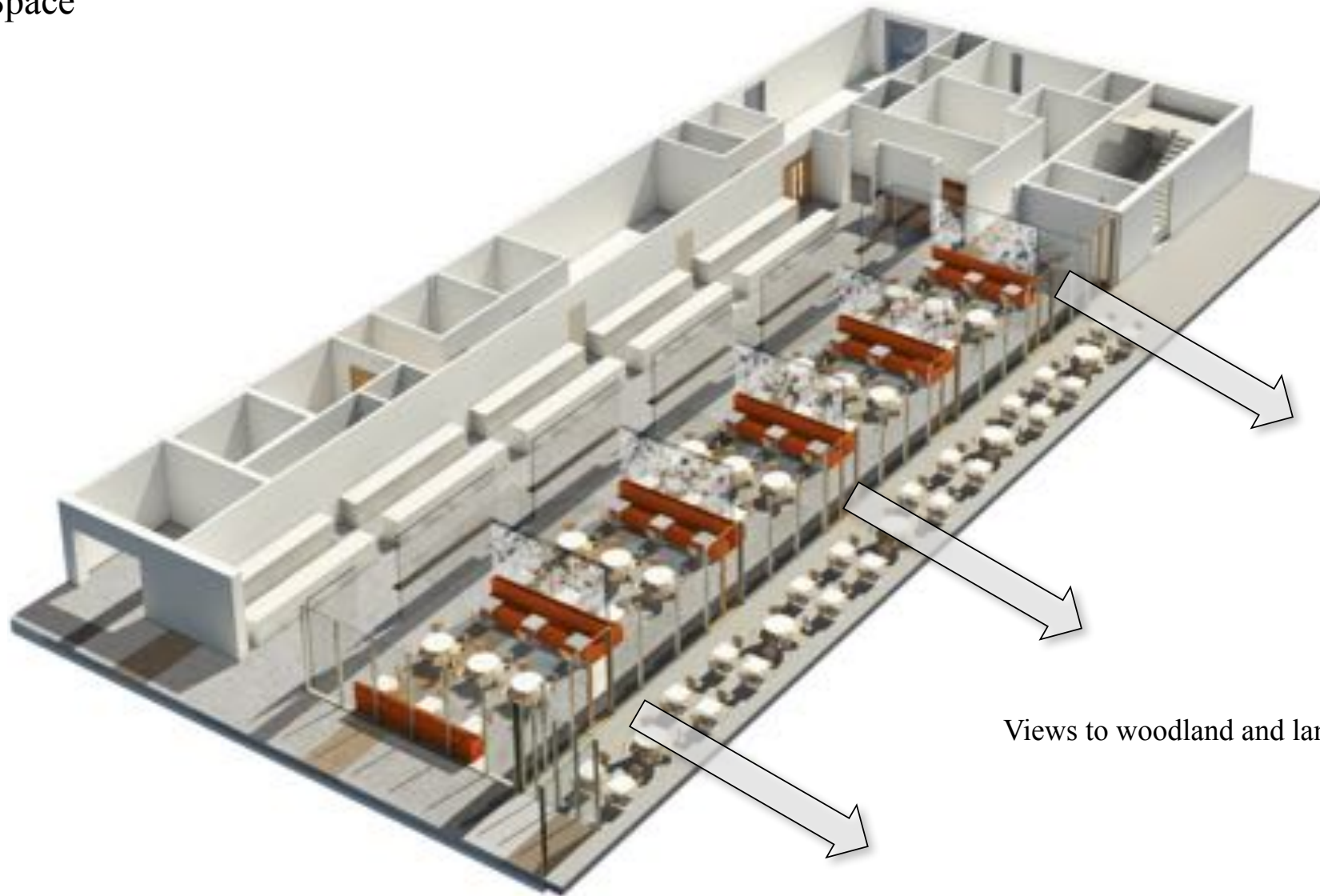

Views to woodland and landscape

Public Space
Café



Public Space Ambulatory Care Entrance



Ground floor plan

The Garden Hospital – A Journey to Health

Interior Design Strategies



Ambulatory care entrance



Waiting Areas



Hospital Gardens



Hospital garden

Reflective garden



Waiting Areas and Journey to Wards



Ward Gardens

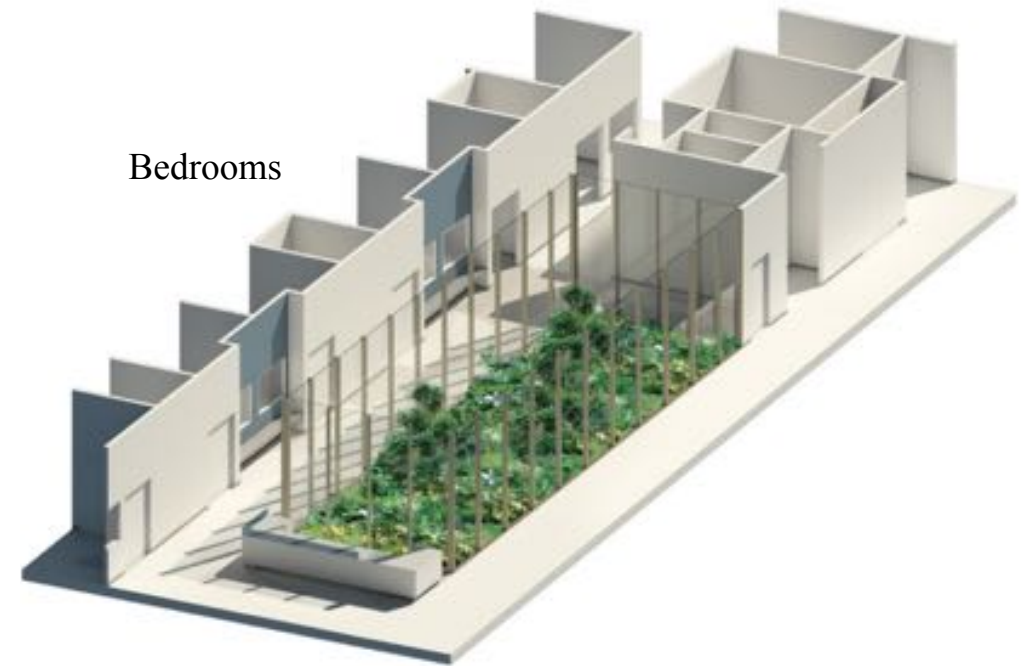
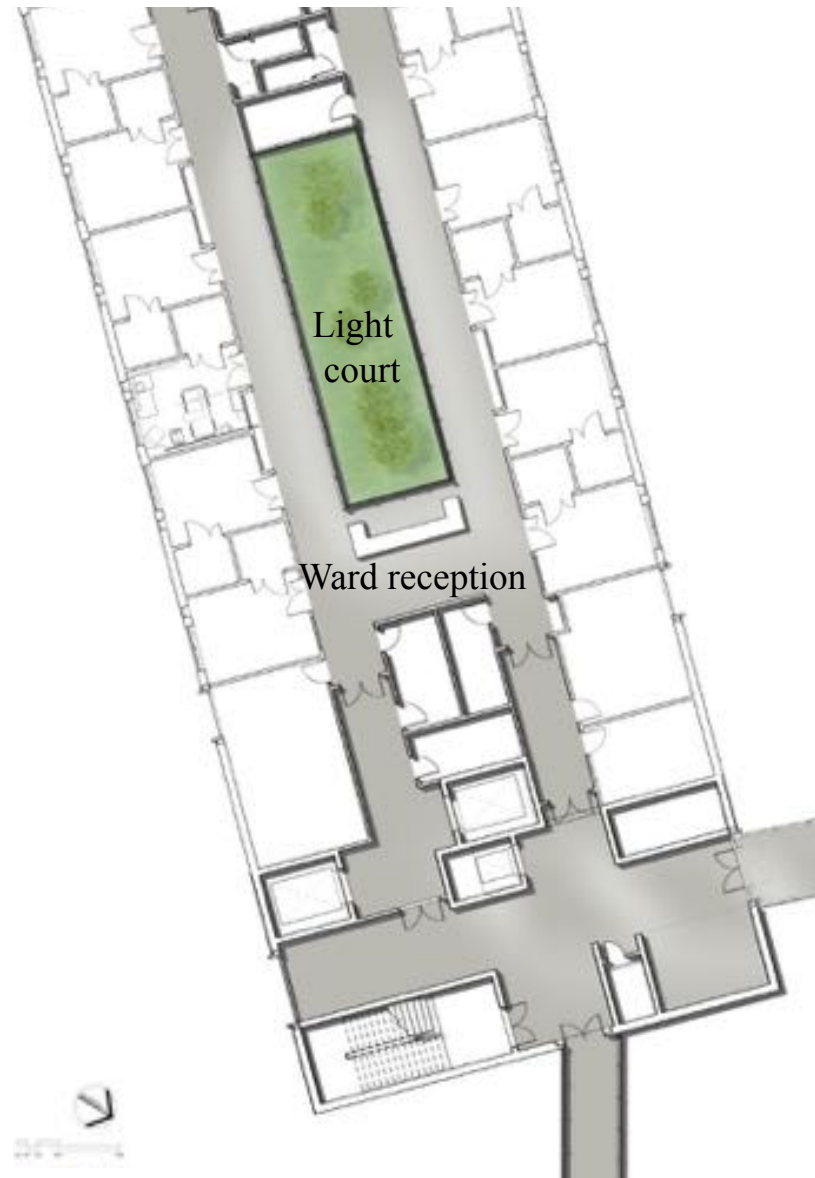

Ward Entrance



Typical Patient Bedroom

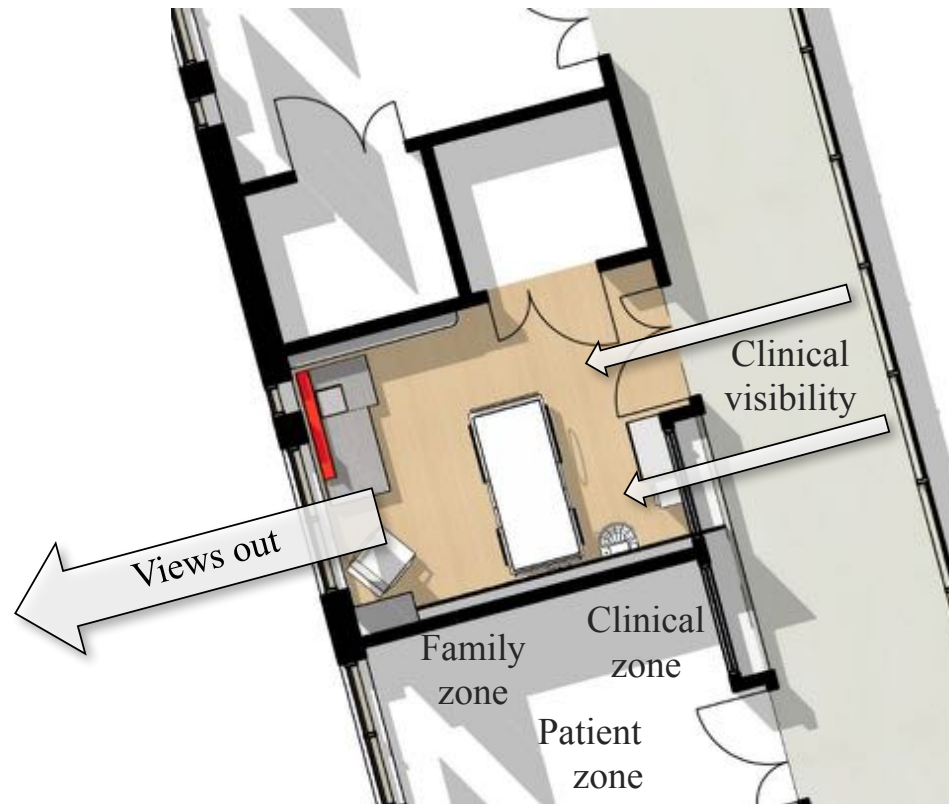

Patient Bedroom



Patient Bedroom and End of Corridor



Typical Staff Base



Palliative Care Bedrooms



Ward Gardens Gardens Within a Landscape



Gardens within the ward spaces
Palliative care – quiet, calm and views out
Social spaces break out from internal spaces
Therapy garden to aid with rehab
All designed to be dementia friendly

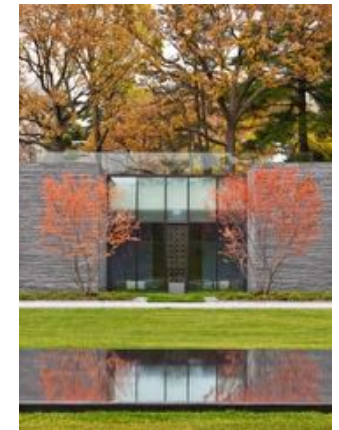

Social Spaces



Covered space

Seating / social space

Optional path loop

6

Links with indoor social space

Contained garden

Optional walking route

Covered external space

Seating, high quality planting and good paving

Set within a parkland landscape

Therapy Garden and Rehab

Design based on experience DNRC and orthopaedic projects

Hand rails, ramps, uneven ground with wheelchair training space

Set within a defined garden space

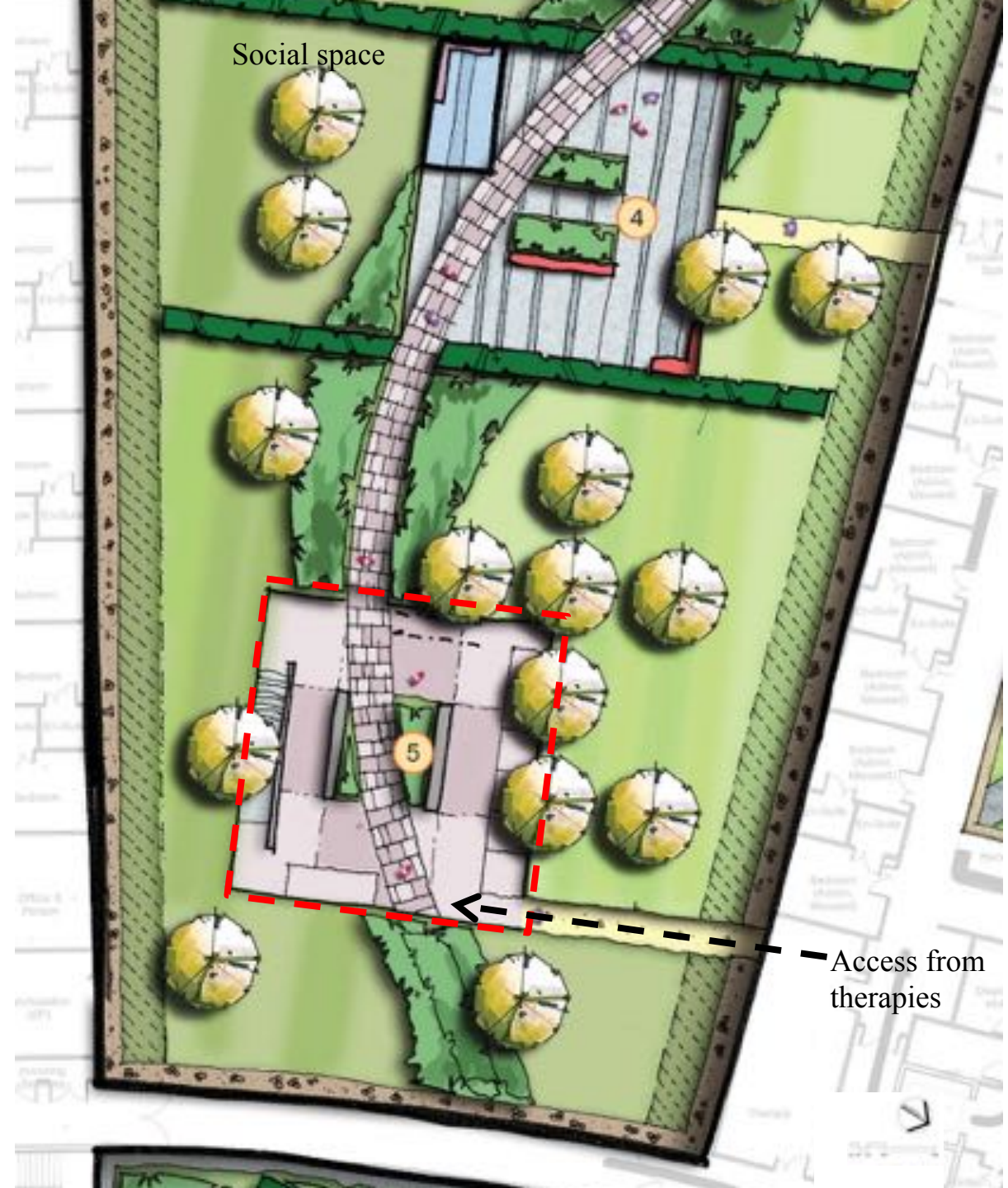

Views Towards Therapy Gardens



Therapy Garden



Therapy Garden



Public Landscape





Dumfries and Galloway

Dumfries and Galloway Royal Infirmary

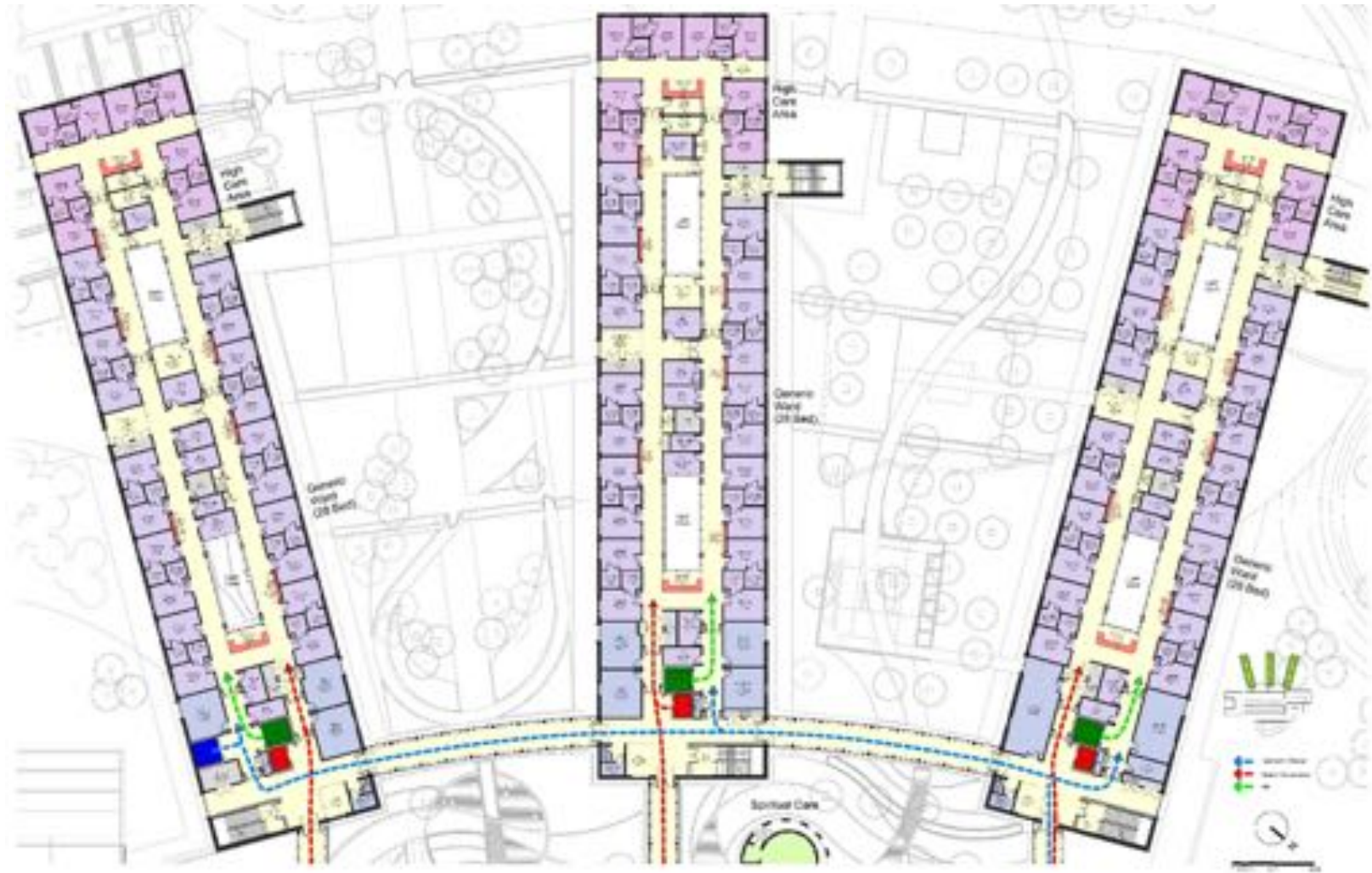

Dumfries and Galloway Royal Infirmary

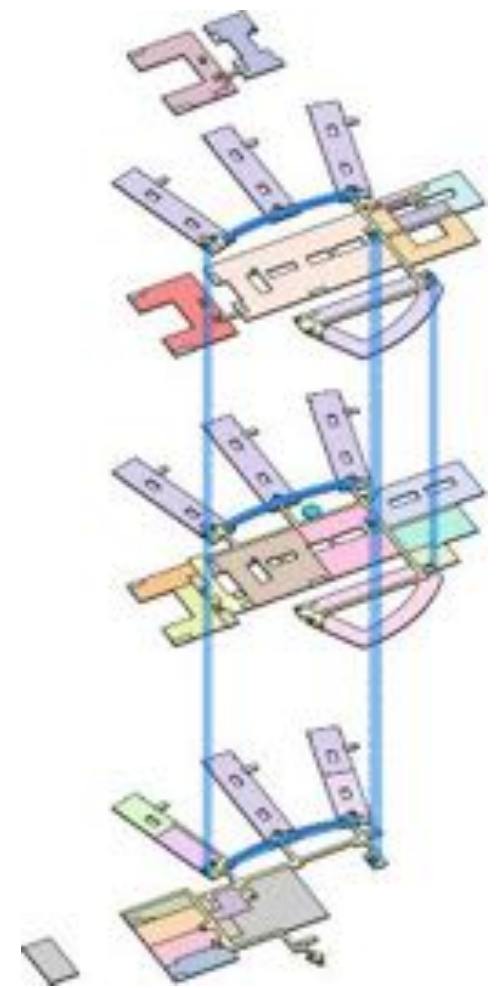
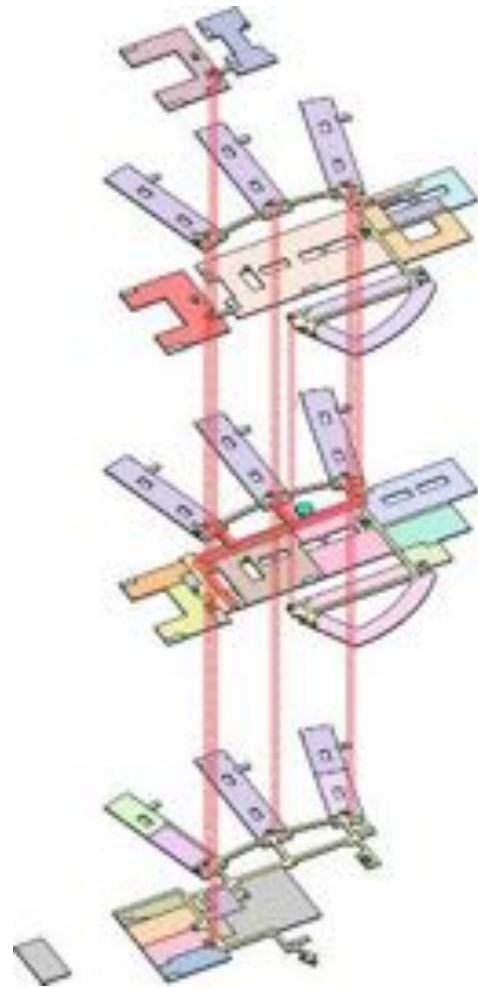
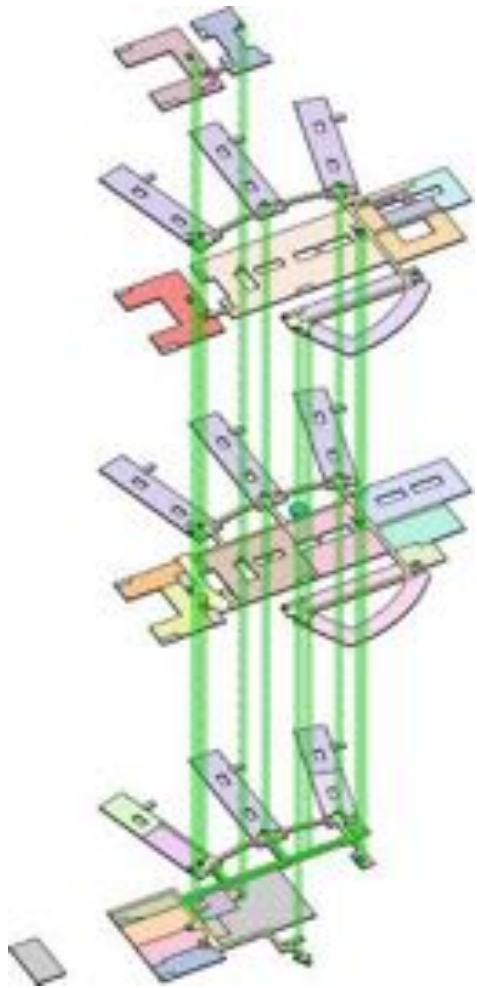







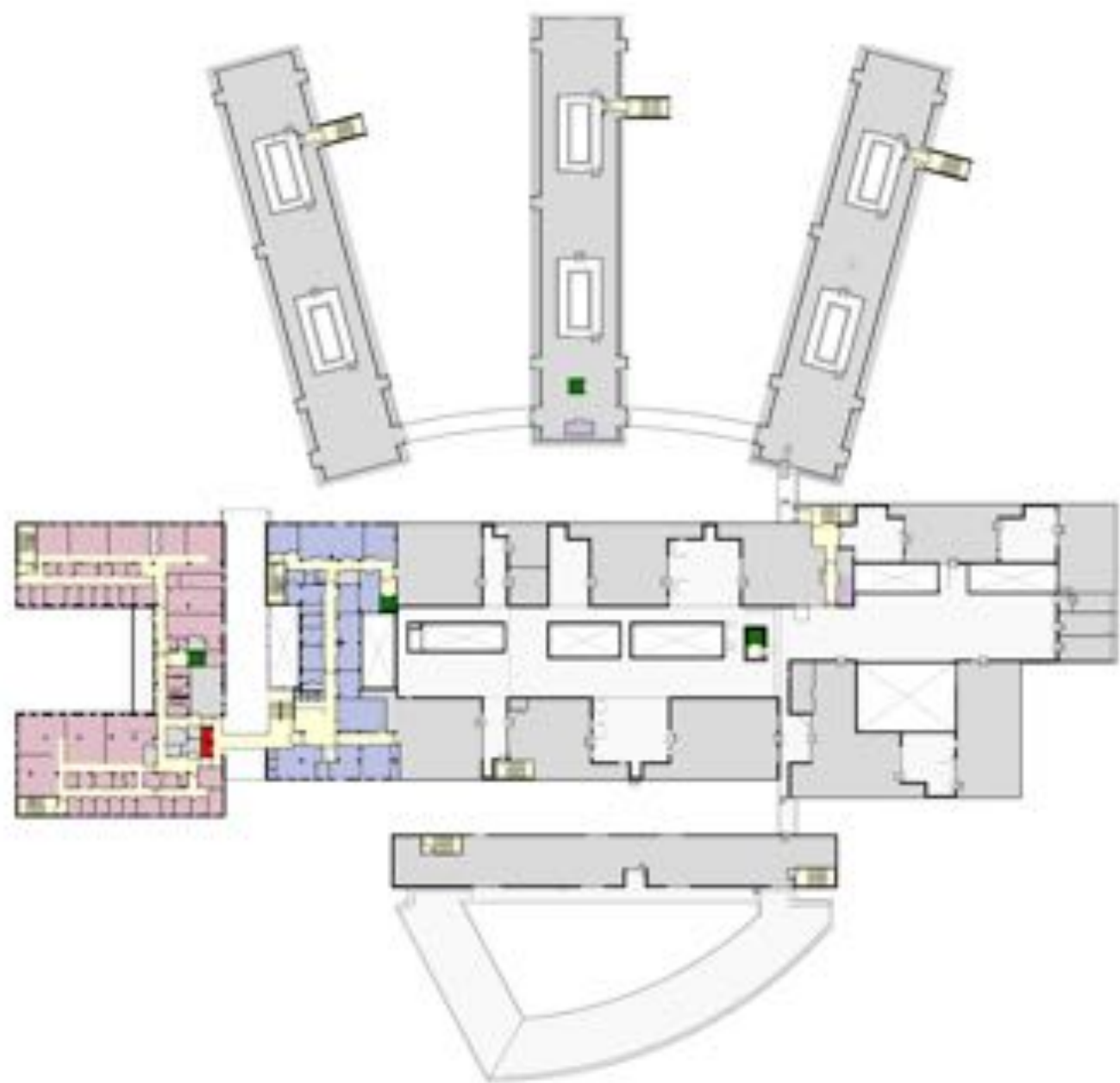

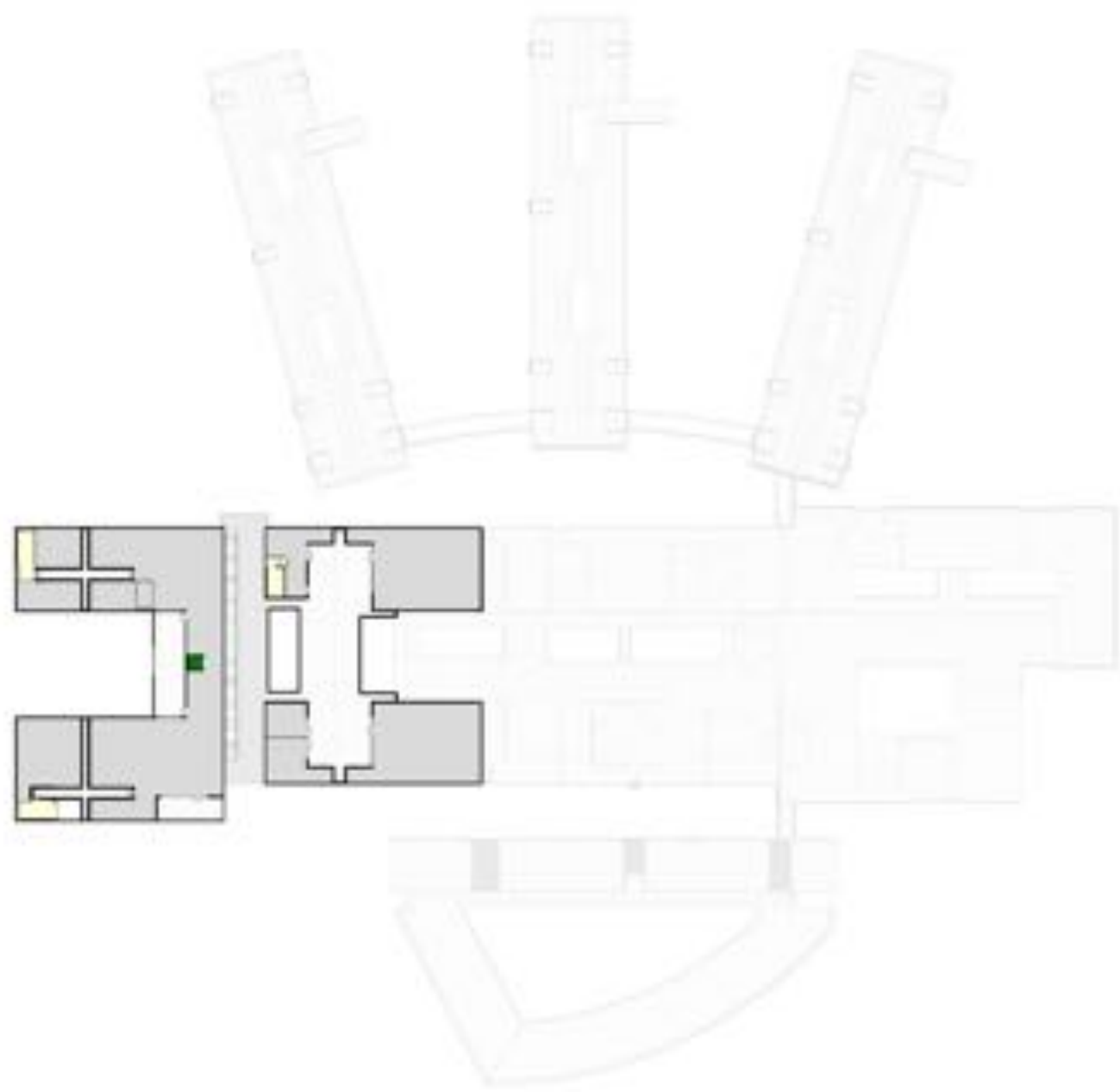

Contact Details

NBBJ

www.nbbj.com

Twitter: [@NBBJDesign](https://twitter.com/NBBJDesign)

LinkedIn: [/nbbjdesign](https://www.linkedin.com/company/nbbjdesign)

Ryder Architecture

www.ryderarchitecture.com

Twitter: [@Ryder1953](https://twitter.com/Ryder1953)

LinkedIn: [/ryder-architecture](https://www.linkedin.com/company/ryder-architecture)