

Health Quarters of the Future

European Healthcare Design 2018

12 June, Stream 5: Sustainable Development

Session 16: Redefining health and sustainability



MEDICINE



PATIENT

DESIGN

MEDICINE

**INTUITIVE
MEDICINE**

**EMPIRICAL
MEDICINE**

**EVIDENCE BASED
MEDICINE**

**PRECISION
MEDICINE**

1900

2000

MEDICINE

**PREVENTIVE
MEDICINE**

**LIFE STYLE
MEDICINE**

**MEDICINE
FOR THE ELDERLY**

PATIENT

Gen X is the future of health care

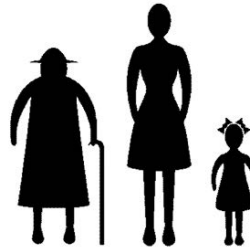

DESIGN



**PRECISION
MEDICINE**

**MEDICINE
4.0**



**PREVENTIVE
MEDICINE**

**LIFE STYLE
MEDICINE**

**MEDICINE
FOR THE ELDERLY**

DESIGN

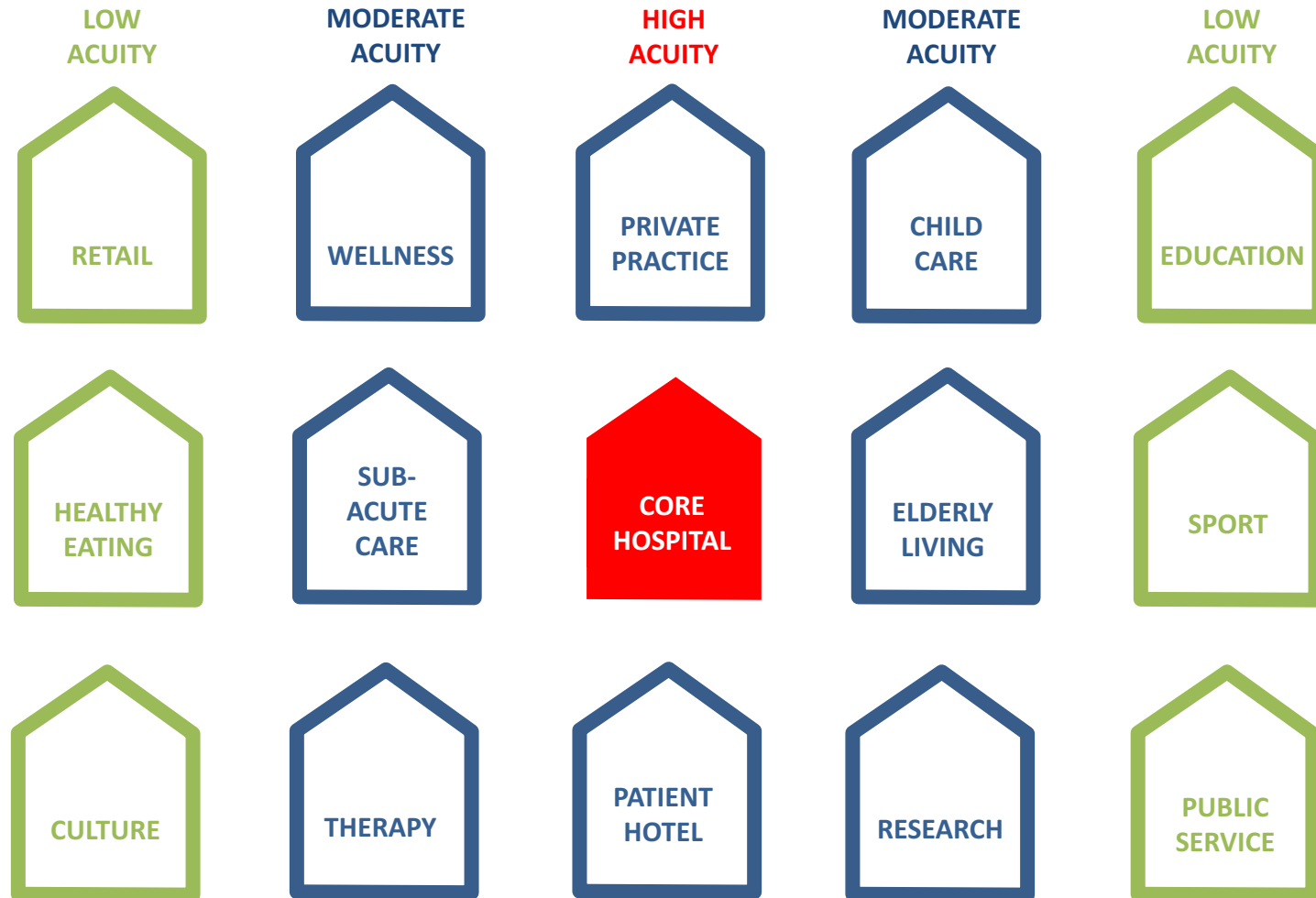

DESIGN



**OTTO WAGNER SPITAL
VIENNA - 1907**



**HEALTH CITY NOVENA
SINGAPOUR - 2030**

Südspidol

Case Study

Esch sur Alzette, Luxembourg





sub-acute care

national cancer center

core hospital

office

specialist clinic

healing garden

medical centre

car park

UNDERGROUND LEVEL



robotized supply system

GROUND FLOOR



freeway access

WARD - PAD CONCEPT

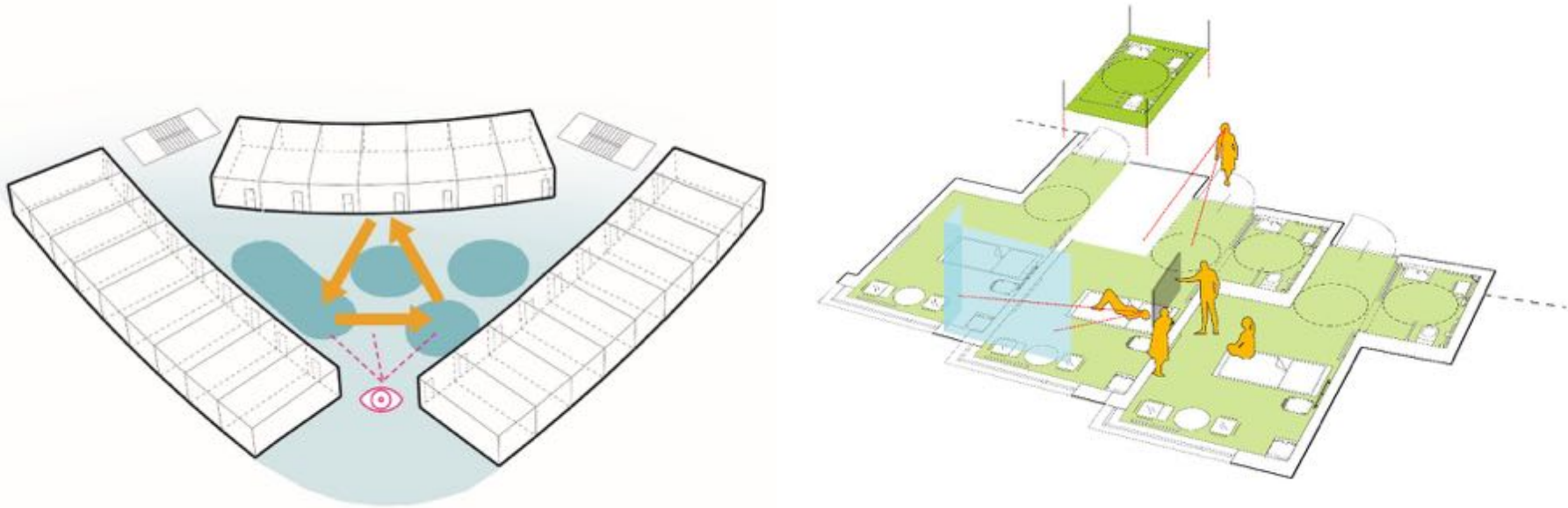

**triangle framework of private, same-handed
single rooms, open-office-like working
environment, central meeting square and
service modules**

WARD - PAD CONCEPT

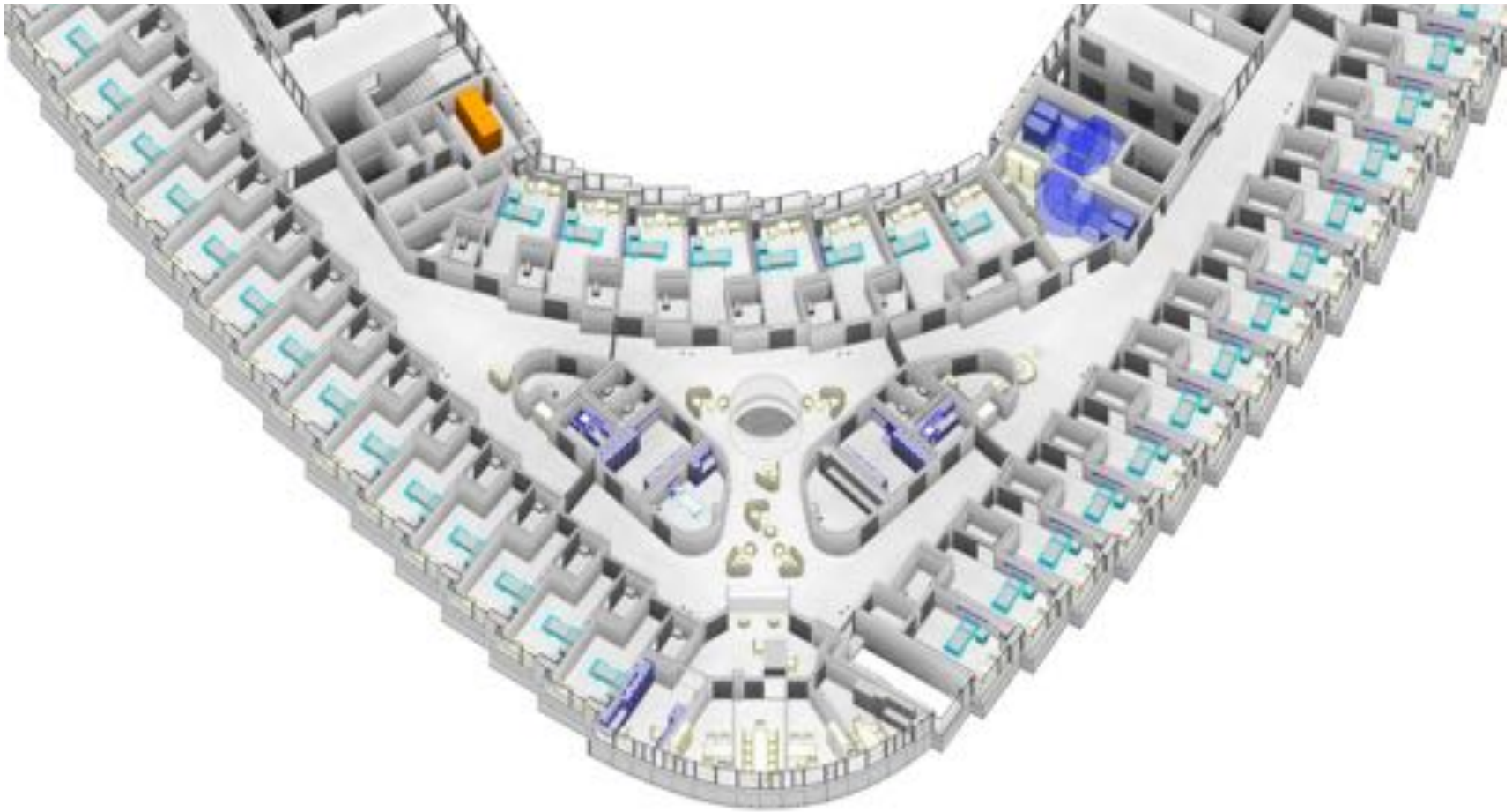

Südspidol

Case Study

Esch sur Alzette, Luxembourg





CHEM / HTE

Project Südspidol

- Process management
- Separation of flows
- Short ways
- Life-cycle



- Emergency patient process

- Out-patient process

Process management in healthcare organizations :

- In-patient process (medical)

patient centered

- In-patient process (surgical)

SEPARATION OF FLOWS ADAPTED TO PROCESS

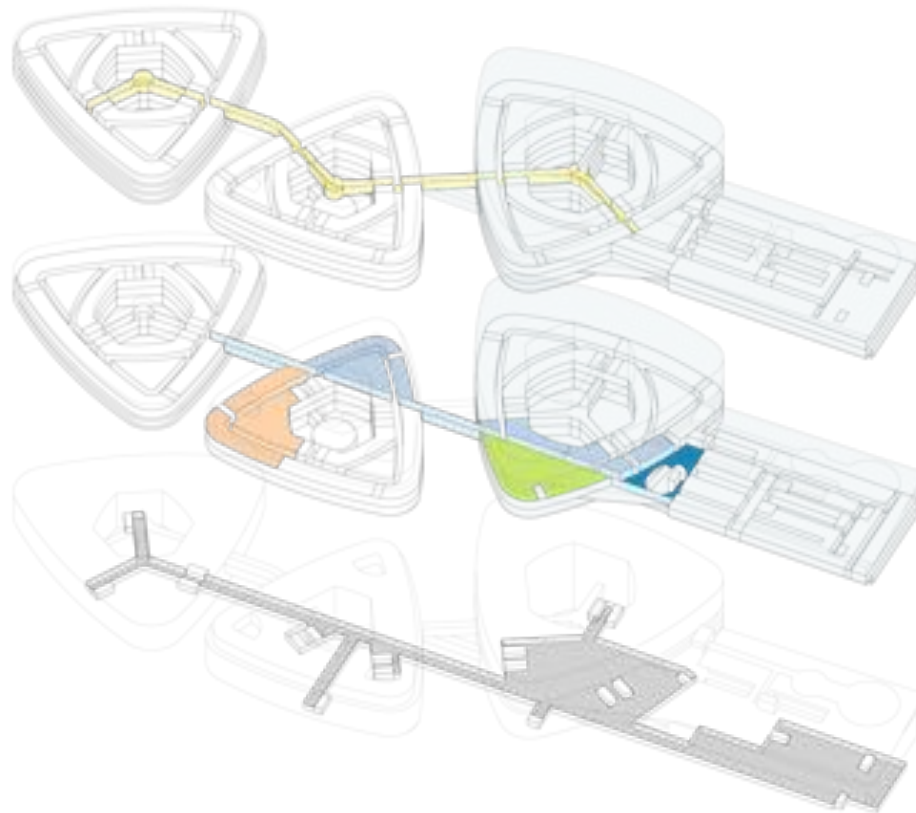

SEPARATION OF FLOWS ADAPTED TO PROCESS

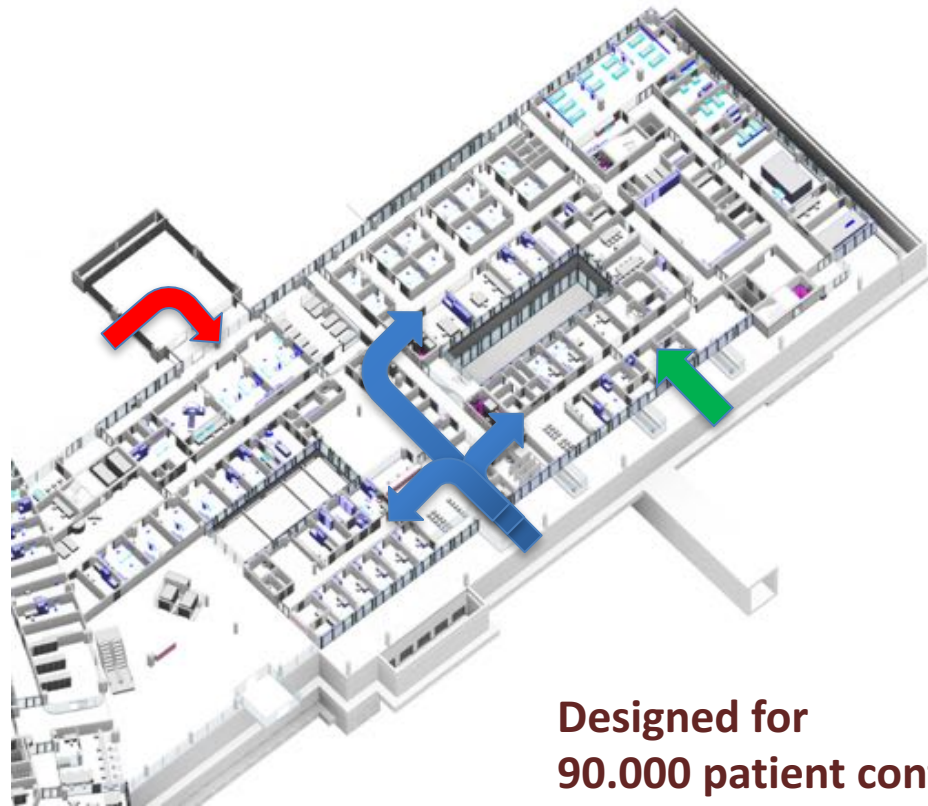

**Designed for
90.000 patient contacts/year**

User-proposal :short ways ?

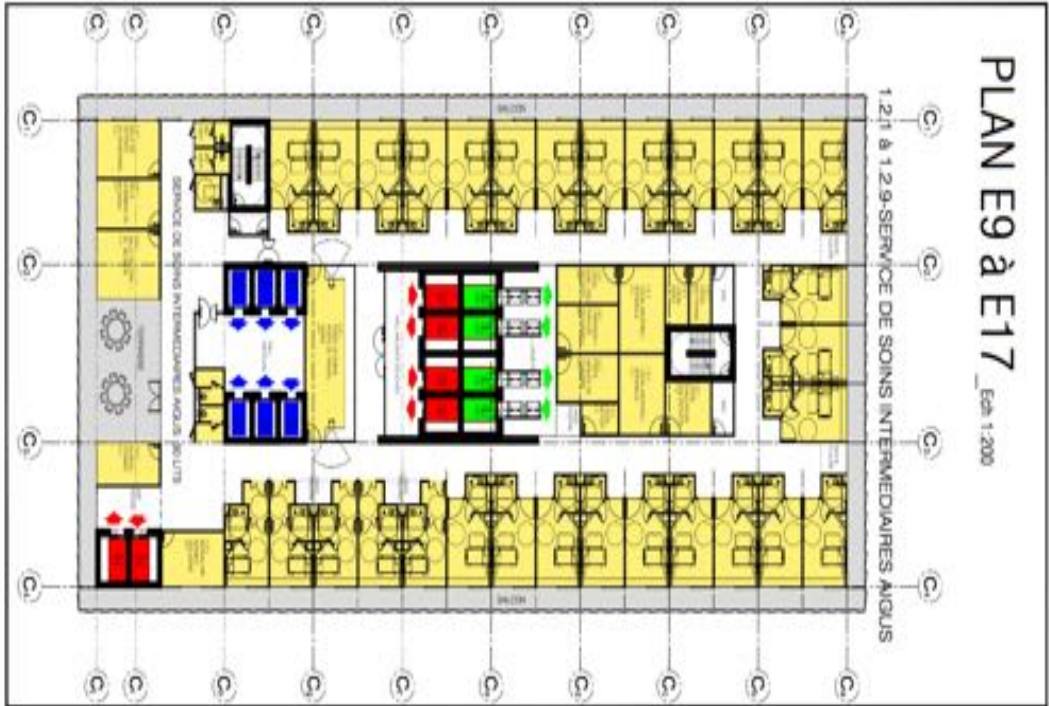

INNOVATE: SHORT WAYS PROJECT „SÜDSPIDO“

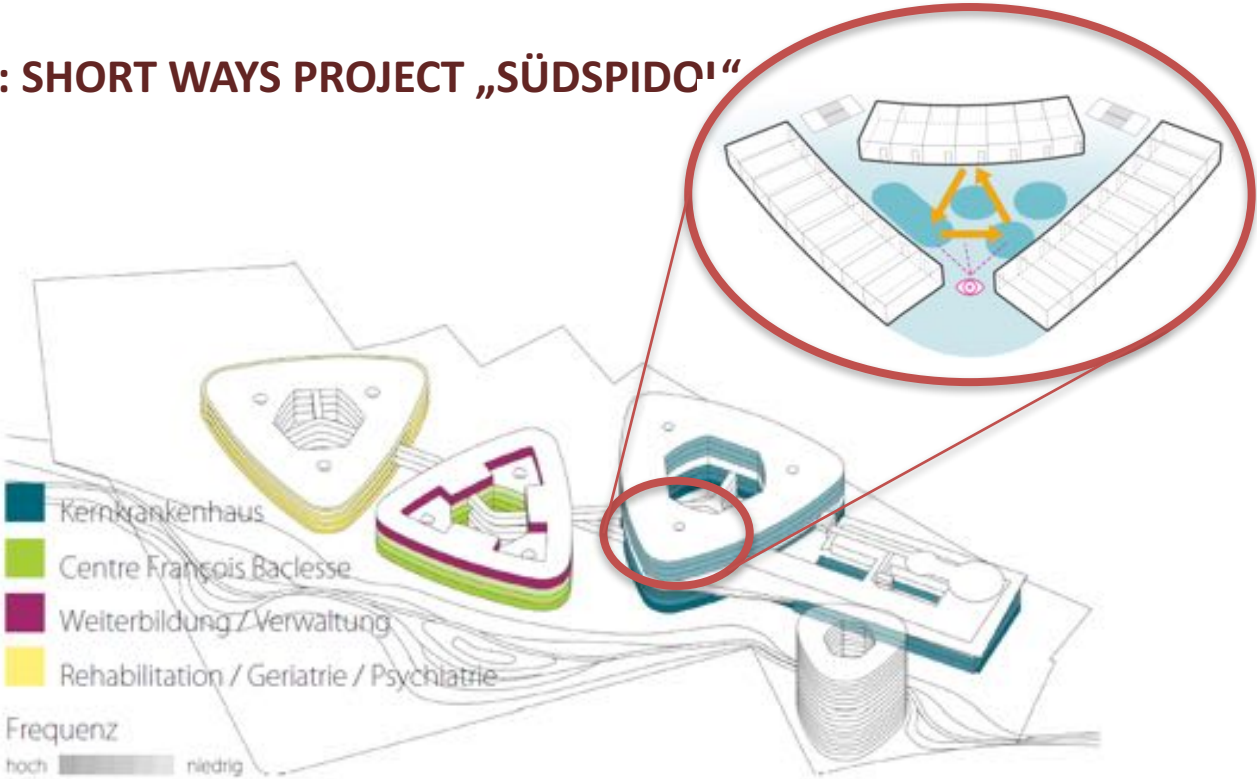

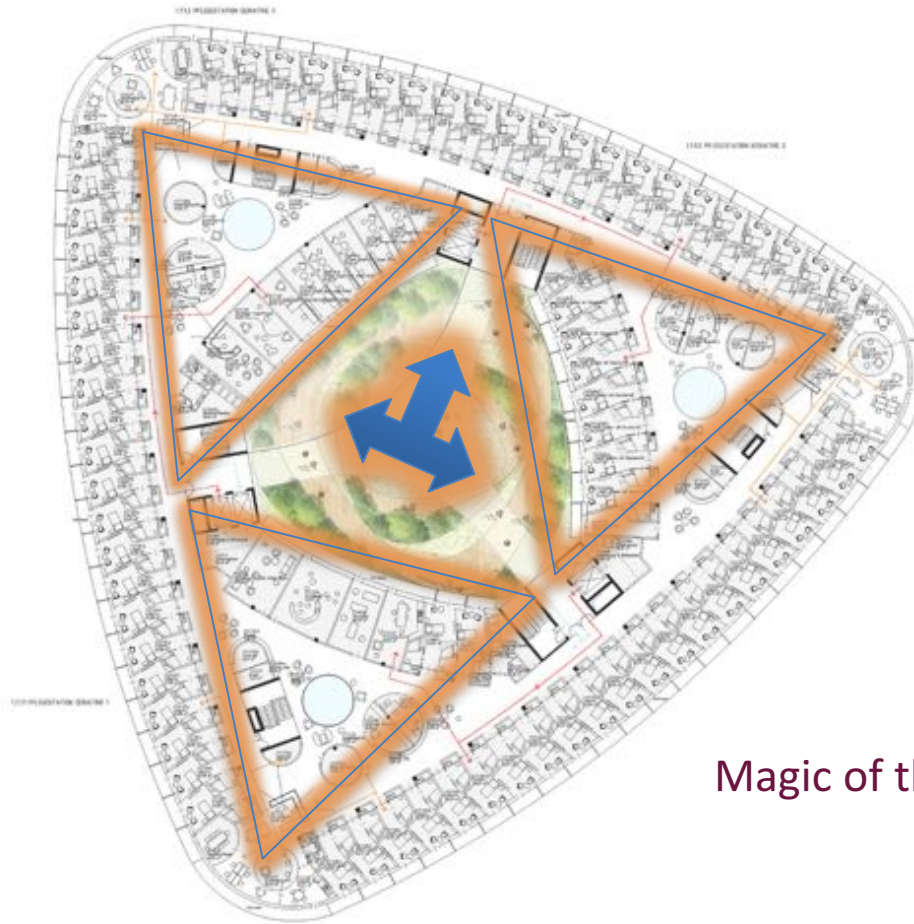

Magic of the triangle

Magic of the circle: industrializing



Hotellery,
Meals,
Comfort-offers

Strategic planning of hospitals according to life cycles

PAUL WURTH
GEPROLUX

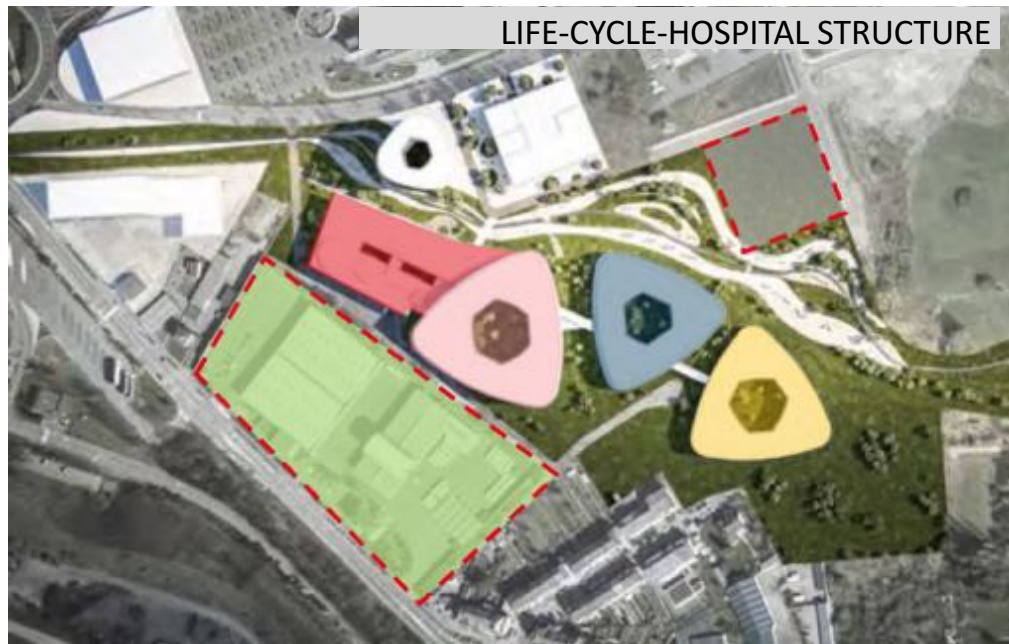

Emergency
Radiology
Endoscopy
Surgery

Examination &
treatment Acute care
units

Oncology
Administration

Rehabilitation
Geriatrics

Buffer land area

© Paul Wurth Geprolux Heinrich LIMACHER, Jean-Marc ZAHNEN

Strategic planning of hospitals according to life cycles

PAUL WURTH

GEPROLUX

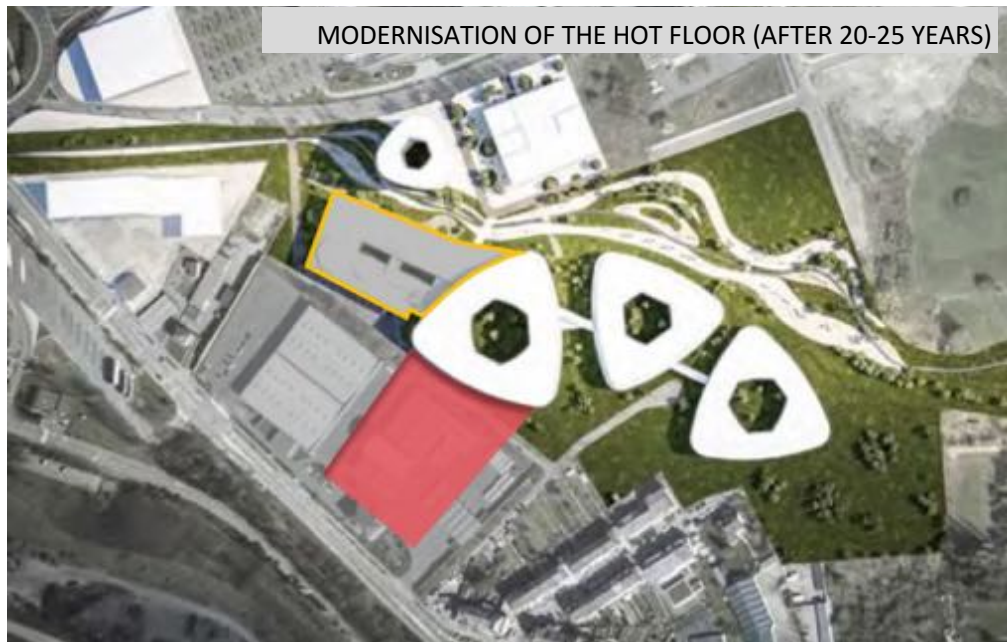

MODERNISATION OF THE HOT FLOOR (AFTER 20-25 YEARS)

Clearing the buffer
land area

- New hot floor
- Emergency
 - Radiology
 - Endoscopy
 - Surgery

Deconstruction or
new usage

© Paul Wurth Geprolux Heinrich LIMACHER, Jean-Marc ZAHNEN

Take-home message :

- process leads to structure
- flexibility needs preparation
- user get`s translation from architect

Team-work



