

**Maggie's**

*maggie's*

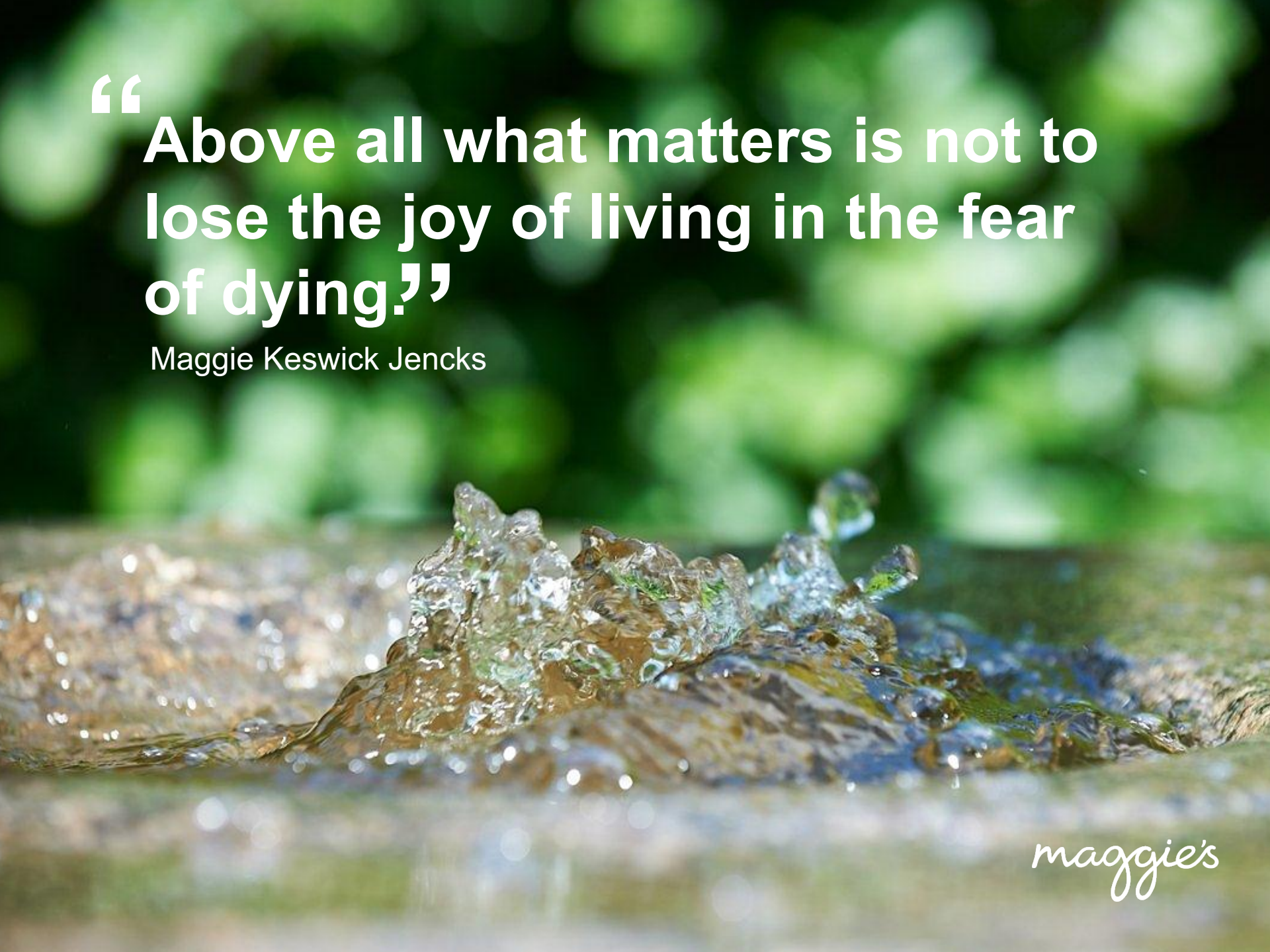



“Above all what matters is not to lose the joy of living in the fear of dying.”

Maggie Keswick Jencks

*maggie's*



LET'S  
GO  
DOWN

NO  
PARKING

*maggie's*



*maggie's*

**Maggie's provides free practical, emotional and social support for people with cancer, and their family and friends through our growing network of Centres across the UK and Online.**

*maggie's*



*maggie's*



*maggie's*





THE  
ARCHITECTURE  
OF HOPE

MAGGIE'S CANCER CARING CENTRES  
CHARLES JENCKS — EDWIN HEATHCOTE

# Putting us on the map

*maggie's*



*maggie's*



*maggie's*

# Being daring

*maggie's*



*maggie's*

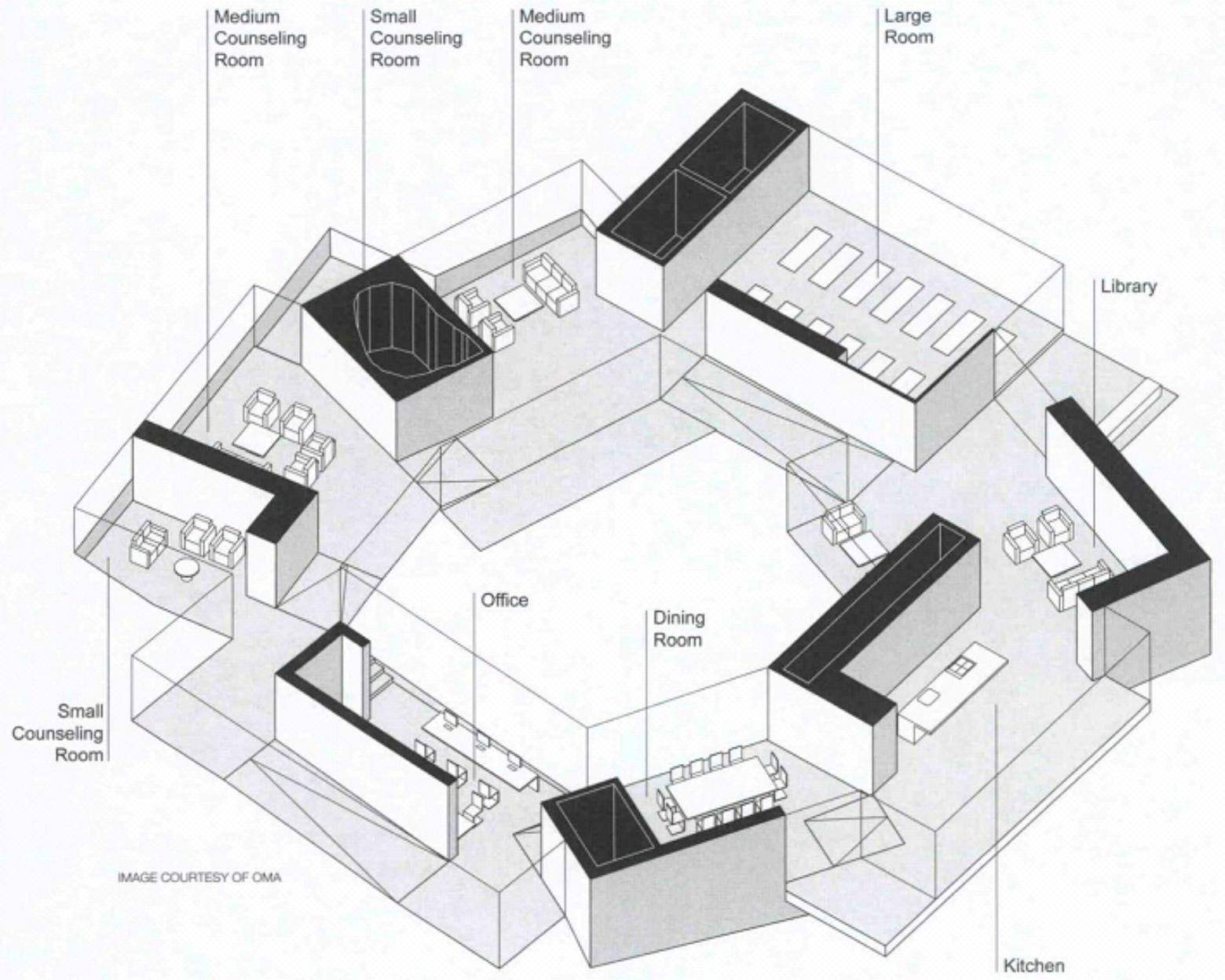

**Above** - A sequence of rooms superimposed one upon the other negates the need for hallways



*maggie's*





*maggie's*

**Open to opportunities**

*maggie's*



*maggie's*



*maggie's*



**Edinburgh - 1996**



**Glasgow, Gatehouse - 2002**



**Dundee - 2003**



**Highlands - 2005**



**Fife - 2006**



**West London - 2008**



**Cheltenham - 2010**



**Swansea - 2011**



**Nottingham - 2011**



**Glasgow, Gartnavel - 2011**



**Newcastle - 2013**



**Aberdeen - 2013**



**Hong Kong - 2013**



**Merseyside - 2014**



**Lanarkshire - 2014**



**Oxford - 2014**



**Manchester - 2016**



**Tokyo - 2016**

*mygg's*

# **A short BBC film about our Centres**

*maggie's*

# The growing need for Maggie's support

- Over 300,000 new people are diagnosed with cancer each year
- Two million people are living with or after cancer in the UK today
- By 2020, one in two people will be diagnosed with cancer within their lifetime
- As the number of people living with cancer increases, so does the need for the practical and emotional support we provide

*maggie's*



# The support Maggie's provides

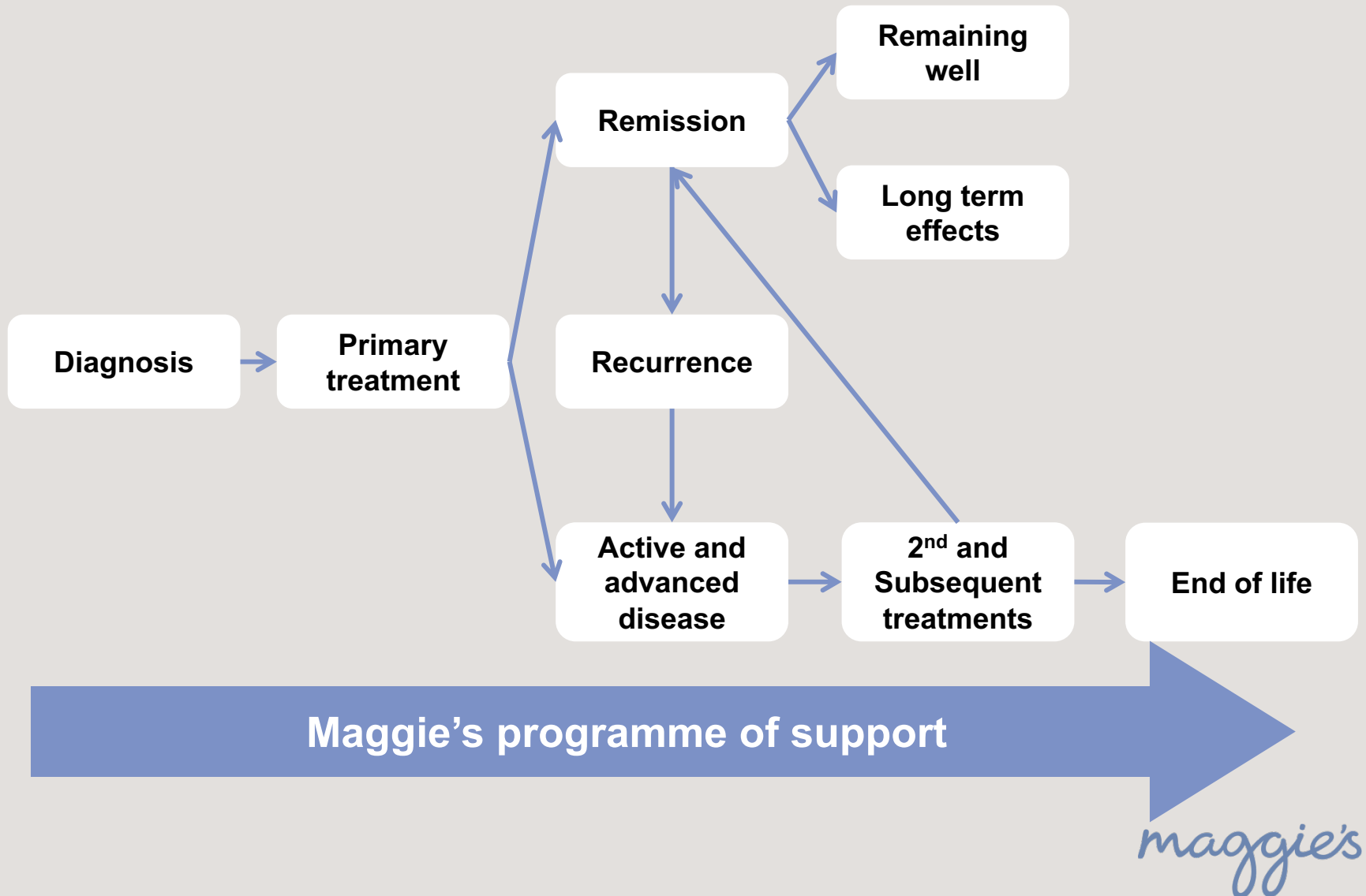

# A typical day at a Maggie's Centre

**09.00 – 17.00:** Drop in

**10.00 – 11.00:** Yoga

**11.15 – 12.30:** Secondary cancer support group

**13.00 – 15.00:** Brain tumour support group (monthly)

**13.00 – 15.00:** Look Good Feel Better

**14.00 – 15.00:** Relaxation group

**13.15 – 16.15:** Managing Sleep Difficulties

**14.00 – 15.30:** Bereavement group

**18.30 – 20.30:** Where Now? (7 week post treatment course)



*maggie's*

# 1.4M visits to Maggie's Centres since 1996

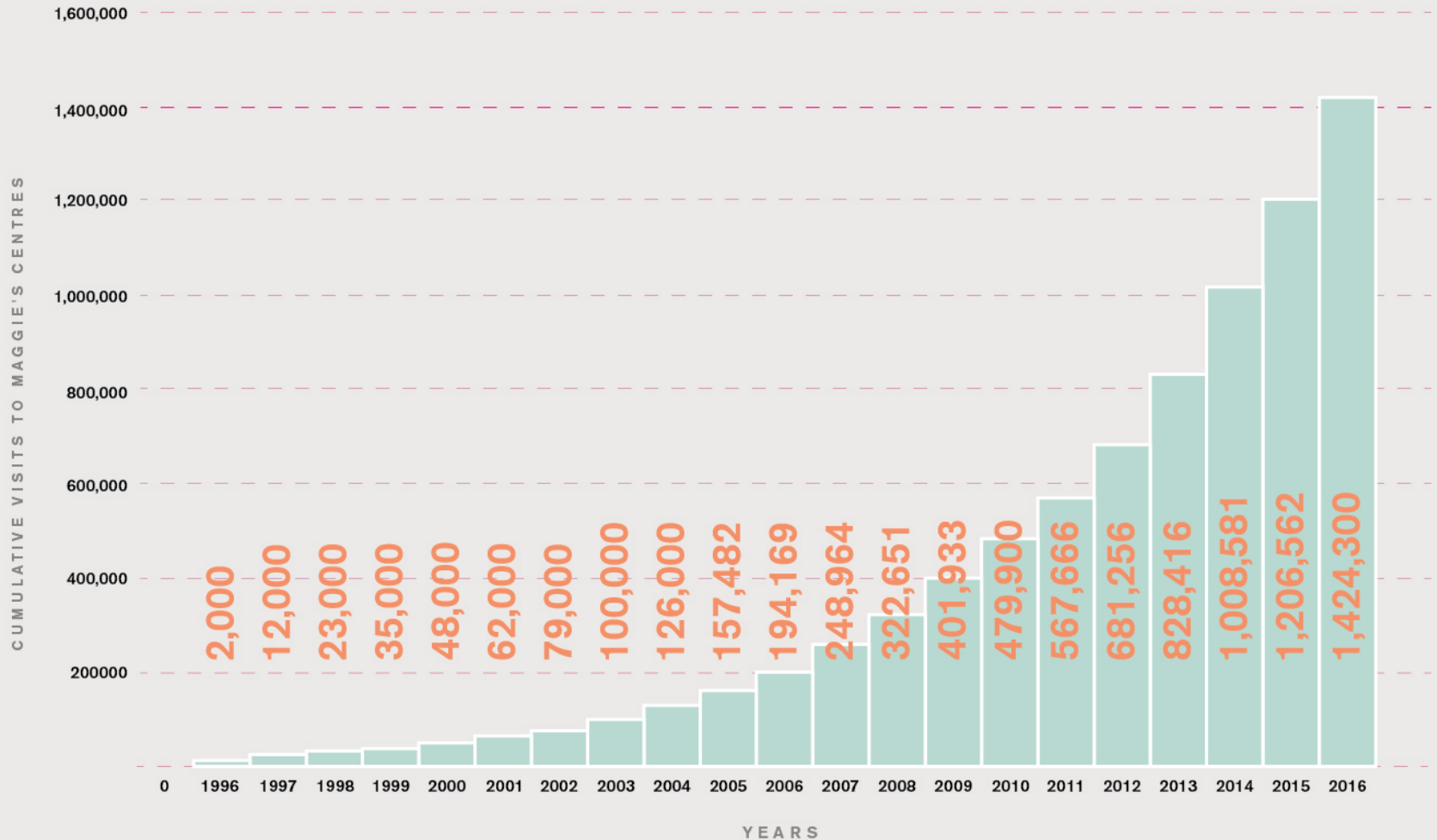

*maggie's*

# Maggie's Visitors

When they visited in their cancer journey

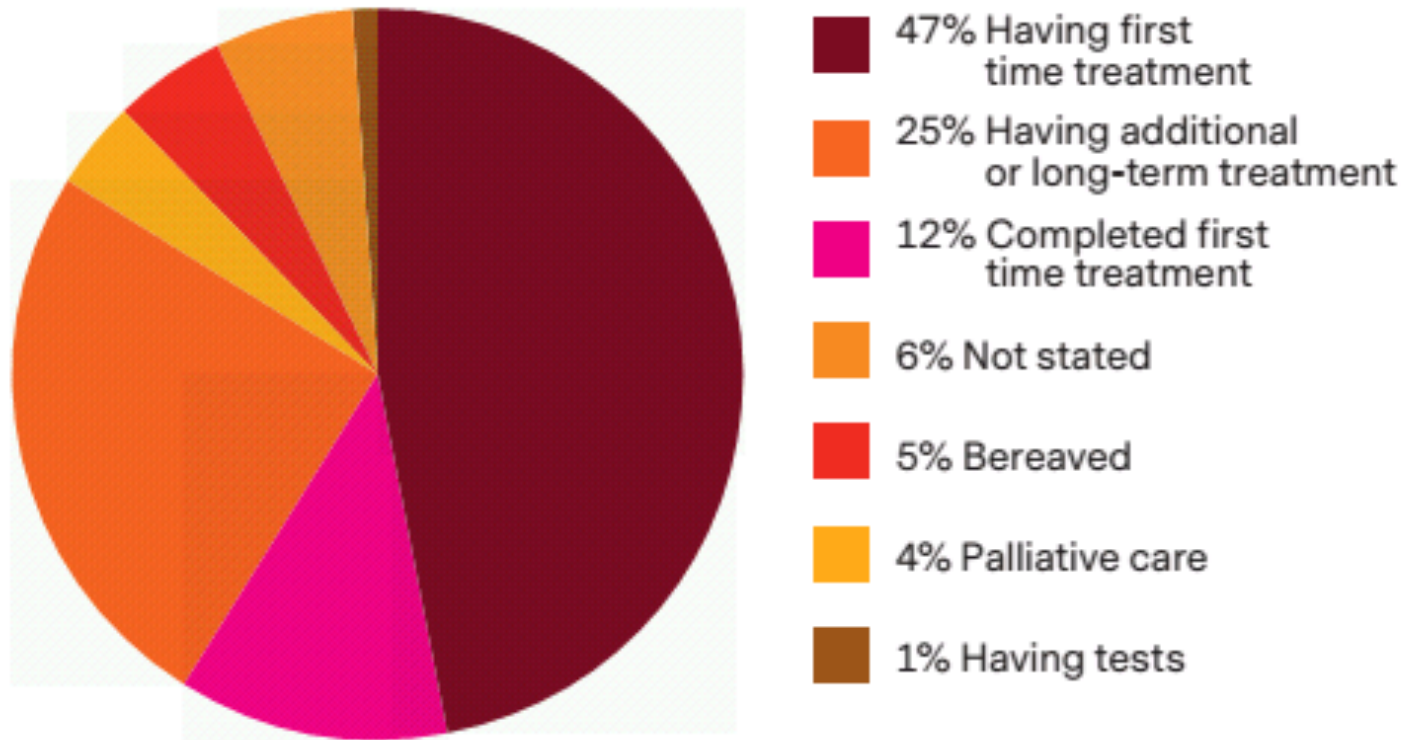

## Making a difference

One in two people are expected to get cancer in their lifetime

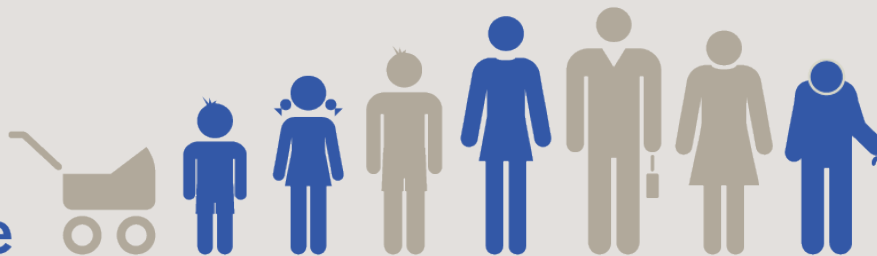

There for **everyone**, at **any stage**, with **any kind of cancer**

**100%**



of our visitors said **their experience was good or excellent**

**94%**



of people said **Maggie's helped them feel less alone**

**87%**



of people said **Maggie's helped them to cope with stress**

**Growing** the number of people we support year on year:



*maggie's*

# Growing with the need

- Operational Maggie's
- Planned Maggie's
- Maggie's in development
- NHS sites to approach
- Existing support Centres on NHS sites



## Greater London



# Strategic Ambitions

- To build Centres within each of the UK's 61 NHS Cancer Networks where needed.
- To grow from 20 Centres to 30 by 2020 including St Bart's, Royal Marsden, Southampton General Hospital.
- To raise £20 million of revenue income and a further £53 million of capital to develop new Centres.
- To increase our reach to 80,000 new people every year.

**“You have been a lighthouse for me during the dark days”**

**Maggie’s Centre Visitor**







**“The whole building enveloped me in love. It’s bright, it’s light and the first thing you do is smile.”** Trudy, Maggie’s Dundee Centre visitor

# Thank you

*maggie's*