



ROYAL COLLEGE OF PHYSICIANS LONDON | 11-14 JUNE 2017
**EUROPEAN
HEALTHCARE DESIGN**
RESEARCH • POLICY • PRACTICE



Director
Architecture / Healthcare



Senior Interior Designer
Interior Design / Healthcare



a specialist children's hospital
with play at its heart
and art in its soul

Sheffield
Children's
Hospital



**The
Children's
Hospital
Charity***

Sheffield Children's **NHS**
NHS Foundation Trust

Artfelt
making hospital
feel better



morag myerscough



deanestor
furniture solutions

AVANTI
ARCHITECTS

- Location: Sheffield, South Yorkshire, UK
- Addition to existing NHS hospital / refurbishment of existing NHS hospital
- One of four NHS Trusts in the UK that provide care solely for children.
- 150 inpatient beds
- a new main entrance, an outpatient department, and 3 wards
- 72 beds in a mixture of single bedrooms and 4 bed bays
- Project won via design competition

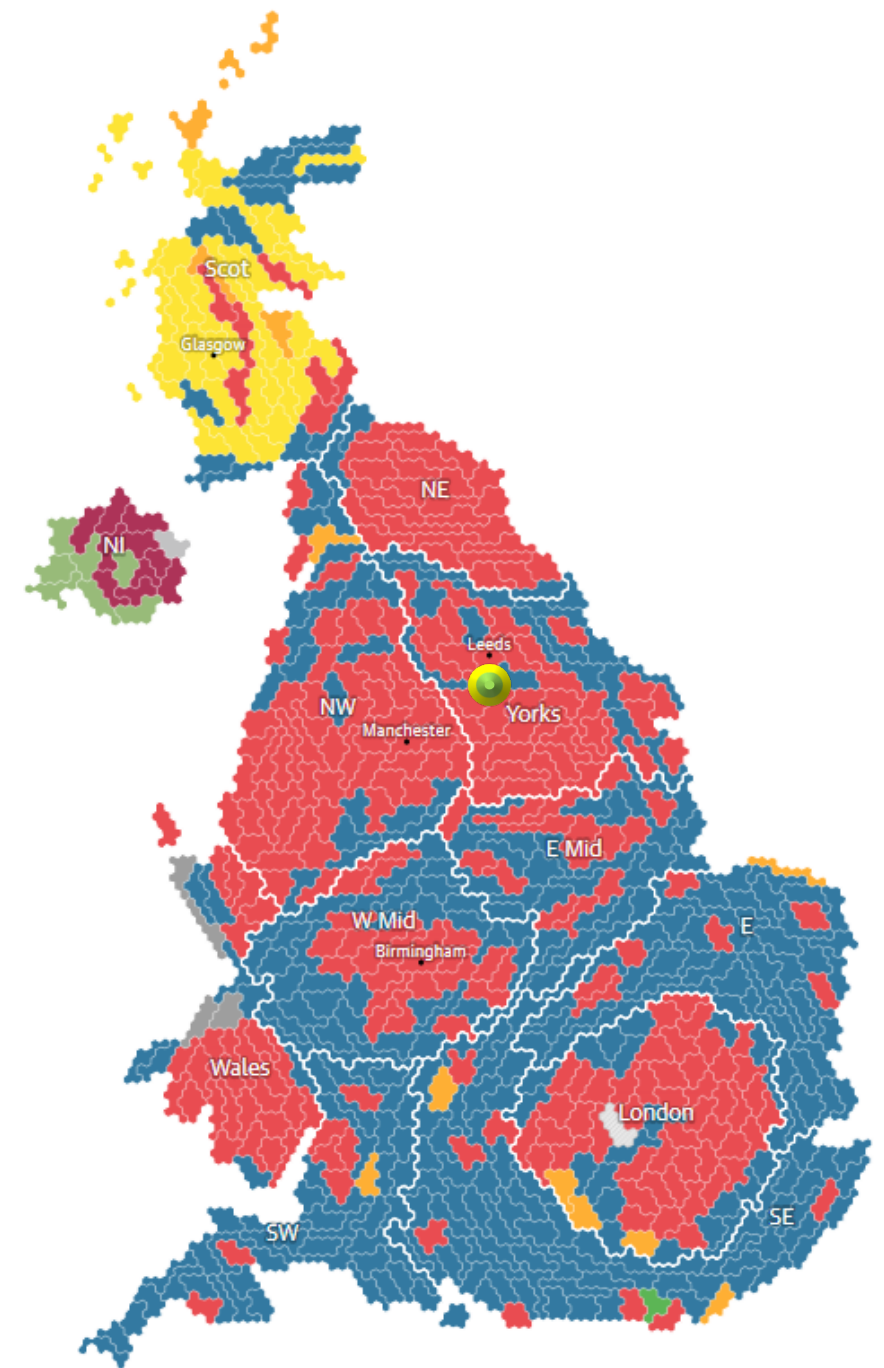



Sheffield: site zones

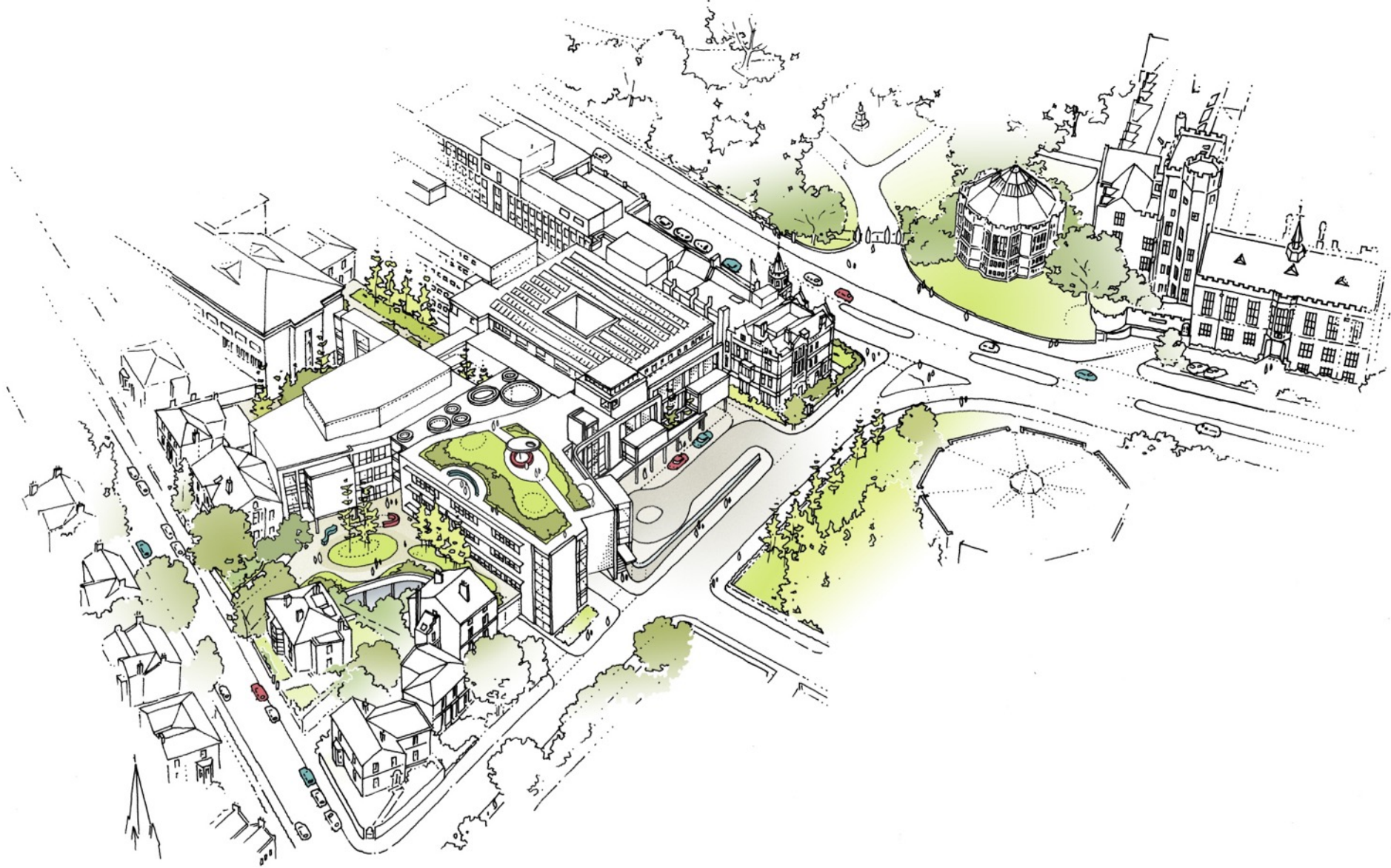

Sheffield: urban context

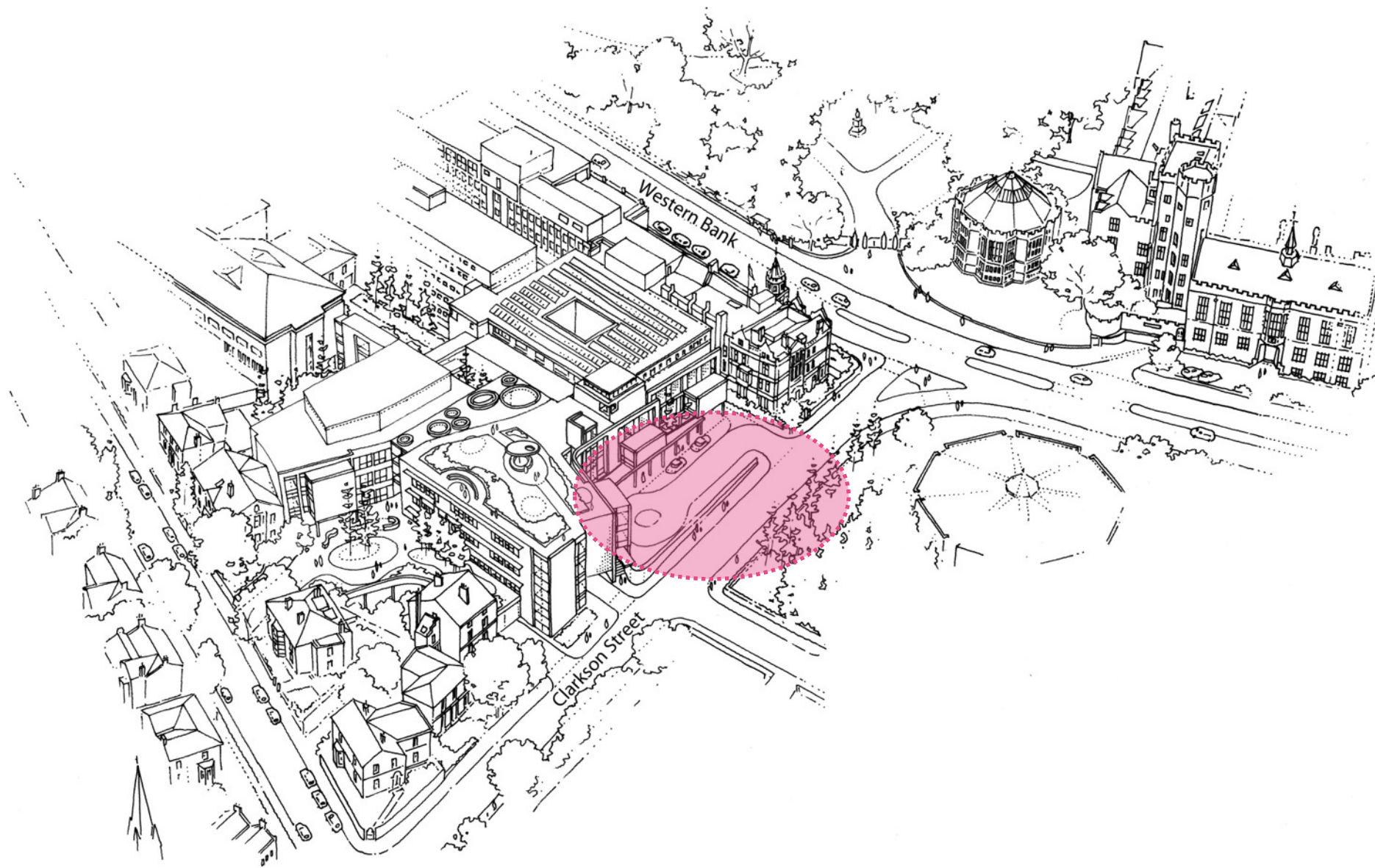

Sheffield: urban context **New main entrance**

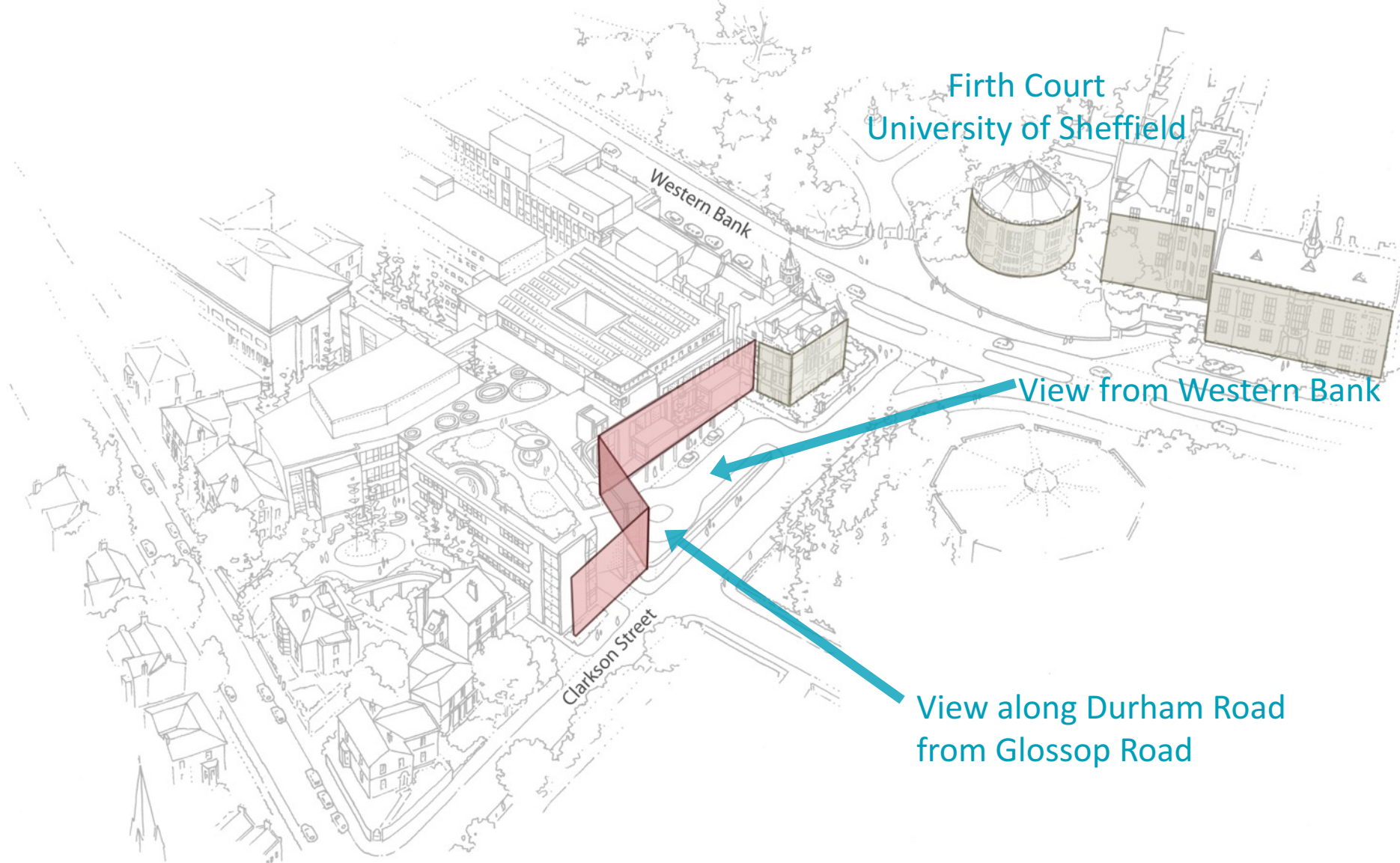

Sheffield: urban context **New main entrance**



Northumberland Road Conservation Area

Sheffield: urban context Conservation Area

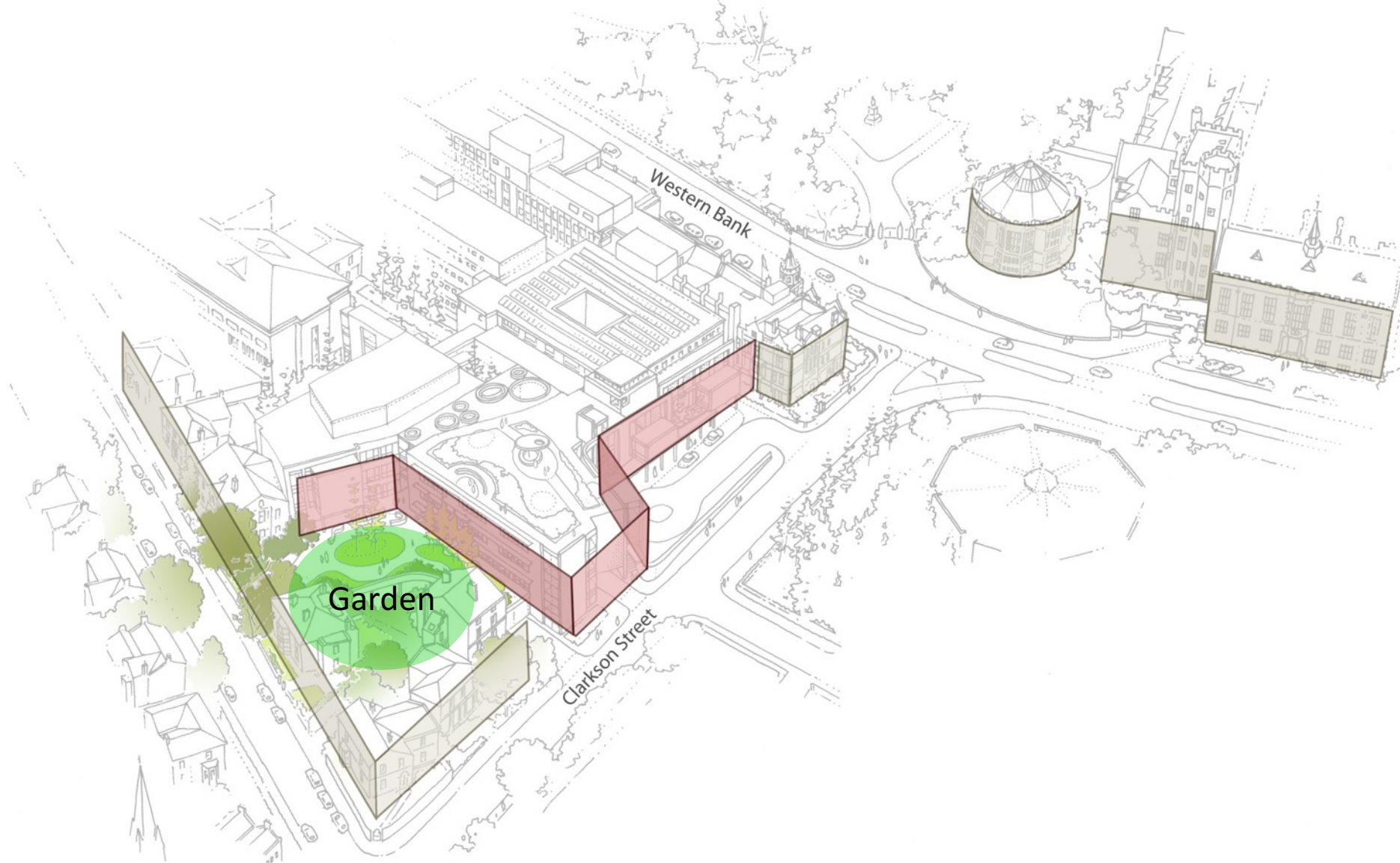

Sheffield: urban context Conservation Area

Public Access to other departments

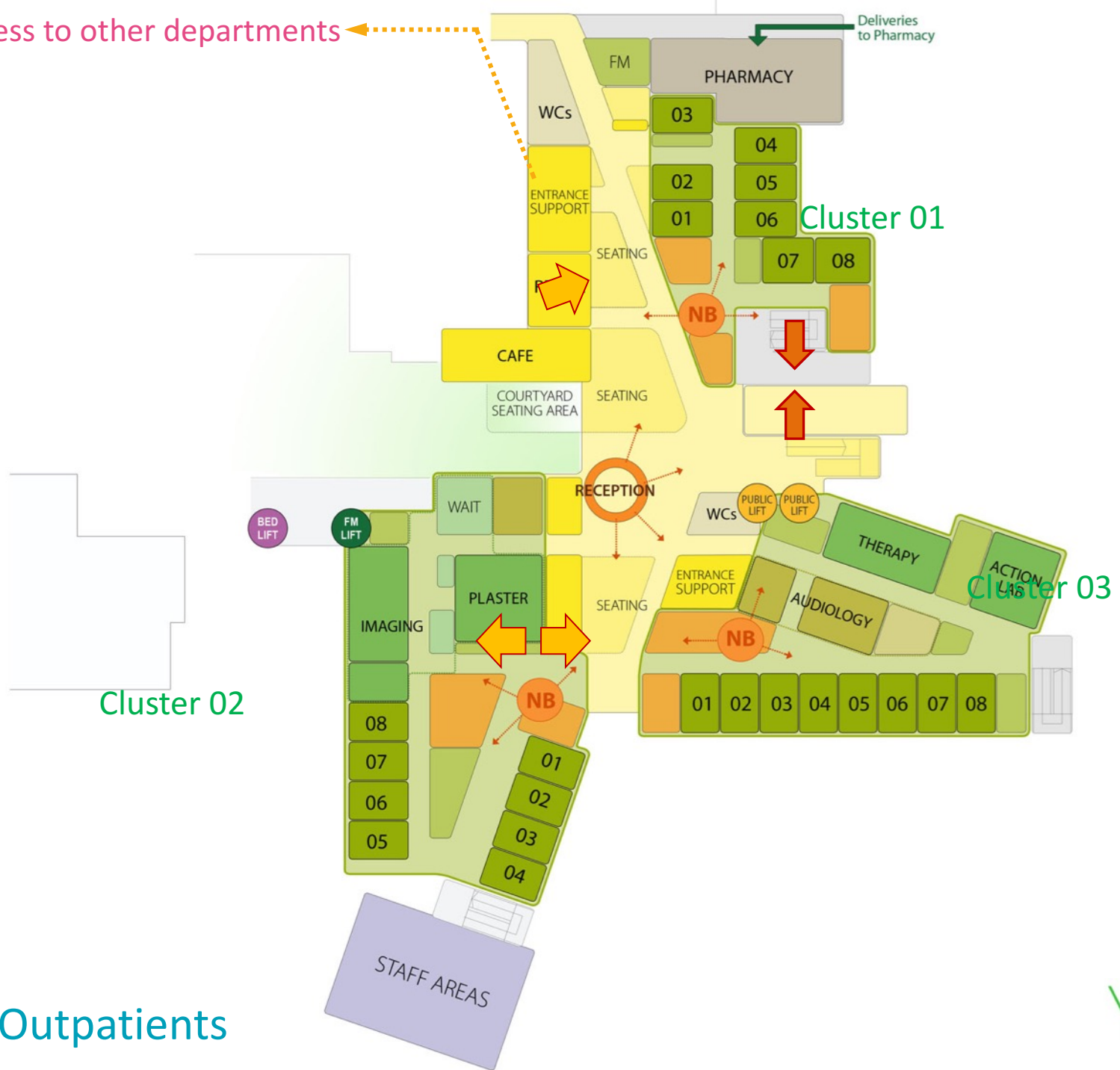

Sheffield: Level A - Outpatients

Ward 2

12-bed cluster

12-bed cluster

Ward 1

12-bed cluster

12-bed cluster



- Standardised rooms
- Daylight and views
- Observation
- Patient Safety
- Fire escape

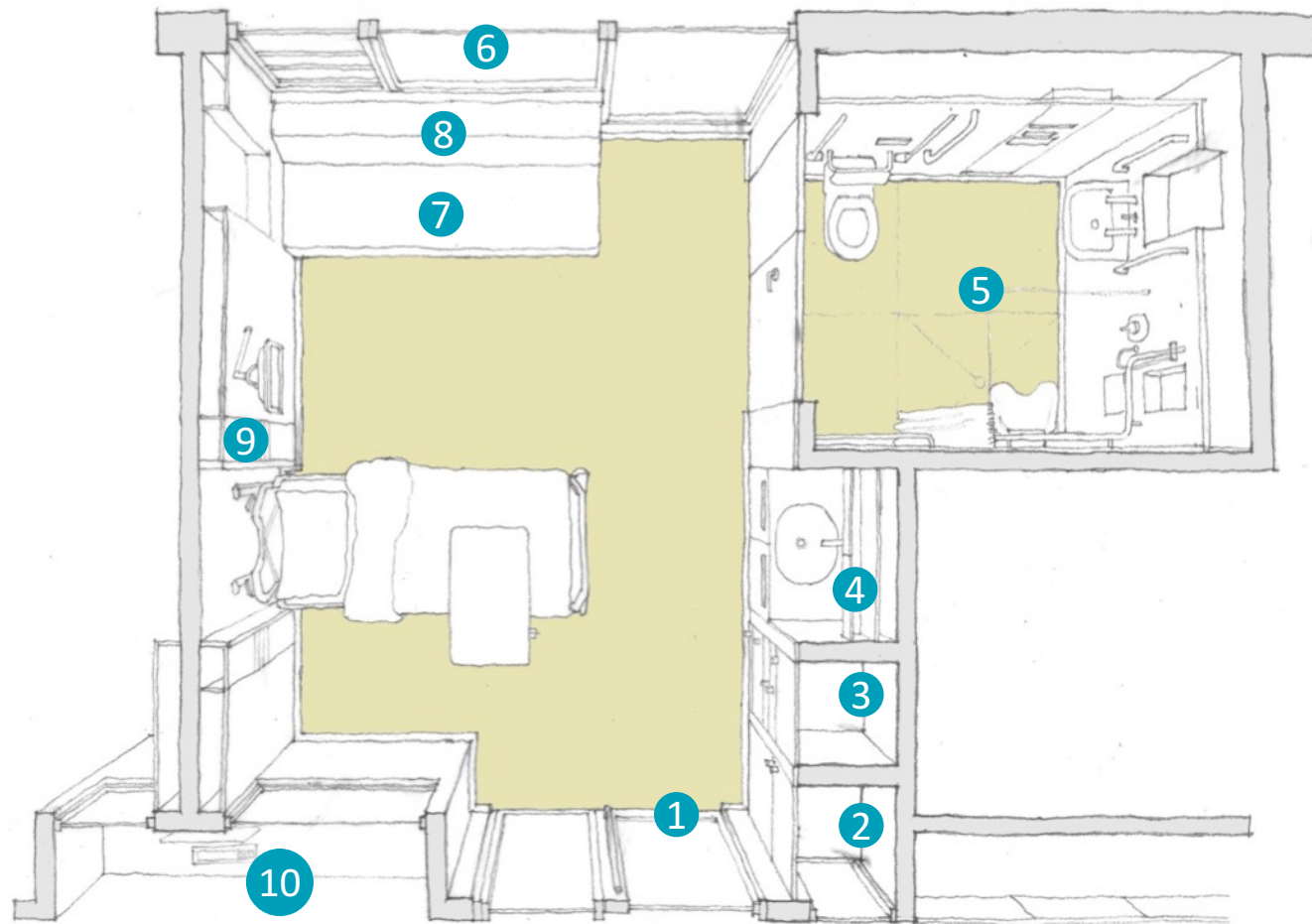

- 1 Glazed doors with privacy option
- 2 Pass-through cupboard
- 3 Patient wardrobe
- 4 Clinical station
- 5 Fully accessible en-suite
- 6 Daylight, views, ventilation
- 7 Day bed
- 8 Removeable cushion creates relative's bed
- 9 Bedhead services
- 10 Touch down base with clear view of patients

Sheffield: single bedroom concept

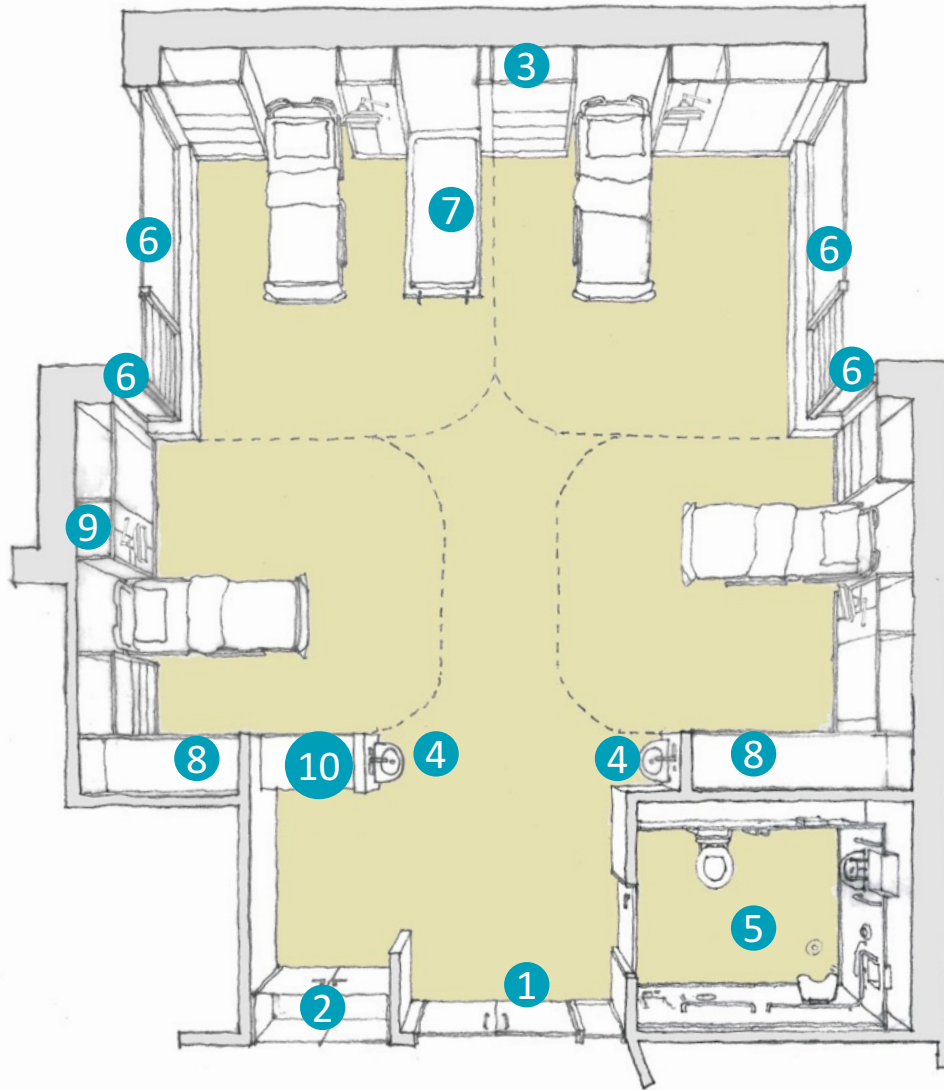

- 1 Glazed doors with privacy option
- 2 Pass-through cupboard
- 3 Patient wardrobe
- 4 Clinical station
- 5 Fully accessible en-suite
- 6 Daylight, views, ventilation
- 7 Relative's foldaway bed
- 8 Cupboard
- 9 Bedhead services
- 10 Touch down base with clear view of patients

Sheffield: 4 bed room concept



















“Being in hospital is a difficult time for children. So if we can distract them with toys, games, stimulating environments and interesting elements within the hospital itself then they’ll take away better happier memories.”



“Part of my role involves ensuring patients are offered fun, yet challenging activities and resources on the ward. In-patients staying long term may require rehabilitation and also changes of environment.”









“Although the rooms are for children I didn’t want them to be childish because children of all different age groups will be staying in them. I also wanted to create somewhere parents would be happy to spend time too. It was just about making a bedroom that you felt good to be in.”



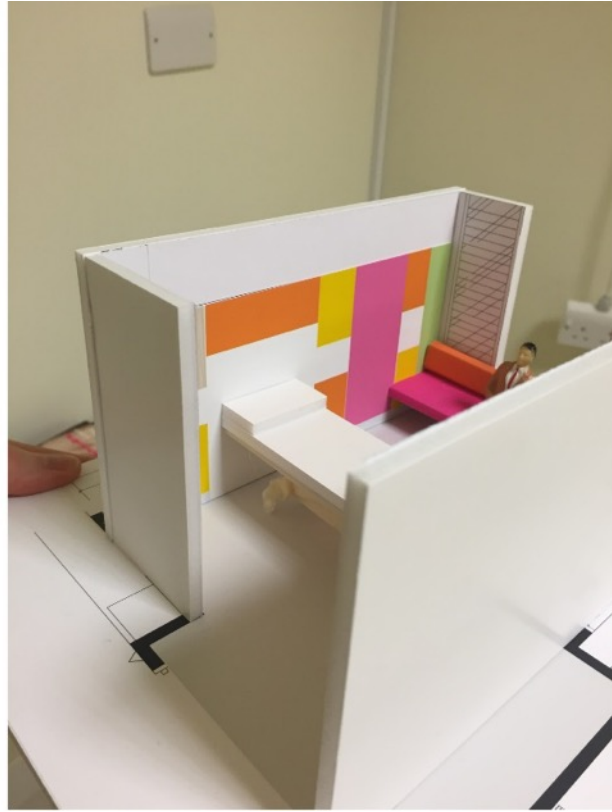

Room 1 ref MMS1 (Wall Finishes Plans ...G333-P105-P107)

Colours from Formica Colors range except where noted as Polyrey

- Monaco K1871 MAT
- Chrome Yellow F1485 MAT
- Sun F4155 MAT
- (Polyrey) Lagon L026
- Lemon F8755 MAT
- Juicy Pink F0232 MAT
- Manitoba Maple K7555

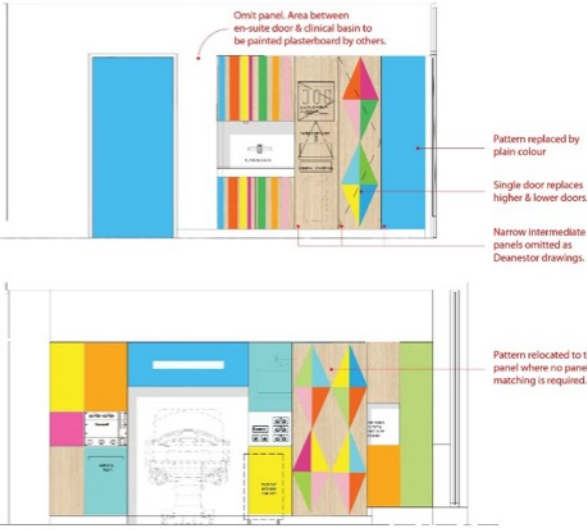

SHEFFIELD CHILDRENS HOSPITAL - Bedroom Artwork by Morag Myerscough

11062-SK-531 Issued: 29.07.2015 Rev. A: 30.07.2015 Rev. B: 05.08.2015

AVANTI ARCHITECTS

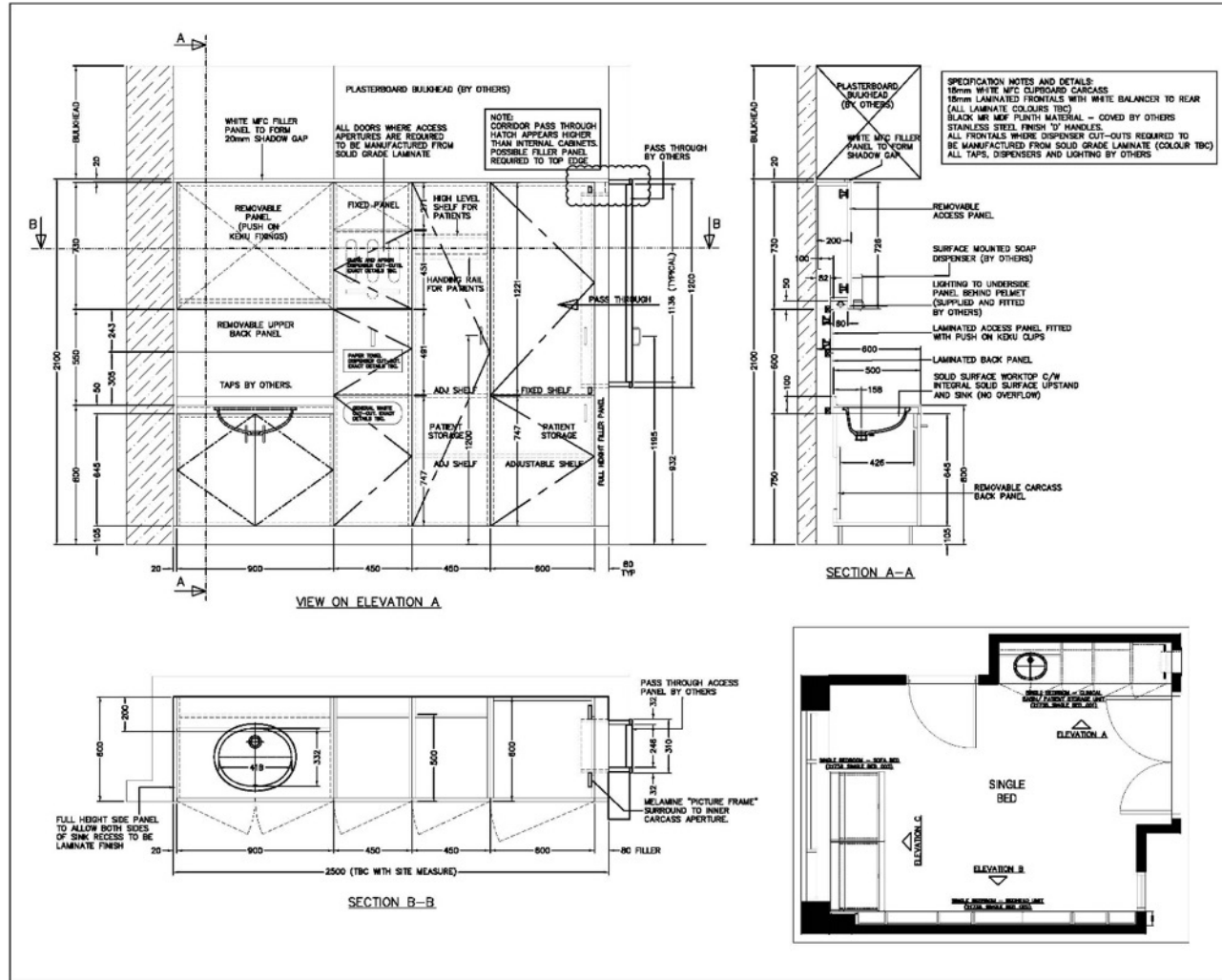

General Notes

NOTES
All items will be in manageable size to suit site conditions and of acceptable weight and handling and take precedence over other requirements

NOTES
THIS DRAWING IS NOT TO BE USED FOR GENERAL CONSTRUCTION PURPOSES ONLY BY SUBMITTALS

GENERAL INFORMATION

These drawings are intended as a visual aid and are NOT to be used for construction. They are the property of Deaneator Ltd and may not be copied, reproduced, stored or in part without the written permission of Deaneator Ltd

C	10.09.15	REVISED TO COMMENTS
B	21.08.15	UNIT MONTHS CHANGED
A	12.08.15	REVISED TO COMMENTS
REV	DATE	COMMENTS



Drawing Title
CHILDRENS HOSPITAL, SHEFFIELD
SINGLE BEDROOM CLINICAL
BASIN/PATIENT STORAGE UNIT
LAYOUT DETAILS

Drawn: RK Scale: 1:50 (2015) Scale: 1:50 (W/A)
Approved: [Signature] Date:

Drawing Number: 21738_SINGLE BED_001 Rev: C





Elevation B

KEY

- (B1) BRICK BLOCKWORK (F10 F12)
- (B2) STATUE BRICK PANEL (F10 F12)
- (B3) OPEN LATTICE BLOCKWORK (F10 F12)
- (B4) RECESSED BRICKWORK (F10 F12)
- (B5) BRICK SLIP GLAZING SYSTEM (F10 F12 and H01 H02)
- (C01) CURTAIN WALL TYPE 1 (Refer to G01 elevation)
- (C02) CURTAIN WALL TYPE 2 (Refer to G01 elevation)
- (C03) CURTAIN WALL TYPE 3 (Refer to G01 elevation)
- (C04) CURTAIN WALL TYPE 4 (Refer to G01 elevation)
- (C05) CURTAIN WALL TYPE 5 (Refer to G01 elevation)
- (C06) STANDARD WINDOW TYPE A/A (Refer to G01 elevation)
- (C07) STANDARD WINDOW TYPE B/B (Refer to G01 elevation)
- (C08) STANDARD WINDOW TYPE A/A (Refer to G01 elevation)
- (C09) STANDARD WINDOW TYPE A/A (Refer to G01 elevation)
- (C10) STANDARD WINDOW TYPE A/A (Refer to G01 elevation)
- (C11) STANDARD WINDOW TYPE A/A (Refer to G01 elevation)
- (C12) STANDARD WINDOW TYPE A/A (Refer to G01 elevation)
- (C13) STANDARD WINDOW TYPE A/A (Refer to G01 elevation)
- (C14) STANDARD WINDOW TYPE A/A (Refer to G01 elevation)
- (C15) STANDARD WINDOW TYPE A/A (Refer to G01 elevation)
- (C16) STANDARD WINDOW TYPE A/A (Refer to G01 elevation)
- (C17) STANDARD WINDOW TYPE A/A (Refer to G01 elevation)
- (C18) STANDARD WINDOW TYPE A/A (Refer to G01 elevation)
- (C19) STANDARD WINDOW TYPE A/A (Refer to G01 elevation)
- (C20) STANDARD WINDOW TYPE A/A (Refer to G01 elevation)
- (C21) STANDARD WINDOW TYPE A/A (Refer to G01 elevation)
- (C22) STANDARD WINDOW TYPE A/A (Refer to G01 elevation)
- (C23) STANDARD WINDOW TYPE A/A (Refer to G01 elevation)
- (C24) STANDARD WINDOW TYPE A/A (Refer to G01 elevation)
- (C25) STANDARD WINDOW TYPE A/A (Refer to G01 elevation)
- (C26) STANDARD WINDOW TYPE A/A (Refer to G01 elevation)
- (C27) STANDARD WINDOW TYPE A/A (Refer to G01 elevation)
- (C28) STANDARD WINDOW TYPE A/A (Refer to G01 elevation)
- (C29) STANDARD WINDOW TYPE A/A (Refer to G01 elevation)
- (C30) STANDARD WINDOW TYPE A/A (Refer to G01 elevation)
- (C31) STANDARD WINDOW TYPE A/A (Refer to G01 elevation)
- (C32) STANDARD WINDOW TYPE A/A (Refer to G01 elevation)
- (C33) STANDARD WINDOW TYPE A/A (Refer to G01 elevation)
- (C34) STANDARD WINDOW TYPE A/A (Refer to G01 elevation)
- (C35) STANDARD WINDOW TYPE A/A (Refer to G01 elevation)
- (C36) STANDARD WINDOW TYPE A/A (Refer to G01 elevation)
- (C37) STANDARD WINDOW TYPE A/A (Refer to G01 elevation)
- (C38) STANDARD WINDOW TYPE A/A (Refer to G01 elevation)
- (C39) STANDARD WINDOW TYPE A/A (Refer to G01 elevation)
- (C40) STANDARD WINDOW TYPE A/A (Refer to G01 elevation)
- (C41) STANDARD WINDOW TYPE A/A (Refer to G01 elevation)
- (C42) STANDARD WINDOW TYPE A/A (Refer to G01 elevation)
- (C43) STANDARD WINDOW TYPE A/A (Refer to G01 elevation)
- (C44) STANDARD WINDOW TYPE A/A (Refer to G01 elevation)
- (C45) STANDARD WINDOW TYPE A/A (Refer to G01 elevation)
- (C46) STANDARD WINDOW TYPE A/A (Refer to G01 elevation)
- (C47) STANDARD WINDOW TYPE A/A (Refer to G01 elevation)
- (C48) STANDARD WINDOW TYPE A/A (Refer to G01 elevation)
- (C49) STANDARD WINDOW TYPE A/A (Refer to G01 elevation)
- (C50) STANDARD WINDOW TYPE A/A (Refer to G01 elevation)
- (C51) STANDARD WINDOW TYPE A/A (Refer to G01 elevation)
- (C52) STANDARD WINDOW TYPE A/A (Refer to G01 elevation)
- (C53) STANDARD WINDOW TYPE A/A (Refer to G01 elevation)
- (C54) STANDARD WINDOW TYPE A/A (Refer to G01 elevation)
- (C55) STANDARD WINDOW TYPE A/A (Refer to G01 elevation)
- (C56) STANDARD WINDOW TYPE A/A (Refer to G01 elevation)
- (C57) STANDARD WINDOW TYPE A/A (Refer to G01 elevation)
- (C58) STANDARD WINDOW TYPE A/A (Refer to G01 elevation)
- (C59) STANDARD WINDOW TYPE A/A (Refer to G01 elevation)
- (C60) STANDARD WINDOW TYPE A/A (Refer to G01 elevation)
- (C61) STANDARD WINDOW TYPE A/A (Refer to G01 elevation)
- (C62) STANDARD WINDOW TYPE A/A (Refer to G01 elevation)
- (C63) STANDARD WINDOW TYPE A/A (Refer to G01 elevation)
- (C64) STANDARD WINDOW TYPE A/A (Refer to G01 elevation)
- (C65) STANDARD WINDOW TYPE A/A (Refer to G01 elevation)
- (C66) STANDARD WINDOW TYPE A/A (Refer to G01 elevation)
- (C67) STANDARD WINDOW TYPE A/A (Refer to G01 elevation)
- (C68) STANDARD WINDOW TYPE A/A (Refer to G01 elevation)
- (C69) STANDARD WINDOW TYPE A/A (Refer to G01 elevation)
- (C70) STANDARD WINDOW TYPE A/A (Refer to G01 elevation)
- (C71) STANDARD WINDOW TYPE A/A (Refer to G01 elevation)
- (C72) STANDARD WINDOW TYPE A/A (Refer to G01 elevation)
- (C73) STANDARD WINDOW TYPE A/A (Refer to G01 elevation)
- (C74) STANDARD WINDOW TYPE A/A (Refer to G01 elevation)
- (C75) STANDARD WINDOW TYPE A/A (Refer to G01 elevation)
- (C76) STANDARD WINDOW TYPE A/A (Refer to G01 elevation)
- (C77) STANDARD WINDOW TYPE A/A (Refer to G01 elevation)
- (C78) STANDARD WINDOW TYPE A/A (Refer to G01 elevation)
- (C79) STANDARD WINDOW TYPE A/A (Refer to G01 elevation)
- (C80) STANDARD WINDOW TYPE A/A (Refer to G01 elevation)
- (C81) STANDARD WINDOW TYPE A/A (Refer to G01 elevation)
- (C82) STANDARD WINDOW TYPE A/A (Refer to G01 elevation)
- (C83) STANDARD WINDOW TYPE A/A (Refer to G01 elevation)
- (C84) STANDARD WINDOW TYPE A/A (Refer to G01 elevation)
- (C85) STANDARD WINDOW TYPE A/A (Refer to G01 elevation)
- (C86) STANDARD WINDOW TYPE A/A (Refer to G01 elevation)
- (C87) STANDARD WINDOW TYPE A/A (Refer to G01 elevation)
- (C88) STANDARD WINDOW TYPE A/A (Refer to G01 elevation)
- (C89) STANDARD WINDOW TYPE A/A (Refer to G01 elevation)
- (C90) STANDARD WINDOW TYPE A/A (Refer to G01 elevation)
- (C91) STANDARD WINDOW TYPE A/A (Refer to G01 elevation)
- (C92) STANDARD WINDOW TYPE A/A (Refer to G01 elevation)
- (C93) STANDARD WINDOW TYPE A/A (Refer to G01 elevation)
- (C94) STANDARD WINDOW TYPE A/A (Refer to G01 elevation)
- (C95) STANDARD WINDOW TYPE A/A (Refer to G01 elevation)
- (C96) STANDARD WINDOW TYPE A/A (Refer to G01 elevation)
- (C97) STANDARD WINDOW TYPE A/A (Refer to G01 elevation)
- (C98) STANDARD WINDOW TYPE A/A (Refer to G01 elevation)
- (C99) STANDARD WINDOW TYPE A/A (Refer to G01 elevation)
- (C100) STANDARD WINDOW TYPE A/A (Refer to G01 elevation)

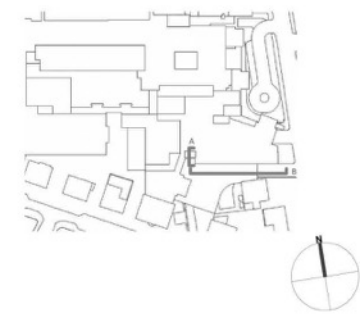

This drawing and design is for use only in connection with the project described below. The drawing and design is the copyright of Avanti Architects Ltd, and must not be re-used, copied, printed or used without written consent. All dimensions and settings are to be checked on site before construction. This drawing is to be used in conjunction with all other information relevant to the project. Any apparent discrepancy is to be brought to the attention of the Architects Ltd. Do not scale from this drawing.

- INTERNAL BLINDS KEY**
- Mystique range
 - MBU - Blue
 - MFA - Fuschia
 - MHP - Hot Pink
 - MLB - Light Blue
 - MLM - Lime
 - MMG - Mint Green
 - MVA - Vanilla
 - Signature range
 - SBK - Black
 - SCM - Cream
 - SFA - Fresh Apple
 - SSB - Sea Blue
 - NB - No Blind

Rev. A 16.06.2016
omit blind 29-A-10

Scale	Size	Date First Issue
NTS	A3	16.10.15
Drawn By	Checked By	
MR	MTR	

Project: The Children's Hospital, Sheffield

Drawing: GA South Elevation - New Build East Wing
INTERNAL BLINDS

Drawing Number: 11062-AA-07-XX-G333-E101
Revision: A

Status: CONSTRUCTION

AVANTI ARCHITECTS

© Avanti Architects Ltd www.avantiarchitects.co.uk
 361, 373 City Road +44 (0) 20 7278 5060
 London EC3V 3AS a@avantiarchitects.co.uk





A colorful children's washroom vanity unit. It features a white sink with a chrome faucet. Above the sink is a mirror with a colorful geometric pattern of triangles in red, pink, green, and blue. To the left of the sink are three wooden cabinets with colorful handles. To the right of the sink are two wooden cabinets with colorful vertical stripes. A small bottle of hand sanitizer is on the counter.

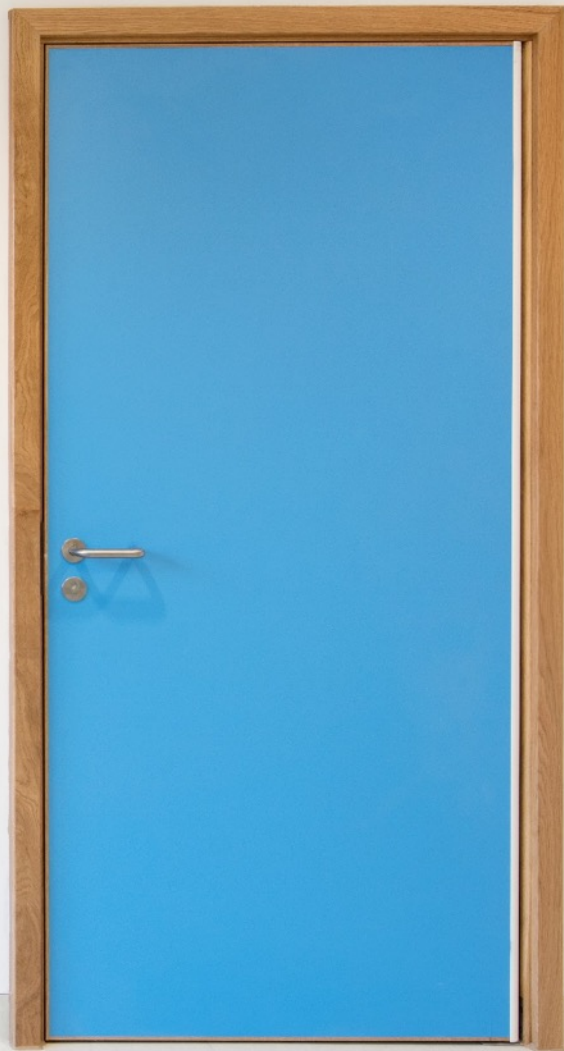







“From the work I’ve done in healthcare I know that it’s phenomenally positive for people to have art in hospitals.... To go into a room that lets you know that people care about you and they’re thinking about you – it’s a no brainer really. It makes people happier and more assured that everyone is concerned about them and wants them to get better.”

It’s an amazing feeling knowing that the rooms will benefit patients at Sheffield Children’s Hospital. I’ve previously done workshops with children in hospitals and you can see how hard it can be for them and their parents. To make an environment that makes a difficult situation even remotely better – I can’t do work that’s more important than that really.”







Thank you

www.avantiarchitects.co.uk

