



POTTER STREET REDEVELOPMENT T

A PARADIGM SHIFT
IN RESIDENTIAL CARE
IN AUSTRALIA

LONDON
JUNE
2016

Image: Martin





POTTER STREET REDEVELOPMENT

T Co- designing
services to
improve quality
and access.

Introduction

***‘.... can have all
the ideas in the
world but the hard
part is getting
them built.’***

Graeme Gibson
DIRECTOR –
Fry Drew Knight and
Creamer Architects
London





POTTER STREET REDEVELOPMENT

Wallara Australia
Specialist disability
support organisation

Needed a development
partner

Needs:

1. Aging Parent /carers can live near to their children
2. Finance the building program by selling part of their land
3. Co-location of two services normally separated





POTTER STREET REDEVELOPMENT

Wallara +
Wintringham

Outcomes:

Wintringham selected as
project partner
Specialist Aged care
organisation – for homeless

1. Designing for wide range of
▪ frailties
2. Homeless aged people co-located with younger people with intellectual disability
3. Management shared between 3 organisations



POTTER STREET REDEVELOPMENT

Wallara +
Wintringham

+ AKA:

Wintringham and AKA worked
together on projects for over
25 years

BSHF UN World Habitat Award
1997

UN HABITAT Scroll of Honour
2011





POTTER STREET REDEVELOPMENT

T AUSTRALIAN CONTEXT

- Separate funding streams for aged care and disability
- Tendency towards “wellbeing” philosophy
- Little variety in building models
- Mostly hotel or apartment style
- Recognition for staff support for residents
- 90 bed typical for new facility
- Just starting to explore multi- storey
- Funded by resident bonds
- Homeless people cannot fund bonds

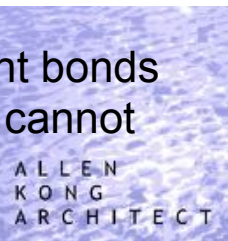















POTTER STREET REDEVELOPMENT

T AUSTRALIAN CONTEXT

- Separate funding streams for aged care and disability
- Tendency towards “wellbeing” philosophy
- Little variety in building models
- Mostly hotel or apartment style
- Recognition for staff support for residents
- 90 bed typical for new facility
- Just starting to explore multi- storey
- Funded by resident bonds
- Homeless people cannot fund bonds

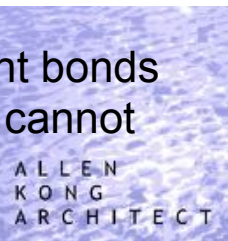

POTTER STREET REDEVELOPMENT



- Climate charts – mild climate – winter nights 4deg . Summer some days 45 deg plus
- Climate change – local predictions fewer rain days and higher rainfall intensity, more extreme events
- Sustainability
- Rain water harvesting

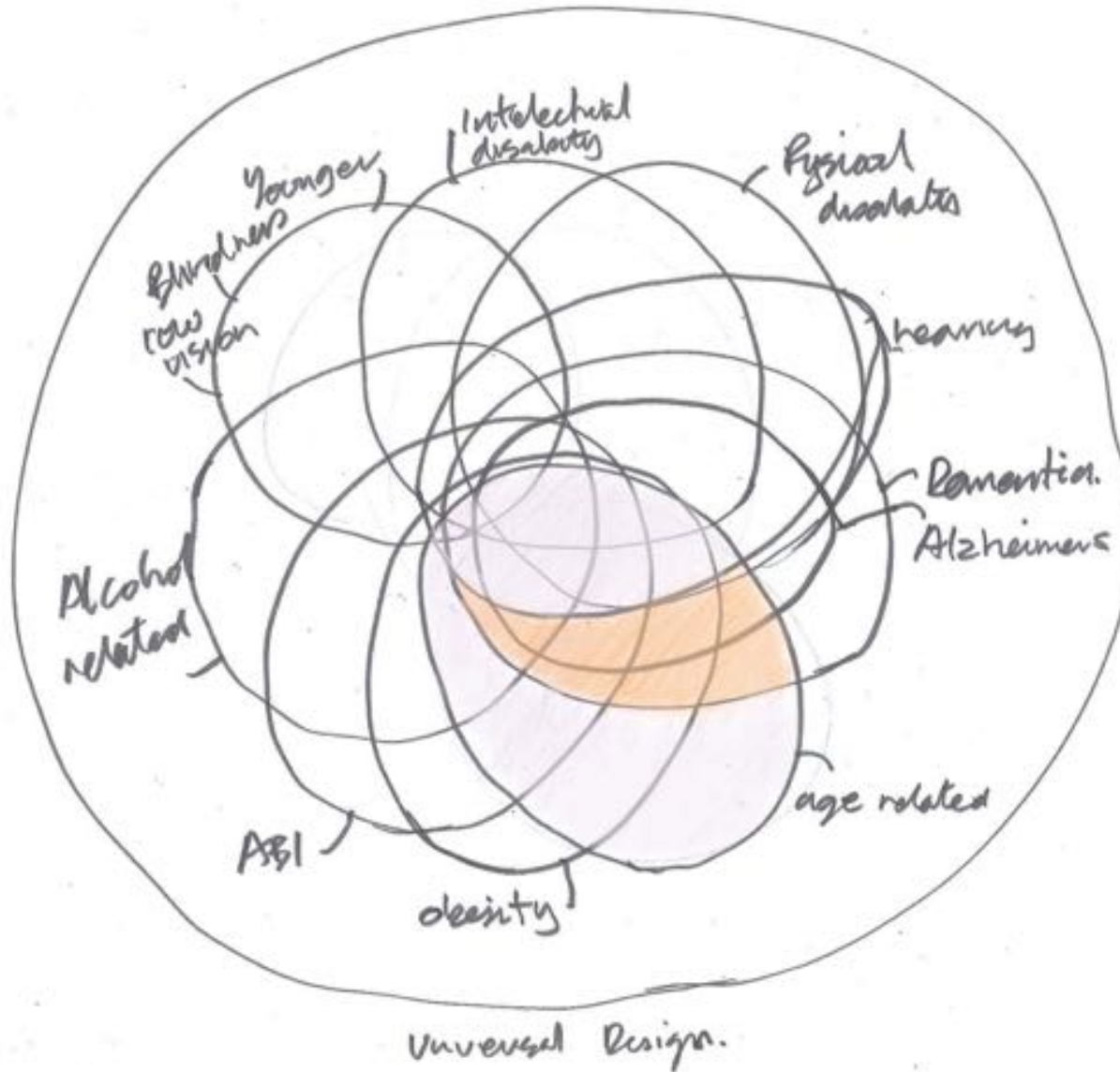

RESEARCH EVIDENCE FOR DESIGN PRINCIPLES INCLUDE:

- Psycho-environmental responses to living in Polar Environments
- Social determinants of health
- Public interface
- Cultural sustainability
- Feng Shui



RESEARCH EVIDENCE FOR DESIGN PRINCIPLES INCLUDE:

- Psycho-environmental responses to living in Polar Environments

Figure 12 Complexity of Support Services Available to People with Complex Care Needs

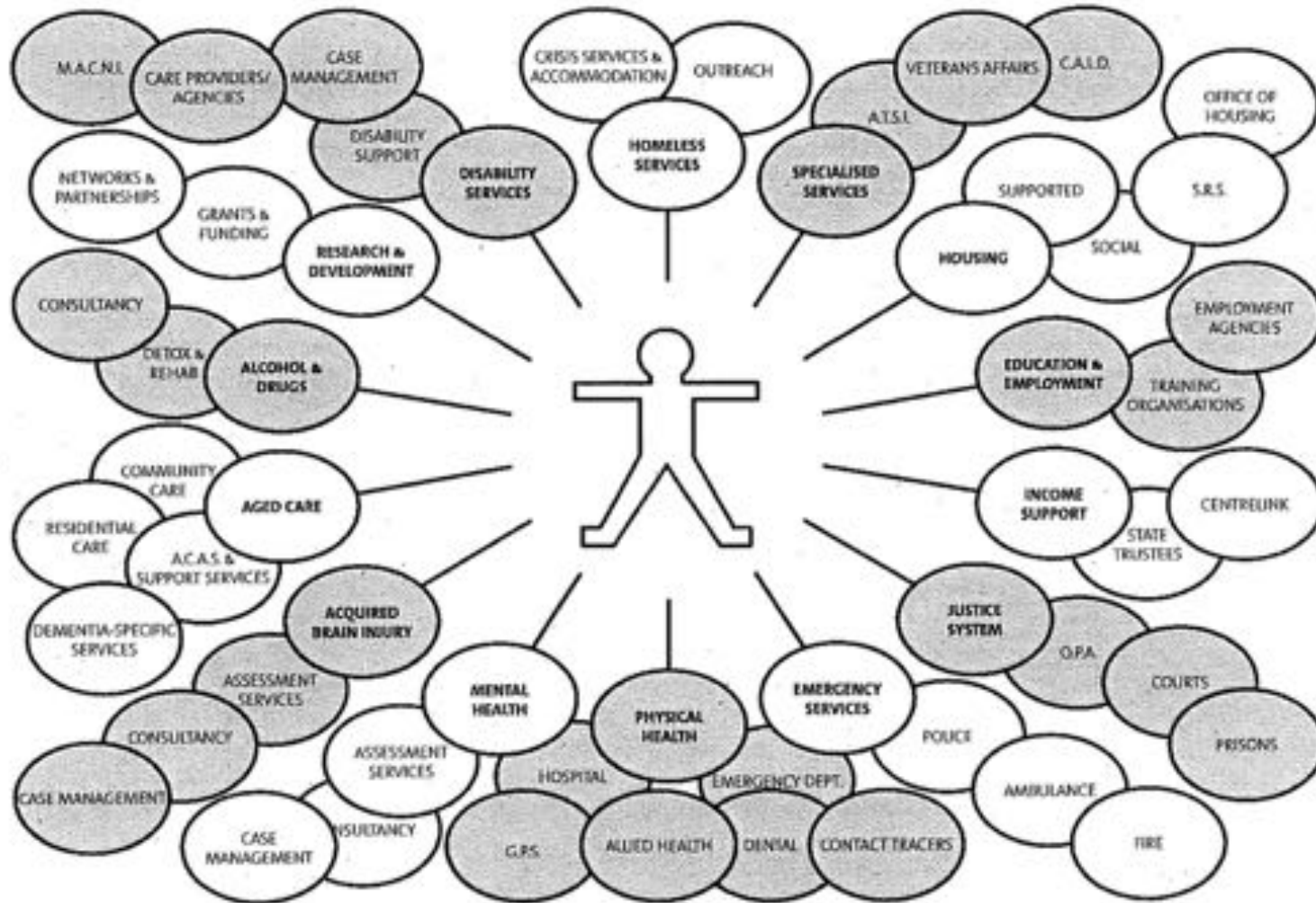

RESEARCH EVIDENCE FOR DESIGN PRINCIPLES INCLUDE:

- Ageing
- Dementia
- Intellectual Disability
- ABI (Acquired Brain Injury)
- Alcohol Induced ABI



Image: Allen
M. Smith

Some risks associated with long term residential accommodations:

- 'Groundhog Day' - lack of environmental stimulation
- 1993 EPA Victoria identified indoor air quality as major risk factor for residents in nursing homes
- Double loaded corridors induce



Some risks associated with long term residential accommodations:

- Difficult wayfinding
- Poor acoustic environment
- Poor natural light
- Poor natural ventilation

Image: Allen





Image: Allen
M. Smith

Some risks associated with long term residential accommodations:

- Lack of access to direct sunshine
- 90% of women and 80% of men in Sydney nursing homes are deficient in Vitamin D
- 25-30% of residents in aged care are depressed



POTTER STREET REDEVELOPMENT

TCo- designing services
to improve quality and
access.

RESIDENT CHARACTERISTICS

Aged Homeless
Younger People with
intellectual disability-

POTTER STREET
PROJECT





Image: Chris

GORDON HOUSE

BUDGET HOTEL





GORDON HOUSE

BUDGET HOTEL

Image: Chris





Image: Chris
Chen

GORDON HOUSE

BUDGET HOTEL





THE GILL NIGHT SHELTER



PAST PROJECTS

Evolution of tested
building, design and
collaboration with
Wintringham

***All circulation
was to be via
verandas-
with out internal
circulation –
Bryan Lipmann
CEO
Wintringham***

Image: Allen
Kong Architect





Evolution of tested
building, design and
collaboration with
Wintringham

WINTRINGHAM, PORT
MELBOURNE
BSHF UN WORLD HABITAT
AWARD 1997

McLEAN LODGE, FLEMINGTON
BSHF UN WORLD HABITAT
AWARD 1994

ATKINS TERRACE
NATIONAL LIFESTYLE FOR
SENIORS AWARD 2000

WINTRINGHAM, RON CONN
NURSING HOME

UN HABITAT SCROLL OF
HONOUR FOR HUMAN
SETTLEMENTS



McLEAN LODGE

35 BED LOW CARE
FACILITY

FINALIST UN WORLD HABITAT
AWARDS 1994

Image: Wintringham





PORT MELBOURNE

35 BED LOW CARE
FACILITY

WINNER UN WORLD HABITAT

AWARDS 1997

WINNER CITY OF PORT PHILLIP
DESIGN AND DEVELOPMENT
AWARD 1997

COMMENDATION ROYAL
AUSTRALIAN INSTITUTE OF
ARCHITECTS MULTI-RESIDENTIAL

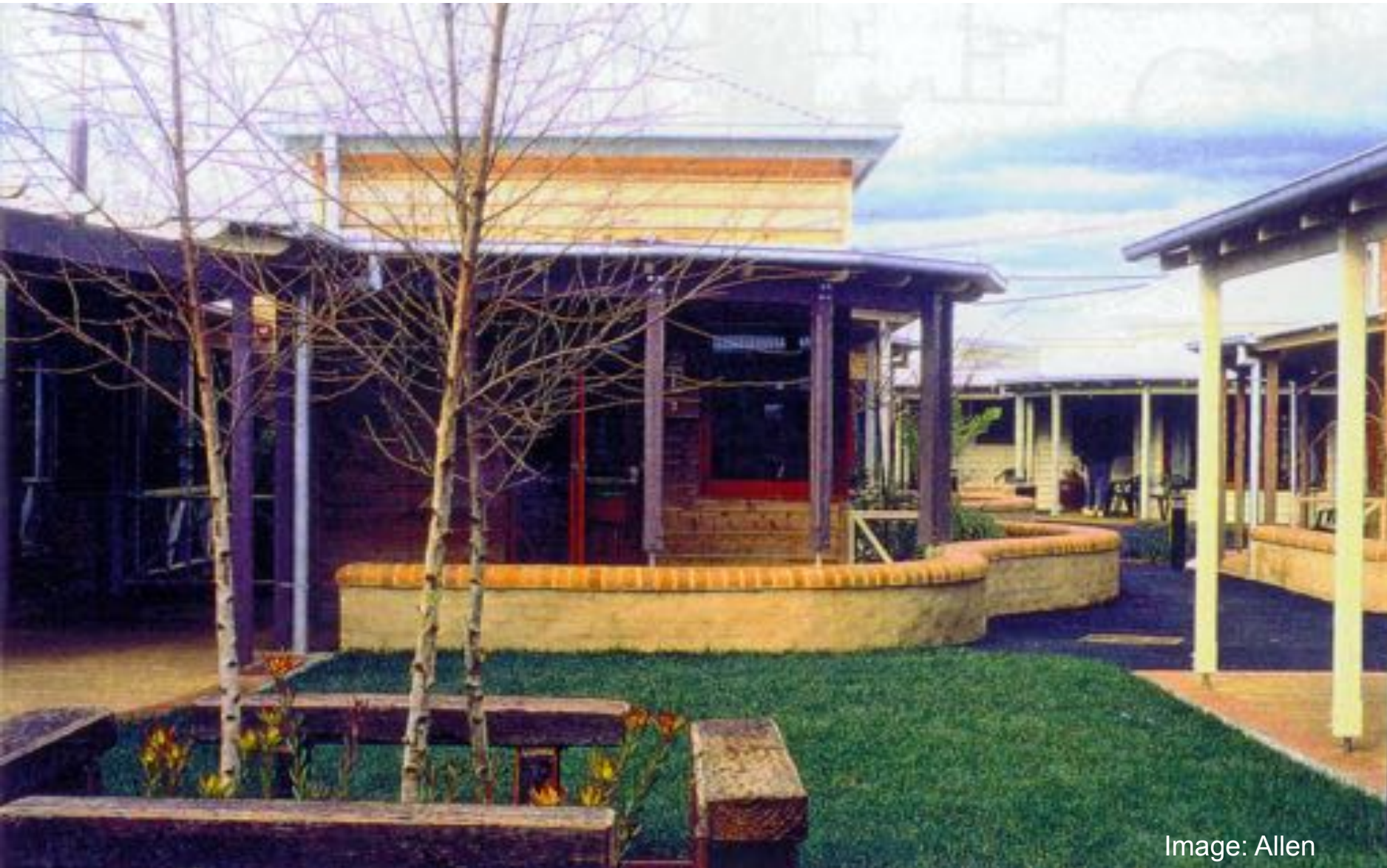

Image: Allen

PORT MELBOURNE

35 BED LOW CARE FACILITY

WINNER UN WORLD HABITAT

AWARDS 1997

WINNER CITY OF PORT PHILLIP
DESIGN AND DEVELOPMENT
AWARD 1997

COMMENDATION ROYAL
AUSTRALIAN INSTITUTE OF
ARCHITECTS MULTI-RESIDENTIAL





POTTER STREET

WINTRINGHAM
60 BED AGED CARE
FACILITY

WALLARA
12 BED ACCESSIBLE
CARE FACILITY
3 INDEPENDENT LIVING
UNITS

Image: Martin





POTTER STREET

EXISTING SITE
CONDITIONS





POTTER STREET

EXISTING SITE
CONDITIONS
Potter Street

POTTER STREET

EXISTING SITE
CONDITIONS
Potter Street



Image: Allen



POTTER STREET

EXISTING SITE CONDITIONS

North East to John
Hemmings Memorial Park



POTTER STREET

EXISTING SITE CONDITIONS

North East to John
Hemmings Memorial Park



Image: Allen
Kerr Architect



POTTER STREET

EXISTING SITE
CONDITIONS
Close Avenue

POTTER STREET

EXISTING SITE
CONDITIONS
Close Avenue



Image: Allen
K. Architect



POTTER STREET

SITE PLANNING

1. Interconnected
2. Able to see where you need to go
3. Communal spaces central
4. Staff Central
5. Spaces with clearly different character
6. Multiple cueing assists way finding



POTTER STREET

SITE PLANNING

1. Interconnected
2. Able to see where you need to go
3. Communal spaces central
4. Staff Central
5. Spaces with clearly different character
6. Multiple cueing assists way finding



POTTER STREET

SITE PLANNING

1. Interconnected
2. Able to see where you need to go
3. Communal spaces central
4. Staff Central
5. Spaces with clearly different character
6. Multiple cueing assists way finding



POTTER STREET

SITE PLANNING

1. Interconnected
2. Able to see where you need to go
3. Communal spaces central
4. Staff Central
5. Spaces with clearly different character
6. Multiple cueing assists way finding

POTTER STREET

SITE PLANNING

1. Interconnected
2. Able to see where you need to go
3. Communal spaces central
4. Staff Central
5. Spaces with clearly different character
6. Multiple cueing assists way finding



Image: Allen
Kong Architect



POTTER STREET

SITE PLANNING

1. Interconnected
2. Able to see where you need to go
3. Communal spaces central
4. Staff Central
5. Spaces with clearly different character
6. Multiple cueing assists way finding



KEY PRINCIPLES

1. Is it understood?
2. Is it manageable?
3. Is it meaningful?



KEY DESIGN PRINCIPLES

Sustainability Aspects

- Heavily insulated
- Timber structure and cladding
- Screw piles
- Minimal use of concrete
- Large shaded areas
- Winter sun penetration
- Rain water harvested
- Reduced internal areas
- Evaporative cooling



KEY DESIGN PRINCIPLES

1. Residents considered as individuals
2. Positive familiar environment
3. Engender a feeling of control in their environment
4. Small scale - group clusters
5. Daily contact with the outdoors or gardens
6. Flexible and variety of stimulating spaces
7. Provide opportunity for privacy and community
8. Provide gradation of spatial zones; private, semi-private, public
9. Highlight helpful stimuli
10. Reduce unwanted stimuli



KEY DESIGN PRINCIPLES

1. Residents considered as individuals



KEY DESIGN PRINCIPLES

1. Residents considered as individuals
2. Positive familiar environment

KEY DESIGN PRINCIPLES

1. Residents considered as individuals
2. Positive familiar environment
+ Familiar materials
= positive associations



Image: Allen



Image: Allen



KEY DESIGN PRINCIPLES

1. Residents considered as individuals
2. Positive familiar environment
3. Engender a feeling of control in their environment

Image: Allen Kong
Architect





KEY DESIGN PRINCIPLES

1. Residents considered as individuals
2. Positive familiar environment
3. Engender a feeling of control in their environment
4. Small scale - group clusters



KEY DESIGN PRINCIPLES

1. Residents considered as individuals
2. Positive familiar environment
3. Engender a feeling of control in their environment
4. Small scale - group clusters
5. Daily contact with the outdoors or gardens

Image: Martin



KEY DESIGN PRINCIPLES

1. Residents considered as individuals
2. Positive familiar environment
3. Engender a feeling of control in their environment
4. Small scale - group clusters
5. Daily contact with the outdoors or gardens
6. Flexible and variety of stimulating spaces

Image: Martin



KEY DESIGN PRINCIPLES

7. Provide opportunity for privacy and community



Image: Martin

KEY DESIGN PRINCIPLES

8. Provide gradation of spatial zones; private, semi-private, public



PRIVATE

KEY DESIGN PRINCIPLES

8. Provide gradation of spatial zones; private, semi-private, public



SEMI-PRIVATE

KEY DESIGN PRINCIPLES

8. Provide gradation of spatial zones; private, semi-private, public

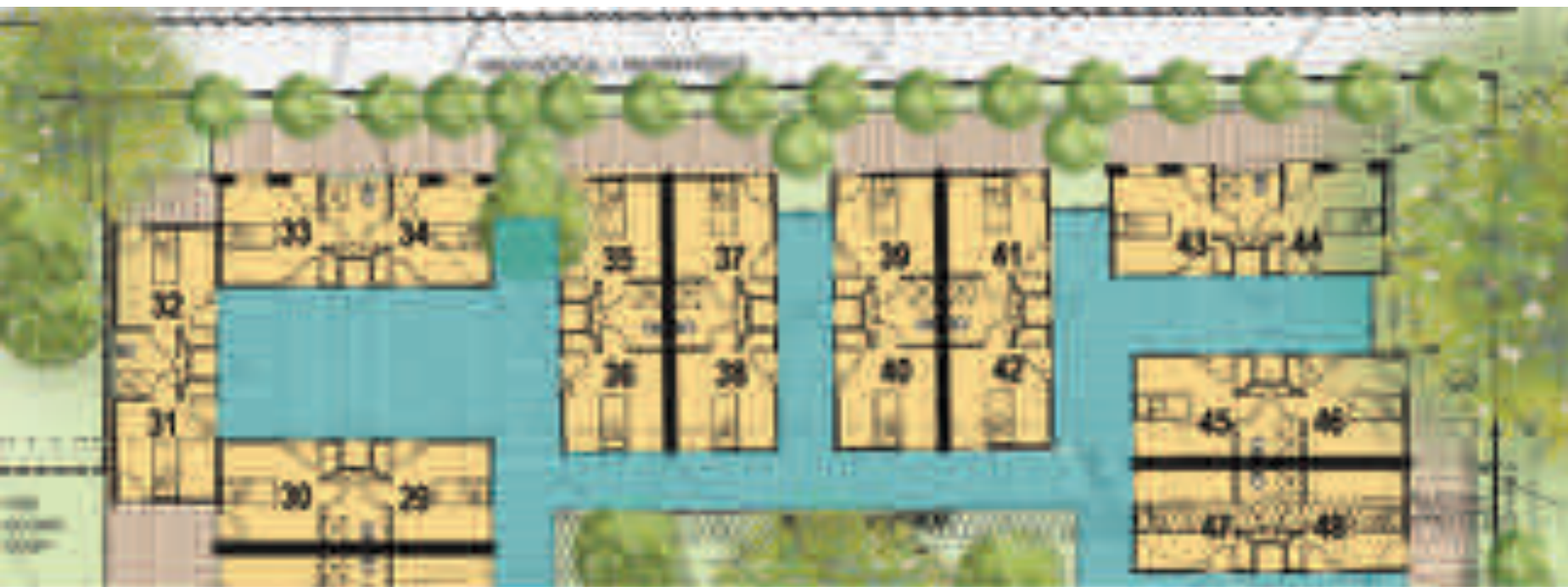

PUBLIC



KEY DESIGN PRINCIPLES

9 Highlight helpful stimuli

- Emphasize bedroom doors and windows
- Clearly identify doors
- Distinguish between bedroom doors
- Clearly show windows
- Emphasize garden
- Identify handrails



KEY DESIGN PRINCIPLES

10. Reduce unwanted stimuli



KEY DESIGN PRINCIPLES

11. Gardens and appropriate Spaces reduces aggression & crowding effect



client
**WINTRINGHAM
WALLARA
Housing Choices**

AWARDS

**International Academy of Design and Health
International Union of Architects
World Architecture News
Illuminating Engineering Society Aus /NZ
World Architecture News
International Academy of Design and Health
International Academy of Design and Health**

**Salutogenic Award 2013 Winner
Architecture for All 2014 Hon mention
Sustainability Commendation 2015
Dr Dressler Daylighting Award Commendation
Health Care 2015 Short list
Sustainability 2013 Short List
Mental Health 2013 Short List**





ROYAL COLLEGE OF PHYSICIANS LONDON | 27-28 JUNE 2016

EUROPEAN HEALTHCARE DESIGN

RESEARCH • POLICY • PRACTICE

Further information

Wintringham www.wintringham.org.au

Wallara Australia

www.wallara.com.au

